



DURAMAX[®]
Inspiring the future generations of welders



WELDING - STRUCTURAL STEEL - ERECTORS - CONSTRUCTION

CATALOG

WWW.DURAMAXWELDING.COM

1-800-692-5930

DURAMAX MISSION

It is our mission to provide world-class service in a fun and friendly manner to the customer who wants to be a priority; while at the same time inspiring a future generation of welders.

Not only does DuraMax supply quality goods, we can be counted on to provide much needed data. Welding parameters are found both on our website and directly on our boxes; an industry first! Technical data sheets and material safety data sheets can be obtained directly from www.duramaxwelding.com, saving our customers both time and effort.

103 Queens Drive, King of Prussia, PA 19406

Phone: 1-800-692-5930

Fax: 610-265-1012

E-mail: sales@duramaxwelding.com

DuraMax is creating a community that relies on each other to benefit the welding industry as a whole. Currently there is a need for trained and motivated welders. Our website addresses this need by connecting our customers with skilled welders. We have developed relationships with many technical schools and trade schools to make this happen.

We also believe in leaving our world a better place than we found it. By supporting community outreach programs like Emily's Entourage for Cystic Fibrosis and Cradles to Crayons for low income and homeless children, we try to achieve this. Please visit www.duramaxwelding.com or contact us directly to see how you can help.



Big Brothers Big Sisters of America



Change Matters...
For Kids With Cancer.

TABLE OF CONTENTS

WELDING ALLOYS

PAGES 9-57

• MIG WIRES

Mild Steel and Low Alloy:

70S-6, 70S-6 EVO, 70S-3, 100S-1, 110S-1, 120S-1, 80S-D2, 80SNi-1 and 80SNi-2 **P. 24-27**

Stainless: 308L, 309L, 316L, 308LSi, 309LSi, 316LSi, 310, 312, 317L, 320LR, 330, 347, 409CB, 410, 410NiMo, 420, 630 and 2209 **P. 29-38**

Aluminum: 1100, 4043, 4047, 5183, 5356, 5554 and 5556 **P. 54-55**

Copper: Deox Copper, Silicon Bronze and Aluminum Bronze A-2 **P. 57**

Nickel: Nickel 55, Nickel 99, 82, 622, 625, C-276, 60, 61 and 72 **P. 44-48**

Chrome Moly: 80S-B2, 80S-B6, 80S-B8, 90S-B3 and 90S-B9 **P. 50-51**

• FLUX CORED WIRES

Mild Steel: 71T-1 (Seismic 71T-1C/1M, 9C/9M H8), 71T-GS, 71T-11, and 71T-8 **P. 9-13**

Stainless: 308LT-1, 309LT-1, 316LT-1, 308HT-1, 309HT-1, 316HT-1, 317LT-1, 318T-1 and 320LRT-1 **P. 40-42**

Chrome Moly: 81T1-B2, 81T1-B6, 81T1-B8, 91T1-B3 and 91T1-B9 **P. 57**

• TIG RODS

Mild Steel and Low Alloy: 70S-2, 70S-6, RG45, RG60, 80S-D2, 70S-B2L and 80S-B3L **P. 24-27**

Stainless: 308L, 309L, 316L, 308LSi, 309LSi, 316LSi, 309LMo 310, 312, 320LR, 330, 347, 409CB, 410, 410NiMo, 420, 430LCB, 630 and 2209 **P. 29-38**

Aluminum: 1100, 4043, 4047, 5183, 5356, 5554 and 5556 **P. 54-55**

Copper: Deox Copper, Silicon Bronze and Aluminum Bronze A-2, Low Fuming Bronze (Bare and Coated), ERCuNiAl and ERCuNiMnAl **P. 57**

Nickel: Nickel 55, Nickel 99, 82, 625 and C-276 **P. 44-48**

Chrome Moly: 80S-B2, 80S-B6, 80S-B8, 90S-B3 and 90S-B9 **P. 50-51**

• ELECTRODES

Mild Steel: 6010, 6011, 6013, 6022, 7014, 7018-H4R and 7024 **P. 14-22**

Stainless: 308L-16, 309L-16, 316L-16, 310-16, 310CB-16, **P. 30-34, 53, 56**
312-16 (*Superblue*), 317L-16, 347-16, 410-16, 410NiMo-16 and 630-16

Aluminum: 4043 Coated (White and Blue) **P. 54**

Nickel: Nickel 55, Nickel 99, 112, 117, 182 and 190 **P. 44-48**



THROUGHOUT OUR CATALOG, YOU WILL SEE A VARIETY OF ALLOYS THAT MEET THE "BUY AMERICA ACT" REQUIREMENTS. A FLAG INDICATES THAT THE PRODUCT IS MELTED AND MANUFACTURED IN THE USA

MIG GUNS, TIG TORCHES, GOUGING TORCHES

PAGES 58-74

- **MIG GUNS AND CONSUMABLES** **P. 58-66**
- **TIG TORCHES AND CONSUMABLES** **P. 67-72**
 - Air Cooled
 - Water Cooled
- **GOUGING TORCHES** **P. 73-74**
 - Gouging Carbons: Pointed, Hollow, Jointed and Flat

HOSES

PAGES 75-76

- **TWIN HOSE**
 - Grade R Twin Hose Assemblies and Reels
 - Grade T Twin Hose Assemblies and Reels
- **ARGON GREEN SINGLE LINE HOSE**

WELDING CABLE

PAGES 77-79

- **AMPERAGE CHART**
- **WELDING CABLE REELS**
- **CUSTOM ASSEMBLIES**
- **ULTRA-FLEX ORANGE WHIP CABLE**
- **ACCESSORIES**
 - Electrode Holders, Ground Clamps, Connectors and Lugs

TORCH OUTFITS AND TIPS

PAGES 80-82

- **TORCH OUTFITS (Welding and Cutting)**
- **CUTTING TIPS**
 - Victor Style, Harris Style, Smith Style and Airco Style

TUNGSTEN

PAGES 83-84

- **Pure (EWP)**
- **1.5% Lanthanated (EWLa-1.5)**
- **2% Lanthanated (EWLa-2)**
- **2% Ceriated (EWCe-2)**
- **2% Thoriated (EWTh-2)**
- **Zirconiated (EWZr-1)**
- **E3**

ABRASIVES

PAGES 85-106

- | | |
|---|-------------------|
| • CUT-OFF WHEELS | P. 86 |
| • STATIONARY SAW WHEELS | P. 87 |
| • HIGH SPEED CUT-OFF WHEELS | P. 88 |
| • GRINDING WHEELS | P. 89 |
| • QUICK CHANGE DISCS | P. 90-91 |
| • RESIN FIBER DISCS/SURFACE CONDITIONING | P. 92-93 |
| • FLAP DISCS | P. 94-95 |
| • STRINGER BEAD BRUSHES | P. 96 |
| • KNOT WHEEL BRUSHES | P. 97 |
| • KNOT CUP BRUSHES | P. 98 |
| • CRIMPED CUP BRUSHES | P. 99 |
| • KNOTTED END BRUSHES | P. 100 |
| • CRIMPED END BRUSHES | P. 101 |
| • BAND SAW BLADES | P. 102-105 |
| • WIRE/SCRATCH BRUSHES | P. 106 |

CHEMICALS

PAGES 107-108

- **ANTI-SPATTER**
- **BRIGHT GALV SPRAY**



TOOLS AND ACCESSORIES

PAGES 109-118

- **FLINT LIGHTERS**
- **TIP CLEANERS**
- **MIG NOZZLE REAMER**
- **CHIPPING HAMMERS**
- **WELD FILLET GAUGES**
- **MIG WELPERS**
- **C-CLAMPS**
- **F-CLAMPS**
- **J-CLAMPS**
- **PRESSURE GAUGES**
- **ARGON FLOWMETER**
- **REGULATORS**
- **SOAPSTONE AND HOLDERS**
(Round and Flat)



WELDING BLANKETS

PAGE 119

- **ALL—FM RATED**
- **18 OUNCE FIBERGLASS UNCOATED**
- **24 OUNCE ORANGE**



STRUCTURAL STEEL, ERECTORS AND CONSTRUCTION INDEX

PAGES 120-123



What is the Buy America Act?

The American Recovery and Reinvestment Act (ARRA) was passed in 2009 as an economic stimulus act to create and save jobs in the U.S while rebuilding the infrastructure. It was an unprecedented effort to jumpstart our economy, create or save millions of jobs, and put a down payment on addressing long-neglected challenges so our country can thrive in the 21st century. A provision of this Act is "**Buy America**" which requires all steel components of welding consumables to be *made and melted* in the United States. Still today, these requirements are becoming more prevalent in the structural steel, bridge fabrication and erection market segments.

Products offered by DuraMax that meet the Buy America requirements:

- **71T-1 FLUX-CORED WIRE**
- **71T-8 H8**
- **71T-GS SELF-SHIELDED WIRE**
- **MILD STEEL ELECTRODES**
- **STAINLESS MIG WIRE, TIG RODS AND ELECTRODES**
- **NICKEL MIG WIRE, TIG RODS AND ELECTRODES**
- **FLAP DISCS**
- **WELDING CABLE**

**Products made in the USA will have a flag next to them throughout our catalog.*



At DuraMax, we are committed to supporting this act and will continue to add additional products to this category.

MILD STEEL FLUX-CORED WIRES



**“We recommend DuraMax
Seismic Plus 71T-1 wire
to all our “Buy America”
compliant clients.”**

**Pete Urbani - President
The Urbani Group
Consulting for AISC Standards**



DuraMax 71T-1C/1M, 9C/9M H8 Seismic Plus Wire

Features:

- Superb welder appeal because of its smooth stable arc and virtually spatter free weld deposits.
- Very little fumes.
- Out of position welding made simple because of fast freezing yet easily removable slag.

****More time welding, less time cleaning up!***

Classification: E71T-1C/1M, ER71T-9C/9M H8

Diameters: .035", .045", .052" and 1/16"

Formats: 33 Lb and 44 Lb spools, 60 Lb Coils and 550 Lb Drums

Part #	Diameter	Format
DM71T-1C/1M H8SP 035X33S	.035	33 Lb Spools
DM71T-1C/1M H8SP 035X550D	.035	550 Lb Drums
DM71T-1C/1M H8SP 045X33S	.045	33 Lb Spools
DM71T-1C/1M H8SP 045X44S	.045	44 Lb Spools
DM71T-1C/1M H8SP 045X60C	.045	60 Lb Coils
DM71T-1C/1M H8SP 045X550D	.045	550 Lb Drums
DM71T-1C/1M H8SP 052X33S	.052	33 Lb Spools
DM71T-1C/1M H8SP 052X44S	.052	44 Lb Spools
DM71T-1C/1M H8SP 052X60C	.052	60 Lb Coils
DM71T-1C/1M H8SP 052X550D	.052	550 Lb Drums
DM71T-1C/1M H8SP 1/16X33S	1/16	33 Lb Spools
DM71T-1C/1M H8SP 1/16X44S	1/16	44 Lb Spools
DM71T-1C/1M H8SP 1/16X60C	1/16	60 Lb Coils
DM71T-1C/1M H8SP 1/16X550D	1/16	550 Lb Drums

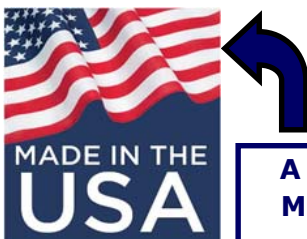

A FLAG INDICATES THAT THE PRODUCT IS MELTED AND MANUFACTURED IN THE USA



DuraMax 71T-GS Self-Shielded Wire

Features: A carbon steel, self shielded, flux-cored wire that produces smooth arc action, low spatter, full slag coverage, and easy slag removal. Not having to use gas makes this product extremely popular due to it’s versatility and portability.

Classification: E71T-GS

Diameters: .030”, .035”, .045” and .052”

Formats: 2 Lb spools, 10 Lb spools and 33 Lb spools

Part #	Diameter	Format
DM71TGS 030X2S	.030	2 Lb Spools
DM71TGS 030X10S	.030	10 Lb Spools
DM71TGS 035X2S	.035	2 Lb Spools
DM71TGS 035X10S	.035	10 Lb Spools
DM71TGS 035X33S	.035	33 Lb Spools
DM71TGS 045X2S	.045	2 Lb Spools
DM71TGS 045X10S	.045	10 Lb Spools
DM71TGS 045X33S	.045	33 Lb Spools



Melted and Manufactured in the USA



DuraMax 71T-11

Features: Self-shielding flux-cored wire designed for single or multi-pass welding having a smooth spray-type transfer commonly used on mild steels less than 3/4" thick. Easy general all position wire to use in the field where shielding gas is not practical. Limit to three passes will ensure properties on the mechanicals and weld deposit chemistry.

Classification: E71T-11

Diameters: .035", .045", .052" and 1/16

Formats: 33 Lb and 44 Lb spools and 550 Lb drums

Part #	Diameter	Format
DM71T-11 035X33S	.035	33 Lb Spools
DM71T-11 035X44S	.035	44 Lb Spools
DM71T-11 035X550D	.035	550 Lb Drums
DM71T-11 045X33S	.045	33 Lb Spools
DM71T-11 045X44S	.045	44 Lb Spools
DM71T-11 045X550D	.045	550 Lb Drums
DM71T-11 052X33S	.052	33 Lb Spools
DM71T-11 052X44S	.052	44 Lb Spools
DM71T-11 052X550D	.052	550 Lb Drums
DM71T-11 1/16X33S	1/16	33 Lb Spools
DM71T-11 1/16X44S	1/16	44 Lb Spools
DM71T-11 1/16X550D	1/16	550 Lb Drums



Melted and Manufactured in the USA



DuraMax 71T-8 H8

Features:

- Excellent welder appeal
- Increases productivity
- Fast-freezing slag
- Suitable for all-position welding
- Reduces clean-up time, increases productivity
- High impact strengths at low temperatures
- Resists cracking in severe applications
- No shielding gas required
- Suitable for welding outdoors

Classification: E71T-8 H8

Diameters: .045", 1/16", .068" and 5/64

Formats: 25 Lb and 44 Lb spools and 550 Lb drums

Part #	Diameter	Format
DM71T-8 H8 045X25S	.045	25 Lb Spools
DM71T-8 H8 045X44S	.045	44 Lb Spools
DM71T-8 H8 045X550D	.045	550 Lb Drums
DM71T-8 H8 1/16X25S	1/16	25 Lb Spools
DM71T-8 H8 1/16X44S	1/16	44 Lb Spools
DM71T-8 H8 1/16X550D	1/16	550 Lb Drums
DM71T-8 H8 068X25S	.068	25 Lb Spools
DM71T-8 H8 068X44S	.068	44 Lb Spools
DM71T-8 H8 068X550D	.068	550 Lb Drums
DM71T-8 H8 5/64X25S	5/64	25 Lb Spools
DM71T-8 H8 5/64X44S	5/64	44 Lb Spools
DM71T-8 H8 5/64X550D	5/64	550 Lb Drums



Melted and Manufactured in the USA

MILD STEEL ELECTRODES



"This company is GREAT! They have very good educational pricing and a great product! I have tried their 7018's, 6010's, and 6013's and they are at least equal to the best on the market if not better than. I have done destructive testing with the 7018's and they were excellent! The stabilizers in the flux are excellent and run very smooth! I highly recommend this product and this company! They are great to deal with and take an interest in students learning to weld!"

- CHRIS KING, Welding Instructor, Campbellsville University of Kentucky



DuraMax 7018-H4R Low Hydrogen Electrodes

Features:

- Welder friendly with minimum spatter.
- Moisture resistant and hydrogen controlled.
- Reduction of arc starting porosity.
- Clear puddle and a smooth arc.
- Weld metal is clean and has lowest level of impurities.
- No need for drying.
- The electrodes are vacuum packed and can be used straight on the job.
- Diffusible Hydrogen : ≤ 4.0 ml/100g Gr.

Typical Application & Usage:

All maintenance applications including welding of all types of carbon-manganese steels, heavy structures subjected to static or dynamic loading. These rods can be used as a buffer layer before hard facing.

Our unique packaging features the welding parameters printed directly on the tube to assist welders with running the optimum settings.



Classification: E7018-H4R

Diameters: 3/32, 1/8, 5/32, 3/16 and 1/4 in 10 LB Tubes

Part #	Diameter	Format
DM7018-H4R 3/32	3/32	10 Lb Tubes
DM7018-H4R 1/8	1/8	10 Lb Tubes
DM7018-H4R 5/32	5/32	10 Lb Tubes
DM7018-H4R 3/16	3/16	10 Lb Tubes
DM7018-H4R 1/4	1/4	10 Lb Tubes



Please note that DuraMax also offers a MADE IN THE USA line of Mild Steel Electrodes.



DuraMax 6010 Mild Steel Electrodes

Features: E6010 is an all position, cellulosic electrode that has a quick starting, steady, and deep penetrating arc. It produces x-ray quality welds in flat, horizontal, overhead, vertical-up, and vertical-down positions.

Typical Application & Usage:

Used for general-purpose fabrication, repair, maintenance welding, out-of-position x-ray welds, construction and ship building, pipe welding as well as vertical and overhead plate welding.

Classification: E6010

Diameters: 3/32, 1/8, 5/32 and 3/16 in 10 LB Tubes

Part #	Diameter	Format
DM6010 3/32	3/32	10 Lb Tubes
DM6010 1/8	1/8	10 Lb Tubes
DM6010 5/32	5/32	10 Lb Tubes
DM6010 3/16	3/16	10 Lb Tubes



**Please note that DuraMax also offers a
MADE IN THE USA line of Mild Steel Electrodes.**



DuraMax 6011 Mild Steel Electrodes

Features: E6011 is a versatile, deep penetrating, steel electrode with smooth and stable arc characteristics. The coating produces a forceful, spray-type arc, resulting in deep penetrating welds.

Typical Application & Usage:

Used for welding mild, galvanized and some low-alloy steels. Suited for structural, ship building and repair, rail cars, piping, pressure vessel fittings, boilers and general fabrication.

Classification: E6011

Diameters: 3/32, 1/8, 5/32 and 3/16 in 10 LB Tubes

Part #	Diameter	Format
DM6011 3/32	3/32	10 Lb Tubes
DM6011 1/8	1/8	10 Lb Tubes
DM6011 5/32	5/32	10 Lb Tubes
DM6011 3/16	3/16	10 Lb Tubes

**Please note that DuraMax also offers a
MADE IN THE USA line of Mild Steel Electrodes.**





DuraMax 6013 Mild Steel Electrodes

Features: E6013 is a versatile, deep penetrating steel electrode with smooth, stable arc characteristics. It's used for the welding of mild steels, galvanized and also some low alloy steels. The coating produces a forceful, spray-type arc, resulting in deep penetrating welds. The slag is thin and easily removable.

Typical Application & Usage:

Vehicles, ship building and repair, sheet metal, build-up of over machined and worn mild steel surfaces, general light fabrication.

Classification: E6013

Diameters: 3/32, 1/8, 5/32 and 3/16 in 10 LB Tubes

Part #	Diameter	Format
DM6013 3/32	3/32	10 Lb Tubes
DM6013 1/8	1/8	10 Lb Tubes
DM6013 5/32	5/32	10 Lb Tubes
DM6013 3/16	3/16	10 Lb Tubes



**Please note that DuraMax also offers a
MADE IN THE USA line of Mild Steel Electrodes.**



DuraMax 6022 Mild Steel Electrodes

Features: E6022 has a smooth, easy to control arc, excellent strike and re-strike, penetrating arc, low spatter and a light slag. It produces strong, reliable welds with less clean up and good bead appearance.

Typical Application & Usage:

Commonly referred to as the “decking rod” because it’s used for welding roof decking to support beams and other similar applications where burn-through spot welds with full penetration are required. It is also designed to weld through galvanized or painted roof decking and can also be used on plated and dirty decking. This rod is an excellent choice for burn through spot welds for roof decking and sheet metal and for rapid downhill welding when joining light gauge materials.

Classification: E6022

Diameters: 3/32, 1/8, 5/32 and 3/16 in 10 LB Tubes

Part #	Diameter	Format
DM6022 3/32	3/32	10 Lb Tubes
DM6022 1/8	1/8	10 Lb Tubes
DM6022 5/32	5/32	10 Lb Tubes
DM6022 3/16	3/16	10 Lb Tubes



**Please note that DuraMax also offers a
MADE IN THE USA line of Mild Steel Electrodes.**



DuraMax 7014 Mild Steel Electrodes

Features: E7014 is an all position electrode for mild and low alloy steels with an iron powder coating. The iron coating yields a high deposition rate. The welds reflect smooth beads with fine ripples. High speeds and high heats can be used without undercut. It is particularly advantageous when poor fit-up exists. The slag is easily removed, often self-lifting.

Typical Application & Usage:

Heavy sheet metal, frames, construction equipment, farm machinery, shelving, general maintenance and fabrication.

Classification: E7014

Diameters: 3/32, 1/8, 5/32 and 3/16 in 10 LB Tubes

Part #	Diameter	Format
DM7014 3/32	3/32	10 Lb Tubes
DM7014 1/8	1/8	10 Lb Tubes
DM7014 5/32	5/32	10 Lb Tubes
DM7014 3/16	3/16	10 Lb Tubes



**Please note that DuraMax also offers a
MADE IN THE USA line of Mild Steel Electrodes.**



DuraMax 7024 Mild Steel Electrodes

Features: E7024 is a heavy iron powder coated electrode designed for high speed, single pass horizontal and flat fillet welding of mild steel. This electrode provides greater deposition efficiency and better physical properties than E7014 electrodes. E7024 offers a quiet stable arc and produces weld deposits with low spatter, free of undercuts and a "self-removing" slag. Bead appearance is superb. Excellent operator appeal. This electrode may be used with AC or DC (straight or reverse polarity).

Typical Application & Usage:

Ship and barge structures, rail cars, bridges, structural steels, machine bases, truck fabrication, storage tanks and earth-moving equipment.

Classification: E7024

Diameters: 3/32, 1/8, 5/32 and 3/16 in 10 LB Tubes

Part #	Diameter	Format
DM7024 3/32	3/32	10 Lb Tubes
DM7024 1/8	1/8	10 Lb Tubes
DM7024 5/32	5/32	10 Lb Tubes
DM7024 3/16	3/16	10 Lb Tubes



Please note that DuraMax also offers a MADE IN THE USA line of Mild Steel Electrodes.



MILD STEEL ELECTRODE CLASSIFICATION

The **American Welding Society's** classification number series for welding electrodes has been adopted by the welding industry.

The electrode identification system for steel arc welding is set up as follows:

- 1. E** – indicates electrode for arc welding.
- 2. The first two (or three) digits** – indicate tensile strength (the resistance of the material to forces trying to pull it apart) in thousands of pounds per square inch of the deposited metal.
- 3. The third (or fourth) digit** – indicates the position of the weld. 0 indicates the classification is not used; 1 is for all positions; 2 is for flat and horizontal positions only; 3 is for flat position only.
- 4. The fourth (or fifth) digit** – indicates the type of electrode coating and the type of power supply used; alternating or direct current, straight or reverse polarity.

*The types of coating, welding current, and polarity position designated by the fourth (or fifth) identifying digit of the electrode classification are listed in the table below.

Example: 7018-H4R The first two digits **70** = tensile strength minimum in ksi of the weld metal. 70,000 psi in this case. **E7018** The last two digits give the type of coating/covering, type of current and welding position usage. The third digit of **1** = all position. The fourth digit of **8** = iron powder low hydrogen. **H4** designates that it will meet 4ml average diffusible hydrogen content with 100 grams of weld deposit. **R** designates that it will meet low moisture absorbing limit in 80 F/80 % humidity for not < 9 hours.

Coating, Current and Polarity Types Designated By the Fourth Digit in the Electrode Classification Number

Digit	Coating	Weld Current
0	High Cellulose Sodium	DC+
1	High Cellulose Potassium	AC, DC+ or DC-
2	High Titania Sodium	AC, DC-
3	High Titania Potassium	AC, DC+
4	Iron Powder, Titania	AC, DC+ or DC-
5	Low Hydrogen Sodium	DC+
6	Low Hydrogen Potassium	AC, DC+
7	High Iron Oxide, Iron Powder	AC, DC+ or DC-
8	Low Hydrogen Potassium, Iron Powder	AC, DC+ or DC-

When the fourth (or last) digit is 0, the type of coating and current to be used are determined by the third digit.

MILD STEEL WELDING ALLOYS

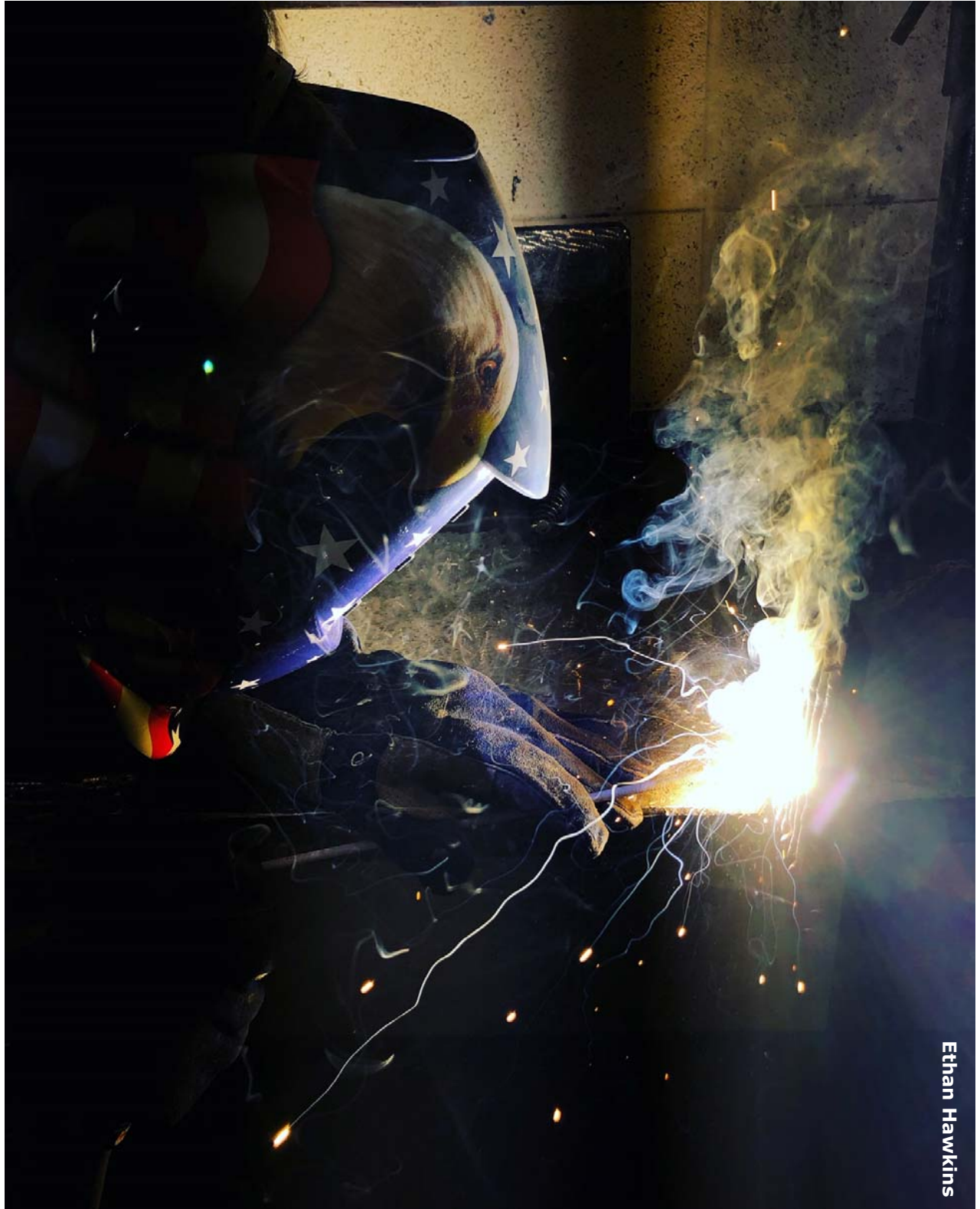

Ethan Hawkins



DuraMax ER70S-6 MILD STEEL MIG WIRE STANDARD COATED WIRE

*Common copper coated carbon steel that contains high levels of manganese and silicon for stronger deoxidizing power and has excellent welding results on mild steels where poor fit-up, rust and oils may be present.



Classification: ER70S-6

Diameters: .023", .030", .035", .045", .052" and 1/16

Formats: 2 Lb spools, 11 Lb spools, 33 Lb spools, 44 Lb spools and 550 Lb Drums

Part #	Diameter	Format
DM70S-6 023X2S	.023	2 Lb Spools
DM70S-6 023X11S	.023	11 Lb Spools
DM70S-6 030X2S	.030	2 Lb Spools
DM70S-6 030X11S	.030	11 Lb Spools
DM70S-6 030X33S	.030	33 Lb Spools
DM70S-6 035X2SS	.035	2 Lb Spools
DM70S-6 035X11S	.035	11 Lb Spools
DM70S-6 035X33S	.035	33 Lb Spools
DM70S-6 035X44S	.035	44 Lb Spools
DM70S-6 035X550D	.035	550 Lb Drums
DM70S-6 045X33S	.045	33 Lb Spools
DM70S-6 045X44S	.045	44 Lb Spools
DM70S-6 045X550D	.045	550 Lb Drums
DM70S-6 052X33S	.052	33 Lb Spools
DM70S-6 052X44S	.052	44 Lb Spools
DM70S-6 052X550D	.052	550 Lb Drums
DM70S-6 1/16X33S	1/16	33 Lb Spools
DM70S-6 1/16X44S	1/16	44 Lb Spools
DM70S-6 1/16X550D	1/16	550 Lb Drums



DuraMax ER70S-6 EVO MILD STEEL MIG WIRE

Features:

- Un-coppered bare wire
- Rapid arc start
- Very little fumes
- Constant stick-out prevents wire from sticking to the nozzle
- Stable welding arc
- Significant reduction in spatter in comparison to other wires
- Suitable for single or multi-pass welding
- **EXCELLENT** aesthetic bead quality

***MADE IN ITALY**



Classification: ER70S-6 DFARS approved

Diameters: .030", .035", .045", .052" and 1/16

Formats: 33 Lb spools, 40 Lb spools and 550 Lb Drums

Part #	Diameter	Format
DM70S-6 HS EVO2 030X33S	.030	33 Lb Spools
DM70S-6 HS EVO2 035X33S	.030	33 Lb Spools
DM70S-6 HS EVO2 035X40S	.035	40 Lb Spools
DM70S-6 HS EVO2 035X550D	.035	550 Lb Drums
DM70S-6 HS EVO2 045X33S	.045	33 Lb Spools
DM70S-6 HS EVO2 045X40S	.045	40 Lb Spools
DM70S-6 HS EVO2 045X550D	.045	550 Lb Drums
DM70S-6 HS EVO2 052X33S	.052	33 Lb Spools
DM70S-6 HS EVO2 052X40S	.052	40 Lb Spools
DM70S-6 HS EVO2 052X550D	.052	550 Lb Drums
DM70S-6 HS EVO2 1/16X40S	1/16	40 Lb Spools
DM70S-6 HS EVO2 1/16X550D	1/16	550 Lb Drums



DuraMax ER70S-6 TIG RODS

Features: This is a common copper coated carbon steel that contains high levels of manganese and silicon for stronger deoxidizing power and has excellent welding results on mild steels where poor fit-up, rust and oils may be present.

Typical Applications: Repairs on a variety of mild and low alloy steel, small diameter pipe and tubing, sheet metal applications and root pass pipe welding.

Classification: ER70S-6

Diameters: .030", .035", .045" 1/16, 3/32, 1/8, 5/32 and 3/16.

Formats: 10 Lb tubes

Part #	Diameter	Format
DM70S-6 030X36UM	.030	10 Lb tubes
DM70S-6 035X36UM	.035	10 Lb tubes
DM70S-6 045X36E2	.045	10 Lb tubes
DM70S-6 1/16X36E2	1/16	10 Lb tubes
DM70S-6 3/32X36E2	3/32	10 Lb tubes
DM70S-6 1/8X36E2	1/8	10 Lb tubes
DM70S-6 5/32X36E2	5/32	10 Lb tubes
DM70S-6 3/16X36E2	3/16	10 Lb tubes



DuraMax 70S-3 MIG and TIG

Features: A mild steel solid wire, with silicon and manganese levels suitable for general purpose welding over clean to light levels of rust and mill scale. This wire has the flexibility to provide trouble-free performance in heavy-duty, high-speed spray or pulse applications to lighter duty, lower speed short-arc applications.



Classification: ER70S-3

Diameters: .023", .030", .035", .045", .052", 1/16, 3/32, 1/8, 5/32 and 3/16

Formats: 33 Lb and 44 Lb spools, 550 and 900 Lb drums and 10 Lb tubes of TIG rods

Part #	Diameter	Format
DM70S-3 023X33S	.023	33 Lb Spools
DM70S-3 023X44S	.023	44 Lb Spools
DM70S-3 030X33S	.030	33 Lb Spools
DM70S-3 030X44S	.030	44 Lb Spools
DM70S-3 035X33S	.035	33 Lb Spools
DM70S-3 035X550D	.035	550 Lb Drums
DM70S-3 035X900D	.035	900 Lb Drums
DM70S-3 045X33S	.045	33 Lb Spools
DM70S-3 045X44S	.045	44 Lb Spools
DM70S-3 045X550D	.045	550 Lb Drums
DM70S-3 045X900D	.045	900 Lb Drums
DM70S-3 052X33S	.052	33 Lb Spools
DM70S-3 052X44S	.052	44 Lb Spools
DM70S-3 052X550D	.052	550 Lb Drums
DM70S-3 1/16X36E2	1/16	10 Lb Tubes
DM70S-3 3/32X36E2	3/32	10 Lb Tubes
DM70S-3 1/8X36E2	1/8	10 Lb Tubes
DM70S-3 5/32X36E2	5/32	10 Lb Tubes
DM70S-3 3/16X36E2	3/16	10 Lb Tubes

STAINLESS ALLOYS



“We need high quality stainless welding wire for the pharmaceutical tanks we manufacture. DuraMax stocks everything we need, and get it to us next day. We love the service!”

**– John
Keystone Fabricators—Plant Manager**



DuraMax 308/308L

Features: 308/308L is an austenitic stainless steel used to weld base metals of similar composition types. This alloy’s low carbon helps to prevent cracking. It has excellent corrosion resistance and welds all low-grade stainless alloys up to a 308L. This is a suitable wire for applications at cryogenic temperatures.

Typical Application & Usage: Pulp and paper mills, tanks, stainless pipe and tubing, bakery and kitchen equipment, housings and impellers, hospital equipment and more.

Classification: ER308/ER308L

Diameters: .023”, .030”, .035”, .045”, 1/16”, 3/32”, 1/8”, 5/32” and 3/16”

Formats: 2 Lb, 10 Lb, 33 Lb spools, 60 Lb Coils and 10 Lb tubes of TIG

Part #	Diameter	Format
DM308/308L 023X2S	.023	2 Lb Spools
DM308/308L 023X10S	.023	10 Lb Spools
DM308/308L 023X33S	.023	33 Lb Spools
DM308/308L 030X2S	.030	2 Lb Spools
DM308/308L 030X10S	.030	10 Lb Spools
DM308/308L 030X33S	.030	33 Lb Spools
DM308/308L 030X36UM (Unmarked)	.030	10 Lb Tubes
DM308/308L 035X2S	.035	2 Lb Spools
DM308/308L 035X10S	.035	10 Lb Spools
DM308/308L 035X33S	.035	33 Lb Spools
DM308/308L 035X36UM (Unmarked)	.035	10 Lb Tubes
DM308/308L 045X2S	.045	2 Lb Spools
DM308/308L 045X10S	.045	10 Lb Spools
DM308/308L 045X33S	.045	33 Lb Spools
DM308/308L 045X36E2	.045	10 Lb Tubes
DM308/308L 1/16X33S	1/16	33 Lb Spools
DM308/308L 1/16X36E2	1/16	10 Lb Tubes
DM308/308L 3/32X60C	3/32	60 Lb Coils
DM308/308L 3/32X36E2	3/32	10 Lb Tubes
DM308/308L 1/8X60C	1/8	60 Lb Coils
DM308/308L 1/8X36E2	1/8	10 Lb Tubes
DM308/308L 5/32X60C	5/32	60 Lb Coils
DM308/308L 5/32X36E2	5/32	10 Lb Tubes
DM308/308L 3/16X36E2	3/16	10 Lb Tubes



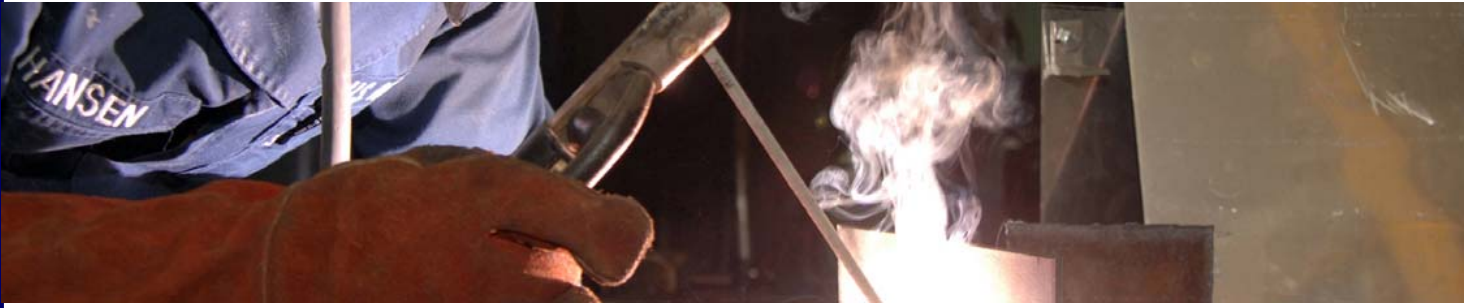

DuraMax 308L-16 Electrodes

Features: E308L-16 was developed for welding 304L. This electrode deposits a maximum of 0.04% carbon in the weld metal. Type 308L-16 is used extensively for welding of chemical plant equipment and may be used successfully for welding types 321 and 347 steel grades. E308L-16 minimizes the formation of chromium carbides in the weld metal.

Typical Application & Usage: Tank and vessel Fabrication, ship/barge building, industrial and general fabrication and petrochemical.

Classification: E308L-16

Diameters: 1/16, 3/32, 1/8, 5/32 and 3/16 in 10 LB Tubes

Part #	Diameter	Format
DM308L-16 1/16	1/16	10 Lb Tubes
DM308L-16 3/32	3/32	10 Lb Tubes
DM308L-16 1/8	1/8	10 Lb Tubes
DM308L-16 5/32	5/32	10 Lb Tubes
DM308L-16 3/16	3/16	10 Lb Tubes





DuraMax 309/309L

Features: 309/309L is used to weld base metals of similar composition in wrought or cast iron. Also to weld type 304 and similar base metals where severe conditions may exist. Sometimes used to weld dissimilar steels. The lower carbon content of 0.03% max increases resistance to intergranular corrosion avoiding carbide precipitation. This wire provides high-strength, crack-free welds, welds all weldable steels and combinations of steels, has a high heat resistance and tough, corrosion-resistant welds.

Typical Application & Usage: Difficult and dissimilar steels, lift truck forks, gear teeth, tool steels, leaf springs and unknown/weldable steels.

Classification: ER309/ER309L

Diameters: .023", .030", .035", .045", 1/16", 3/32", 1/8", 5/32" and 3/16"

Formats: 2 Lb, 10 Lb, 33Lb spools, 60 Lb Coils and 10 Lb tubes of TIG

Part #	Diameter	Format
DM309/309L 023X2S	.023	2 Lb Spools
DM309/309L 023X10S	.023	10 Lb Spools
DM309/309L 023X33S	.023	33 Lb Spools
DM309/309L 030X2S	.030	2 Lb Spools
DM309/309L 030X10S	.030	10 Lb Spools
DM309/309L 030X33S	.030	33 Lb Spools
DM309/309L 030X36UM (Unmarked)	.030	10 Lb Tubes
DM309/309L 035X2S	.035	2 Lb Spools
DM309/309L 035X10S	.035	10 Lb Spools
DM309/309L 035X33S	.035	33 Lb Spools
DM309/309L 035X36UM (Unmarked)	.035	10 Lb Tubes
DM309/309L 045X2S	.045	2 Lb Spools
DM309/309L 045X10S	.045	10 Lb Spools
DM309/309L 045X33S	.045	33 Lb Spools
DM309/309L 045X36E2	.045	10 Lb Tubes
DM309/309L 1/16X33S	1/16	33 Lb Spools
DM309/309L 1/16X36E2	1/16	10 Lb Tubes
DM309/309L 3/32X60C	3/32	60 Lb Coils
DM309/309L 3/32X36E2	3/32	10 Lb Tubes
DM309/309L 1/8X60C	1/8	60 Lb Coils
DM309/309L 1/8X36E2	1/8	10 Lb Tubes
DM309/309L 5/32X60C	5/32	60 Lb Coils
DM309/309L 5/32X36E2	5/32	10 Lb Tubes
DM309/309L 3/16X36E2	3/16	10 Lb Tubes





DuraMax 309L-16 Electrodes

Features: 309L-16 stainless steel electrodes are 24% chromium and 13% Nickel filler which is the same as 309, except for the reduced carbon amount. Low carbon alloys reduce the possibility of intergranular carbide precipitation while providing a good crack resistance. These all-position rods have easy strike and re-strike with spatter-free arc, self-releasing slag leaving a smooth bead appearance to slightly convex. 309L electrodes may also be a good choice when welding stainless to carbon steels.

Typical Application & Usage: Industrial and general fabrication, food equipment, petrochemical, surfacing and shipbuilding/offshore structures.

Classification: E309L-16

Diameters: 1/16, 3/32, 1/8, 5/32 and 3/16 in 10 LB Tubes

Part #	Diameter	Format
DM309L-16 1/16	1/16	10 Lb Tubes
DM309L-16 3/32	3/32	10 Lb Tubes
DM309L-16 1/8	1/8	10 Lb Tubes
DM309L-16 5/32	5/32	10 Lb Tubes
DM309L-16 3/16	3/16	10 Lb Tubes





DuraMax 316/316L

Features: 316/316L filler metal is primarily used for welding low carbon molybdenum-bearing austenitic alloys. It welds most high grades of stainless up to a 316L, has excellent corrosion resistance and good high-temperature resistance.

Typical Application & Usage: Tanks and vats, pumps and impellers, hospital equipment, food processing equipment, pharmaceutical equipment, shafts and valves

Classification: ER316/ER316L

Diameters: .023", .030", .035", .045", 1/16", 3/32", 1/8", 5/32" and 3/16"

Formats: 2 Lb, 10 Lb, 33 Lb spools, 60 Lb Coils and 10 Lb tubes of TIG

Part #	Diameter	Format
DM316/316L 023X2S	.023	2 Lb Spools
DM316/316L 023X10S	.023	10 Lb Spools
DM316/316L 023X33S	.023	33 Lb Spools
DM316/316L 030X2S	.030	2 Lb Spools
DM316/316L 030X10S	.030	10 Lb Spools
DM316/316L 030X33S	.030	33 Lb Spools
DM316/316L 030X36UM (Unmarked)	.030	10 Lb Tubes
DM316/316L 035X2S	.035	2 Lb Spools
DM316/316L 035X10S	.035	10 Lb Spools
DM316/316L 035X33S	.035	33 Lb Spools
DM316/316L 035X36UM (Unmarked)	.035	10 Lb Tubes
DM316/316L 045X2S	.045	2 Lb Spools
DM316/316L 045X10S	.045	10 Lb Spools
DM316/316L 045X33S	.045	33 Lb Spools
DM316/316L 045X36E2	.045	10 Lb Tubes
DM316/316L 1/16X33S	1/16	33 Lb Spools
DM316/316L 1/16X36E2	1/16	10 Lb Tubes
DM316/316L 3/32X60C	3/32	60 Lb Coils
DM316/316L 3/32X36E2	3/32	10 Lb Tubes
DM316/316L 1/8X60C	1/8	60 Lb Coils
DM316/316L 1/8X36E2	1/8	10 Lb Tubes
DM316/316L 5/32X60C	5/32	60 Lb Coils
DM316/316L 5/32X36E2	5/32	10 Lb Tubes
DM316/316L 3/16X36E2	3/16	10 Lb Tubes





DuraMax 316L-16 Electrodes

Features: 316L electrodes produce weld deposits similar to that of 316, but with a maximum 0.04% carbon. This extra low carbon content gives the weld deposit excellent resistance against intergranular corrosion caused by carbide precipitation. 316L-16 electrodes are used for welding 18% Cr – 12% Ni – 2.5% Mo stainless steels where the corrosion resistant qualities of AISI 316L are required. This electrode has a high deposition rate and produces a weld deposit with fine bead appearance and exceptional crack-resistance. It has a smooth arc and easy slag release.

Typical Applications & Usage: Pump housings and impellers, tanks and vats, food processing equipment, pharmaceutical equipment, valves and shafts, hospital equipment and pipes and fittings.

Classification: E316L-16

Diameters: 1/16, 3/32, 1/8, 5/32 and 3/16 in 10 LB Tubes

Part #	Diameter	Format
DM316L-16 1/16	1/16	10 Lb Tubes
DM316L-16 3/32	3/32	10 Lb Tubes
DM316L-16 1/8	1/8	10 Lb Tubes
DM316L-16 5/32	5/32	10 Lb Tubes
DM316L-16 3/16	3/16	10 Lb Tubes





DuraMax 308LSi

Features: 308LSi is used to weld base metals of similar composition such as 201, 202, 301, 302, 304, 305 and 308 (also the L series). The additional silicon content increases wetting action and yields a smooth bead.

Typical Application & Usage: The alloy is widely used in the chemical and food processing industries as well as for pipes, tubes and boilers.

Classification: ER308LSi

Diameters: .023", .030", .035", .045", 1/16", 3/32", 1/8", 5/32" and 3/16"

Formats: 2 Lb, 10 Lb, 33 Lb spools, 60 Lb Coils and 10 Lb tubes of TIG

Part #	Diameter	Format
DM308LSi 023X2S	.023	2 Lb Spools
DM308LSi 023X10S	.023	10 Lb Spools
DM308LSi 023X33S	.023	33 Lb Spools
DM308LSi 030X2S	.030	2 Lb Spools
DM308LSi 030X10S	.030	10 Lb Spools
DM308LSi 030X33S	.030	33 Lb Spools
DM308LSi 030X36UM (Unmarked)	.030	10 Lb Tubes
DM308LSi 035X2S	.035	2 Lb Spools
DM308LSi 035X10S	.035	10 Lb Spools
DM308LSi 035X33S	.035	33 Lb Spools
DM308LSi 035X36UM (Unmarked)	.035	10 Lb Tubes
DM308LSi 045X2S	.045	2 Lb Spools
DM308LSi 045X10S	.045	10 Lb Spools
DM308LSi 045X33S	.045	33 Lb Spools
DM308LSi 045X36E2	.045	10 Lb Tubes
DM308LSi 1/16X33S	1/16	33 Lb Spools
DM308LSi 1/16X36E2	1/16	10 Lb Tubes
DM308LSi 3/32X60C	3/32	60 Lb Coils
DM308LSi 3/32X36E2	3/32	10 Lb Tubes
DM308LSi 1/8X60C	1/8	60 Lb Coils
DM308LSi 1/8X36E2	1/8	10 Lb Tubes
DM308LSi 5/32X60C	5/32	60 Lb Coils
DM308LSi 5/32X36E2	5/32	10 Lb Tubes



WELDING ALLOYS



DuraMax 309LSi

Features: 309LSi is used to weld base metals of similar composition in wrought or cast form. This is also used to weld type 304 and similar base metals where severe conditions may exist. At times, it may be used to weld dissimilar steels, overlaying carbon steel and low alloy steels, as well as joining stainless steel to carbon or low alloy steel. The higher silicon contents will improve the wetting and washing behavior of the weld metal.

Typical Application & Usage: Food and beverage, petrochemical plants, pulp and paper, other general fabrication on stainless steels.

Classification: ER309LSi

Diameters: .023", .030", .035", .045", 1/16", 3/32", 1/8", 5/32" and 3/16"

Formats: 2 Lb, 10 Lb, 33 Lb spools, 60 Lb Coils and 10 Lb tubes of TIG

Part #	Diameter	Format
DM309LSi 023X2S	.023	2 Lb Spools
DM309LSi 023X10S	.023	10 Lb Spools
DM309LSi 023X33S	.023	33 Lb Spools
DM309LSi 030X2S	.030	2 Lb Spools
DM309LSi 030X10S	.030	10 Lb Spools
DM309LSi 030X33S	.030	33 Lb Spools
DM309LSi 030X36UM (Unmarked)	.030	10 Lb Tubes
DM309LSi 035X2S	.035	2 Lb Spools
DM309LSi 035X10S	.035	10 Lb Spools
DM309LSi 035X33S	.035	33 Lb Spools
DM309LSi 035X36UM (Unmarked)	.035	10 Lb Tubes
DM309LSi 045X2S	.045	2 Lb Spools
DM309LSi 045X10S	.045	10 Lb Spools
DM309LSi 045X33S	.045	33 Lb Spools
DM309LSi 045X36E2	.045	10 Lb Tubes
DM309LSi 1/16X33S	1/16	33 Lb Spools
DM309LSi 1/16X36E2	1/16	10 Lb Tubes
DM309LSi 3/32X60C	3/32	60 Lb Coils
DM309LSi 3/32X36E2	3/32	10 Lb Tubes
DM309LSi 1/8X60C	1/8	60 Lb Coils
DM309LSi 1/8X36E2	1/8	10 Lb Tubes
DM309LSi 5/32X60C	5/32	60 Lb Coils
DM309LSi 5/32X36E2	5/32	10 Lb Tubes





DuraMax 316LSi

Features: 316LSi has a high silicon level for increased puddle fluidity and toe wetting. It is similar to 316L, with higher silicon content for optimum ease and speed in MIG welding and smooth bead appearance. This alloy is primarily used to weld low carbon molybdenum bearing austenitic alloys. The lower carbon content of .03 % max. is used to avoid carbide precipitation. This wire performs exceptionally at high wire speeds. Can also be used for joining and cladding 316L joints and overlays.

Typical Application & Usage: Pulp and paper mills, stainless pipe and tubing, bakery and kitchen equipment, housings and impellers, hospital equipment and overlay.

Classification: ER316LSi

Diameters: .023", .030", .035", .045", 1/16", 3/32", 1/8", 5/32" and 3/16"

Formats: 2 Lb, 10 Lb, 33 Lb spools, 60 Lb Coils and 10 Lb tubes of TIG

Part #	Diameter	Format
DM316LSi 023X2S	.023	2 Lb Spools
DM316LSi 023X10S	.023	10 Lb Spools
DM316LSi 023X33S	.023	33 Lb Spools
DM316LSi 030X2S	.030	2 Lb Spools
DM316LSi 030X10S	.030	10 Lb Spools
DM316LSi 030X33S	.030	33 Lb Spools
DM316LSi 030X36UM (Unmarked)	.030	10 Lb Tubes
DM316LSi 035X2S	.035	2 Lb Spools
DM316LSi 035X10S	.035	10 Lb Spools
DM316LSi 035X33S	.035	33 Lb Spools
DM316LSi 035X36UM (Unmarked)	.035	10 Lb Tubes
DM316LSi 045X2S	.045	2 Lb Spools
DM316LSi 045X10S	.045	10 Lb Spools
DM316LSi 045X33S	.045	33 Lb Spools
DM316LSi 045X36E2	.045	10 Lb Tubes
DM316LSi 1/16X33S	1/16	33 Lb Spools
DM316LSi 1/16X36E2	1/16	10 Lb Tubes
DM316LSi 3/32X60C	3/32	60 Lb Coils
DM316LSi 3/32X36E2	3/32	10 Lb Tubes
DM316LSi 1/8X60C	1/8	60 Lb Coils
DM316LSi 1/8X36E2	1/8	10 Lb Tubes
DM316LSi 5/32X60C	5/32	60 Lb Coils
DM316LSi 5/32X36E2	5/32	10 Lb Tubes



WELDING ALLOYS

Filler Metal Selection Chart for Welding Austenitic

Base Stainless Steel		Recommended Filler Metal		
Wrought	Cast	Coated Electrode	Solid, Metal Core Wire	Flux Core Wire
201		E209, E219, E308	ER209, ER219, ER308, ER308Si	E308TX-X
202		E209, E219, E308	ER209, ER219, ER308, ER308Si	E308TX-X
205		E240	ER240	
216		E209	ER209	E316TX-X
301		E308	ER308, ER308Si	E308TX-X
302	CF-20	E308	ER308, ER308Si	E308TX-X
304	CF-8	E308, E309	ER308, ER308Si, ER309, ER309Si	E308TX-X, E309TX-X
304H		E308H	ER308H	
304L	CF-3	E308L, E347	ER308L, ER308LSi, ER347	E308TX-X, E347TX-X
304LN		E308L, E347	ER308L, ER308LSi, ER347	E308TX-X, E347TX-X
304N		E308, E309	ER308, ER308Si, ER309, ER309Si	E308TX-X, E309TX-X
304HN		E308H	ER308H	
305		E308, E309	ER308, ER308Si, ER309, ER309Si	E308TX-X, E309TX-X
308		E308, E309	ER308, ER308Si, ER309, ER309Si	E308TX-X, E309TX-X
308L		E308L, E347	ER308L, ER308LSi, ER347	E308TX-X, E347TX-X
309	CH-20	E309, E310	ER309, ER309Si, ER310	ER309TX-X, ER310TX-X
309S	CH-10	E309L, E309Cb	ER309L, ER309LSi	E309LTX-X, ER309CbLTX-X
309SCb		E309Cb		ER309CbLTX-X
309CbTa		E309Cb		ER309CbLTX-X
310	CK-20	E310	ER310	E310TX-X
310S		E310Cb, E310	ER310	E310TX-X
312	CE-30	E312	ER312	E312T-3
314		E310	ER310	E310TX-X
316	CF-8M	E316, E308Mo	ER316, ER308Mo	E316TX-X, E308MoTX-X
316H	CF-12M	E316H, E16-8-2	ER316H, ER16-8-2	E316LTX-X, E308MoTX-X
316L	CF-3M	E316L, E308MoL	ER316L, ER316LSi, ER308MoL	E316LTX-X, E308MoLTX-X
316LN		E316L	ER316L, ER316Lsi	E316LT-X
316N		E316	ER316	E316TX-X
317	CG-8M	E317, E317L	ER317	E317LTX-X
317L		E317L, E316L	ER317L	E317LTX-X
321		E308L, E347	ER321	E308LTX-X, E347TX-X
321H		E347	ER321	E347TX-X
329		E312	ER312	E312T-3
330	HT	E330	ER330	
330HC		E330H	ER330	
332		E330	ER330	
347	CF-8C	E347, E308L	ER347, ER347Si	E347TX-X, E308LTX-X
347H		E347	ER347, ER347Si	E347TX-X
348		E347	ER347, ER347Si	E347TX-X
348H		E347	ER347, ER347Si	E347TX-X
Nitronic 33		E240	ER240	
Nitronic 40		E219	ER219	
Nitronic 50		E209	ER209	
Nitronic 60			ER218	
254SMo		ENiCrMo-3	ERNiCrMo-3	
AL-6XN		ENiCrMo-10	ERNiCrMo-10	



From AWS Filler Metal Specifications: A5.4, A5.9, A5.22, A5.14 and A5.11
For Reference Only

STAINLESS FLUX-CORED WIRES



“I came from the steel mill repair industry. I am a machinist by trade. I learned many facets of welding and weld repair when I was supervising for a very large company. You were treated like a number, not like you mattered, no matter how hard you worked or how well you tried. Here at Duramax, the atmosphere is almost something that doesn’t seem real. You would not think in today’s world you could find a company that puts you, the employee, first. Well I’m here to tell you, Duramax is the place! I would not trade this experience for anything, it has been great and I have enjoyed it beyond compare. Thanks, Duramax!”

**– Nelson Mitchell
DuraMax Sales Pro**



DuraMax 308LT-1

Features: This stainless flux-cored wire is an all position wire with features such as self-detaching slag, spray-like arc transfer and high moisture resistance. It can be run with single or multi-pass welds on stainless steels. This wire welds extremely well in vertical up, flat, horizontal and overhead. This wire has excellent welder appeal due to low spatter and less clean-up.

Typical Application & Usage: Typically used for joining common austenitic stainless steel types such as: 301, 302, 304, 304L, 321, CF-3 and CF-8. E308LT1-1/4 is used extensively in the fabrication of stainless steel structures, pressure vessels, tanks used in dairy, pulp and paper, textile dyeing, refinery and chemical equipment.

Classification: E308LT1-1/4

Diameters: .045" and 1/16"

Formats: 25 and 33 Lb Spools

Part #	Diameter	Format
DM308LT-1 045X25S	.045	25 Lb Spools
DM308LT-1 045X33S	.045	33 Lb Spools
DM308LT-1 1/16X25S	1/16	25 Lb Spools
DM308LT-1 1/16X33S	1/16	33 Lb Spools





Bridgest Holley

DuraMax 309LT-1

Features: This stainless flux-cored wire is for single or multi-pass welds on stainless steels. The extra low carbon content of E309LT1-1/4 provides excellent resistance to intergranular corrosion and stress corrosion cracking. This wire is noted for its low spatter generation, excellent bead shape and appearance and ease of slag removal. It has very good deposit efficiency when used for flat and fillet welds of medium and heavy thickness plates.

Typical Application & Usage: Typically used for joining common austenitic stainless steels such as: 304, 304L, 309, 309L. It is often used in dissimilar welding, such as stainless steel to carbon steel, low alloy steel, heat-resistant steel and clad steel. E309LT1-1/4 is used extensively in the fabrication of type 309 stainless steel structures, furnace parts, high temperature containers, and aircraft heaters.

Classification: E309LT1-1/4

Diameters: .045" and 1/16"

Formats: 25 and 33 Lb Spools

Part #	Diameter	Format
DM309LT-1 045X25S	.045	25 Lb Spools
DM309LT-1 045X33S	.045	33 Lb Spools
DM309LT-1 1/16X25S	1/16	25 Lb Spools
DM309LT-1 1/16X33S	1/16	33 Lb Spools





DuraMax 316LT-1

Features: This stainless flux-cored wire is for single or multi-pass welds on stainless steels. E316LT-1/4 is noted for its low spatter generation, excellent bead shape and appearance and ease of slag removal. It has very good deposit efficiency when used for flat and fillet welds of medium and heavy thickness plates.

Typical Application & Usage: Typically used for joining and cladding of 316, 316L, CF-3M and CF-8M stainless steels. E316LT1-1/4 is used extensively in the fabrication of 18% Cr 12% Ni 2% Mo stainless steel structures, pressure vessels, tanks in dairy, pulp and paper, textile dyeing, refinery and chemical equipment. The extra low carbon content reduces carbide precipitation. E316LT1-1/4 can be used to weld stainless steels of similar compositions when welds are required to meet higher corrosion resistance and higher creep strength requirements along with intergranular corrosion resistance requirements.

Classification: E316LT-1

Diameters: .045" and 1/16"

Formats: 25 and 33 Lb Spools

Part #	Diameter	Format
DM316LT-1 045X25S	.045	25 Lb Spools
DM316LT-1 045X33S	.045	33 Lb Spools
DM316LT-1 1/16X25S	1/16	25 Lb Spools
DM316LT-1 1/16X33S	1/16	33 Lb Spools



NICKEL ALLOYS



“Your work is to discover your world and then with all your heart to give yourself to it.”

- Buddha

“I have enjoyed doing that at Weld Wire and DuraMax for the last 17 years.”

**Melissa Yashura
Accounting**



DuraMax 625

Features: This NiCrMo alloy provides excellent resistance to oxidizing. The high molybdenum content provides good stress, pitting and crevice corrosion resistance. Most popular nickel alloy for cladding. It can be used to weld dissimilar metal combinations such as steel, stainless steel, Inconel and Incoloy alloys.

Classification: ERNiCrMo-3

Diameters: .030", .035", .045" and 1/16 in MIG
.035", .045", 1/16, 3/32, 1/8 and 5/32 in TIG

Formats: 33 Lb spools, 60 Lb coils, 550 Lb drums, 500 Lb reels and 10 Lb tubes

Part #	Diameter	Format
DMNA625 030X33S	.030	33 Lb Spools
DMNA625 030X550D	.030	550 Lb Drums
DMNA625 030X500R	.030	500 Lb Reels
DMNA625 035X33S	.035	33 Lb Spools
DMNA625 035X550D	.035	550 Lb Drums
DMNA625 035X500R	.035	500 Lb Reels
DMNA625 045X33S	.045	33 Lb Spools
DMNA625 045X550D	.045	550 Lb Drums
DMNA625 045X500R	.045	500 Lb Reels
DMNA625 1/16X33S	1/16	33 Lb Spools
DMNA625 1/16X550D	1/16	550 Lb Drums
DMNA625 1/16X500R	1/16	500 Lb Reels
DMNA625 035X36	.035	10 Lb Tubes
DMNA625 045X36E2	.045	10 Lb Tubes
DMNA625 1/16X36E2	1/16	10 Lb Tubes
DMNA625 3/32X36E2	3/32	10 Lb Tubes
DMNA625 3/32X60C	3/32	60 Lb Coils
DMNA625 1/8X36E2	1/8	10 Lb Tubes
DMNA625 1/8X60C	1/8	60 Lb Coils
DMNA625 5/32X36E2	5/32	10 Lb Tubes





DuraMax 82

Features: This NiCr Alloy 82 is used for the welding of Inconel alloys 600, 601 and 690, Incoloy alloys 800 and 800HT, and Inco alloy 330. Alloy 82 is used in dissimilar welding such as joining Inconel alloys, Incoloy alloys and Incoloy alloy 330 to nickel, Monel alloys, stainless steels and carbon steels. This filler metal is also used to join stainless steels to nickel alloys to carbon steels. It is also used for surfacing of steel. Weld metal deposited by Inconel filler metal 82 has high strength and good corrosion resistance, including oxidation resistance and creep-rupture strength at elevated temperatures.

Classification: ERNiCr-3

Diameters: .030", .035", .045" and 1/16 in MIG
.035", .045", 1/16, 3/32, 1/8 and 5/32 in TIG

Formats: 33 Lb spools, 550 Lb drums, 500 Lb reels and 10 Lb tubes

Part #	Diameter	Format
DMNA082 030X33S	.030	33 Lb Spools
DMNA082 030X550D	.030	550 Lb Drums
DMNA082 030X500R	.030	500 Lb Reels
DMNA082 035X33S	.035	33 Lb Spools
DMNA082 035X550D	.035	550 Lb Drums
DMNA082 035X500R	.035	500 Lb Reels
DMNA082 045X33S	.045	33 Lb Spools
DMNA082 045X550D	.045	550 Lb Drums
DMNA082 045X500R	.045	500 Lb Reels
DMNA082 1/16X33S	1/16	33 Lb Spools
DMNA082 1/16X550D	1/16	550 Lb Drums
DMNA082 1/16X500R	1/16	500 Lb Reels
DMNA082 035X36	.035	10 Lb Tubes
DMNA082 045X36E2	.045	10 Lb Tubes
DMNA082 1/16X36E2	1/16	10 Lb Tubes
DMNA082 3/32X36E2	3/32	10 Lb Tubes
DMNA082 1/8X36E2	1/8	10 Lb Tubes
DMNA082 5/32X36E2	5/32	10 Lb Tubes





DuraMax Nickel 99

Features: This nickel alloy is used for MIG and TIG welding of cast irons. A major use is for the repair of gray iron castings. The welds are easy to machine. This is excellent for the buildup of worn parts, repairing machining errors or defective castings where maximum machineability of the deposit is required. This alloy produces high quality welds with a minimal amount of effort. Weld deposits are strong, dense and fully machinable. Color will match that of cast iron.

Classification: ERNi-CI

Diameters: .035", .045" and 1/16 in MIG
.035"-1/8 in TIG

Formats: 33 Lb spools, 550 Lb drums, 500 Lb reels and 10 Lb tubes of TIG rods

Part #	Diameter	Format
DMNA099 035X33S	.035	33 Lb Spools
DMNA099 035X550D	.035	550 Lb Drums
DMNA099 035X500R	.035	500 Lb Reels
DMNA099 045X33S	.045	33 Lb Spools
DMNA099 045X550D	.045	550 Lb Drums
DMNA099 045X500R	.045	500 Lb Reels
DMNA099 1/16X33S	1/16	33 Lb Spools
DMNA099 1/16X550D	1/16	550 Lb Drums
DMNA099 1/16X500R	1/16	500 Lb Reels
DMNA099 035X36E2	.035	10 Lb Tubes
DMNA099 045X36E2	.045	10 Lb Tubes
DMNA099 1/16X36E2	1/16	10 Lb Tubes
DMNA099 3/32X36E2	3/32	10 Lb Tubes
DMNA099 1/8X36E2	1/8	10 Lb Tubes
DMNA099 5/32X36E2	5/32	10 Lb Tubes





DuraMax C-276

Features: This NiCrMo alloy is used for welding nickel-chromium-molybdenum base materials to itself, steel and other nickel base alloys and for cladding steel. Due to high molybdenum content, this alloy offers excellent resistance to stress corrosion cracking, pitting and crevice corrosion.

Classification: ERNiCrMo-4

Diameters: .035", .045" and 1/16 in MIG
.035"-1/8 in TIG

Formats: 33 Lb spools, 60 Lb coils, 500 Lb Reels and 10 Lb tubes of TIG rods

Part #	Diameter	Format
DMHASC276 030X33S	.030	33 Lb Spools
DMHASC276 035X33S	.035	33 Lb Spools
DMHASC276 035X500R	.035	500 Lb Reels
DMHASC276 045X33S	.045	33 Lb Spools
DMHASC276 045X500R	.045	500 Lb Reels
DMHASC276 1/16X33S	1/16	33 Lb Spools
DMHASC276 1/16X500R	1/16	500 Lb Reels
DMHASC276 035X36E2	.035	10 Lb Tubes
DMHASC276 045X36E2	.045	10 Lb Tubes
DMHASC276 1/16X36E2	1/16	10 Lb Tubes
DMHASC276 3/32X36E2	3/32	10 Lb Tubes
DMHASC276 3/32X60C	3/32	60 Lb Coils
DMHASC276 1/8X36E2	1/8	10 Lb Tubes
DMHASC276 1/8X60C	1/8	60 Lb Coils
DMHASC276 5/32X36E2	5/32	10 Lb Tubes





DuraMax Nickel 55

Features: This nickel alloy is typically used for welding of cast irons to other cast irons as well as joining cast irons to mild steels. This is readily used for the repair of castings. The welds are moderately hard and require carbide tipped tools for machining. It is also noted for high sulfur, phosphorus or lubricant-contaminated castings.

Classification: ERNiFe-CI

Diameters: .035", .045" and 1/16 in MIG
.035"-1/8 in TIG

Formats: 33 Lb spools and 10 Lb tubes of TIG rods

Part #	Diameter	Format
DMNA055 035X33S	.035	33 Lb Spools
DMNA055 045X33S	.045	33 Lb Spools
DMNA055 1/16X33S	1/16	33 Lb Spools
DMNA055 035X36E2	.035	10 Lb Tubes
DMNA055 045X36E2	.045	10 Lb Tubes
DMNA055 1/16X36E2	1/16	10 Lb Tubes
DMNA055 3/32X36E2	3/32	10 Lb Tubes
DMNA055 1/8X36E2	1/8	10 Lb Tubes
DMNA055 5/32X36E2	5/32	10 Lb Tubes

Other **DuraMax Nickel Alloys Available in MIG and TIG** include *but are not limited to:* Monel 60, Monel 61, Alloy 72, 622, 80SNi-1 and 80SNi-2



DuraMax Nickel Electrodes Available:
Nickel 55, Nickel 99, 112, 117, 182 and 190

CHROME-MOLY ALLOYS



**"Never start a business just to make money,
start a business to make a difference."**

– Marie Forleo



DuraMax 80S-B2

Features: This wire is a low alloy copper-coated solid wire with 1.25% Cr and 0.5% Mo content to be used for the welding of creep resistant steel. ER80S-B2 finds applications in the chemical industry, in the ammonia synthesis process, for heat exchangers, boilers, piping, and pressure vessels for temperature service up to about 1020°F (550°C). It will also find applications in the petro-chemical industries, as it is suitable for facing on casting and for casting repairs.

Classification: ER80S-B2

Diameters: .035", .045", .052" and 1/16 in MIG
.035", .045", 1/16, 3/32, 1/8 and 5/32 in TIG

Formats: 33 Lb spools, 550 Lb drums and 10 Lb tubes

Part #	Diameter	Format
DM80S-B2 035X33S	.035	33 Lb Spools
DM80S-B2 035X550D	.035	550 Lb Drums
DM80S-B2 045X33S	.045	33 Lb Spools
DM80S-B2 045X550D	.045	550 Lb Drums
DM80S-B2 052X550D	.052	550 Lb Drums
DM80S-B2 1/16X33S	1/16	33 Lb Spools
DM80S-B2 1/16X550D	1/16	550 Lb Drums
DM80S-B2 035X36	.035	10 Lb Tubes
DM80S-B2 045X36E2	.045	10 Lb Tubes
DM80S-B2 1/16X36E2	1/16	10 Lb Tubes
DM80S-B2 3/32X36E2	3/32	10 Lb Tubes
DM80S-B2 1/8X36E2	1/8	10 Lb Tubes
DM80S-B2 5/32X36E2	5/32	10 Lb Tubes



DuraMax 90S-B3

Features: This wire is a low alloy copper-coated solid wire with 2.25% Cr and 1% Mo content to be used for the welding of creep resistant steel. The chemical composition of this wire conforms to AWS specification. Pinnacle Alloys ER90S-B3 is suitable for applications in the chemical industry, in the ammonia synthesis process, for heat exchangers, boilers, piping, and pressure vessels for temperature service up to 1110°F (600°C). It can also be used in the petro-chemical industry where it is suitable for facing on casting and for casting repairs.

Classification: ER90S-B3

Diameters: .035", .045" and 1/16 in MIG
.035", .045", 1/16, 3/32, 1/8 and 5/32 in TIG

Formats: 33 Lb spools, 550 Lb drums and 10 Lb tubes

Part #	Diameter	Format
DM90S-B3 035X33S	.035	33 Lb Spools
DM90S-B3 035X550D	.035	550 Lb Drums
DM90S-B3 045X33S	.045	33 Lb Spools
DM90S-B3 045X550D	.045	550 Lb Drums
DM90S-B3 1/16X33S	1/16	33 Lb Spools
DM90S-B3 1/16X550D	1/16	550 Lb Drums
DM90S-B3 035X36	.035	10 Lb Tubes
DM90S-B3 045X36E2	.045	10 Lb Tubes
DM90S-B3 1/16X36E2	1/16	10 Lb Tubes
DM90S-B3 3/32X36E2	3/32	10 Lb Tubes
DM90S-B3 1/8X36E2	1/8	10 Lb Tubes
DM90S-B3 5/32X36E2	5/32	10 Lb Tubes

Other **DuraMax Chrome Moly Alloys Available in MIG and TIG** include *but are not limited to:* 80S-B6, 80S-B8 and 90S-B9

DuraMax Chrome Moly Flux-Cored Wires Available:

81T1-B2, 81T1-B6, 81T1-B8, 91T1-B3 and 91T1-B9

OTHER ALLOYS



CHELSEY BUSH



Blue Cobel

DuraMax SuperBlue Electrode 312-16

Features: This stainless electrode is commonly known to be a problem solver! If you are in a jam, this is a reliable rod to use for a wide variety of applications. SuperBlue has high strength weld deposits, excellent crack resistance, it's easily machinable, produces a smooth, finely rippled bead, has crisp, easy slag removal and welds in ALL positions.

Typical Application & Usage: Typically used on all grades of stainless steels, carbon steels, spring and case-hardened steels. This rod can be used to join any dissimilar combination of ferrous alloys as well as unknown or unidentified steels. It can even be used to remove broke off bolt studs or drill bits. It is used in pressure vessels, aircraft parts, pits and cracks in tool steels, buttering work-stressed steels prior to joining or hardfacing, underlay for hardfacing, cast steel repair, gears, shaft rebuilding, UNKNOWN steels and some cast iron repair work.

Classification: E312-16

Diameters: 3/32", 1/8", 5/32" and 3/16"

Formats: 10 Lb Tubes

Part #	Diameter	Format
DMSUPERBLUE 3/32	3/32	10 Lb Tubes
DMSUPERBLUE 1/8	1/8	10 Lb Tubes
DMSUPERBLUE 5/32	5/32	10 Lb Tubes
DMSUPERBLUE 3/16	3/16	10 Lb Tubes

WELDING ALLOYS



DuraMax 4043 Aluminum MIG and TIG

Features: This aluminum alloy features low melting temperature/high fluidity, low welding smut and discoloration, moderate strength (28 ksi typical), low ductility, formability and lower toughness. It has excellent corrosion resistance, low shrinkage rate/reduce distortion risk and low hot cracking sensitivity in most applications.



Typical Application & Usage: Typically used in welding 6XXX alloys, automotive/motorcycle frames, sports products, general repair and maintenance, housings and crankcases, cylinder heads and blocks, transmission housings, ornamental aluminum, boats, truck and bus bodies, vats, tanks and containers. 4043 is a 5% silicon aluminum alloy recommended for welding 3003, 3004, 5052, 6061, 6063, and cast alloy such as 443, 355, 356 and 214.

Classification: ER4043

Diameters: .030", .035", .040", 3/64", 1/16", 5/64", 3/32", 1/8", 5/32" and 3/16"

Formats: 1 Lb, 16 Lb and 20 Lb Spools as well as 10 Lb Tubes

Part #	Diameter	Format
DM4043 030X1S	.030	1 Lb Spools
DM4043 035X1S	.035	1 Lb Spools
DM4043 035X16S	.035	16 Lb Spools
DM4043 040X16S	.040	16 Lb Spools
DM4043 3/64X1S	3/64	1 Lb Spools
DM4043 3/64X16S	3/64	16 Lb Spools
DM4043 3/64X20S	3/64	20 Lb Spools

Part #	Diameter	Format
DM4043 1/16X36T	1/16	10 Lb Tubes
DM4043 5/64X36T	5/64	10 Lb Tubes
DM4043 3/32X36T	3/32	10 Lb Tubes
DM4043 1/8X36T	1/8	10 Lb Tubes
DM4043 5/32X36T	5/32	10 Lb Tubes
DM4043 3/16X36T	3/16	10 Lb Tubes

DuraMax 4043 Aluminum Electrodes

Features: The proper choice of aluminum filler metal mainly depends on the base metal properties to be achieved and welding technique. Post weld cracking, corrosion resistance and behavior under elevated temperature also need to be taken into consideration. Cracking usually can be minimized by choosing a filler metal alloy of higher alloy content than the base metal.



Typical Application & Usage: E4043 CTD is a coated electrode designed for maintenance welding of aluminums and aluminum alloys, such as 5454, 5154, 6052, 6063, 700 series.

Classification: E4043

Diameters: 3/32", 1/8" and 5/32"

Formats: 10 Lb Tubes

Part #	Diameter	Format
DM4043CTD 3/32	3/32	10 Lb Tubes
DM4043CTD 1/8	1/8	10 Lb Tubes
DM4043CTD 5/32	5/32	10 Lb Tubes



DuraMax 5356 Aluminum MIG and TIG

Features: This aluminum alloy features high ductility/fatigue strength and very high toughness. It has high strength (38 ksi typical), moderate formability and lower electrical conductivity and thermal conductivity. It has higher column strength/better feedability, very good color match after anodizing with 5XXX/6XXX base materials.



Typical Application & Usage: Typically used in welding 5086 and lower strength alloys, truck frames, shipbuilding, rail cars, castings and housings, cylinder heads, pipes and frames, oil pans and tanks, heat-treatable aluminum alloys, truck and bus bodies.

5356 is a 5% magnesium aluminum alloy recommended for welding 5050, 5052, 5083, 5356, 5454 and 5456.

Classification: ER5356

Diameters: .030", .035", .040", .045", 3/64, 1/16, 3/32, 1/8, 5/32 and 3/16

Formats: 1 Lb, 16 Lb, and 20 Lb spools as well as 10 Lb Tubes

Part #	Diameter	Format
DM5356 030X1S	.030	1 Lb Spools
DM5356 035X1S	.035	1 Lb Spools
DM5356 035X16S	.035	16 Lb Spools
DM5356 040X16S	.040	16 Lb Spools
DM5356 3/64X1S	3/64	1 Lb Spools
DM5356 3/64X16S	3/64	16 Lb Spools
DM5356 3/64X20S	3/64	20 Lb Spools
DM5356 1/16X16S	1/16	16 Lb Spools
DM5356 1/16X20S	1/16	20 Lb Spools

Part #	Diameter	Format
DM5356 1/16X36T	1/16	10 Lb Tubes
DM5356 3/32X36T	3/32	10 Lb Tubes
DM5356 1/8X36T	1/8	10 Lb Tubes
DM5356 5/32X36T	5/32	10 Lb Tubes
DM5356 3/16X36T	3/16	10 Lb Tubes

Other DuraMax Aluminum MIG Wires and TIG Rods Available:

1100, 4047, 5183, 5554, 5556

Please inquire with your Sales Pro or call our office:

1-800-692-5930

WELDING ALLOYS



**We are regularly adding products to our DuraMax Line.
Here are some other alloys available below.**

Other DuraMax Stainless MIG Wires AND TIG Rods Available:

310, 312, 317L, 320LR, 330, 347, 409CB, 410, 410NiMo, 420, 630 and 2209

Other DuraMax Stainless Flux-Cored MIG Wires Available:

308HT-1, 309HT-1, 316HT-1, 317LT-1, 318T-1, 320LRT-1

Other DuraMax Stainless Electrodes Available:

310-16, 310CB-16, 317L-16, 347-16,
410-16, 410NiMo-16 and 630-16

Other DuraMax Low Alloy Steel Wires Available:

100S-1, 110S-1, 120S-1 and 80S-D2

Various Diameters and Formats

DuraMax Mild Steel and Low Alloy Steel TIG Rods Available:

70S-2, RG45, RG60, 80S-D2, 70S-B2L and 80S-B3L

Other DuraMax Nickel Alloys Available in MIG and TIG

include *but are not limited to*: Monel 60, Monel 61, Alloy 72, 622, 80SNi-1 and 80SNi-2

DuraMax Nickel Electrodes Available:

Nickel 55, Nickel 99, 112, 117, 182 and 190



DuraMax Copper MIG Wires Available:

ERCu (**Deox Copper**), ERCuSi-A (**Silicon Bronze**) and ERCuAl-A2 (**Aluminum Bronze A-2**)

DuraMax Copper TIG Rods Available:

ERCu (**Deox Copper**), ERCuSi-A (**Silicon Bronze**) and ERCuAl-A2 (**Aluminum Bronze A-2**), **Low Fuming Bronze** (Bare and Coated), **ERCuNiAl** and **ERCuNiMnAl**



Other **DuraMax Chrome Moly Alloys Available in MIG and TIG** include *but are not limited to*: 80S-B6, 80S-B8 and 90S-B9

Chrome Moly Flux-Cored Wires Available: 81T1-B2, 81T1-B6, 81T1-B8, 91T1-B3 and 91T1-B9

Other Aluminum MIG Wires and TIG Rods Available:

1100, 4047, 5183, 5554, 5556

***To inquire about availability of any specific wire that you need, Please inquire with your Sales Pro or call our office:
1-800-692-5930**

MIG GUNS AND CONSUMABLES



“I can’t say enough wonderful things about the culture and people at DuraMax. So blessed to call my co-workers friends and family. We do our best to ensure our customers feel the same way.”

**– Wendy Bender
DuraMax Sales Pro**

250 Amp Air Cooled MIG Gun

Available MIG Guns & Set-up Options

Rated 280 Amps @ 60% Duty Cycle
& 250 Amps @ 80% Duty Cycle



MIG Guns Use Tweco® Style Front End Consumables

Part #	Back End	Wire Size	Length
LWM215-3035	LWM/Tweco®	.030"-.035"	15 Feet
LWM215-4045	LWM/Tweco®	.045"	15 Feet
M212-3035	Miller®	.030"-.035"	12 Feet
M215-3035	Miller®	.030"-.035"	15 Feet
M215-4045	Miller®	.045"	15 Feet
L215-3035	Lincoln®	.030"-.035"	15 Feet
L215-4045	Lincoln®	.045"	15 Feet

* Custom lengths available



#	Description	Part #
1	Nozzle, Short Stop 1/8" Recess 3/8" Bore	22-37-SS
	Nozzle, Adjustable 1/2" Bore	22-50
	Nozzle, Short Stop 1/8" Recess 1/2" Bore	22-50SS
	Nozzle, Adjustable 5/8" Bore	22-62
	Nozzle, Short Stop 1/8" Recess 5/8" Bore	22-62SS
1A	Nozzle, Self-Insulated 1/8" Recess 3/8" Bore	23-37
	Nozzle, Self-Insulated 1/8" Recess 1/2" Bore	23-50
	Nozzle, Self-Insulated 1/8" Recess 5/8" Bore	23-62
	Nozzle, Self-Insulated 1/8" Recess 3/4" Bore	23-75
	Nozzle, Self-Insulated Tapered 3/8" Bore	23T-37
	Nozzle, Self-Insulated Tapered Flush 3/8" Bore	23T-37-F
2	Nozzle Insulator/Retainer	32
4	Diffuser	52
4A	Diffuser	52FN

#	Description	Part #
3	Contact Tip, Standard .023"	14-23
	Contact Tip, Standard .030"	14-30
	Contact Tip, Standard .035"	14-35
	Contact Tip, Standard .045"	14-45
	Contact Tip, Standard .052"	14-52
	Contact Tip, Standard 1/16	14-116
	Contact Tip, Standard 5/64	14-564
	Contact Tip, Heavy Duty .035"	14H-35
	Contact Tip, Heavy Duty .045"	14H-45
	Contact Tip, Heavy Duty .052"	14H-52
	Contact Tip, Heavy Duty 1/16	14H-116
	Contact Tip, Heavy Duty 5/64	14H-564
	Contact Tip, Tapered .030"	14T-30
	Contact Tip, Tapered .035"	14T-35
	Contact Tip, Tapered .045"	14T-45
	Contact Tip, Tapered .052"	14T-52
	Contact Tip, Tapered 1/16	14T-116

250 Amp Air Cooled MIG Gun Parts Breakdown

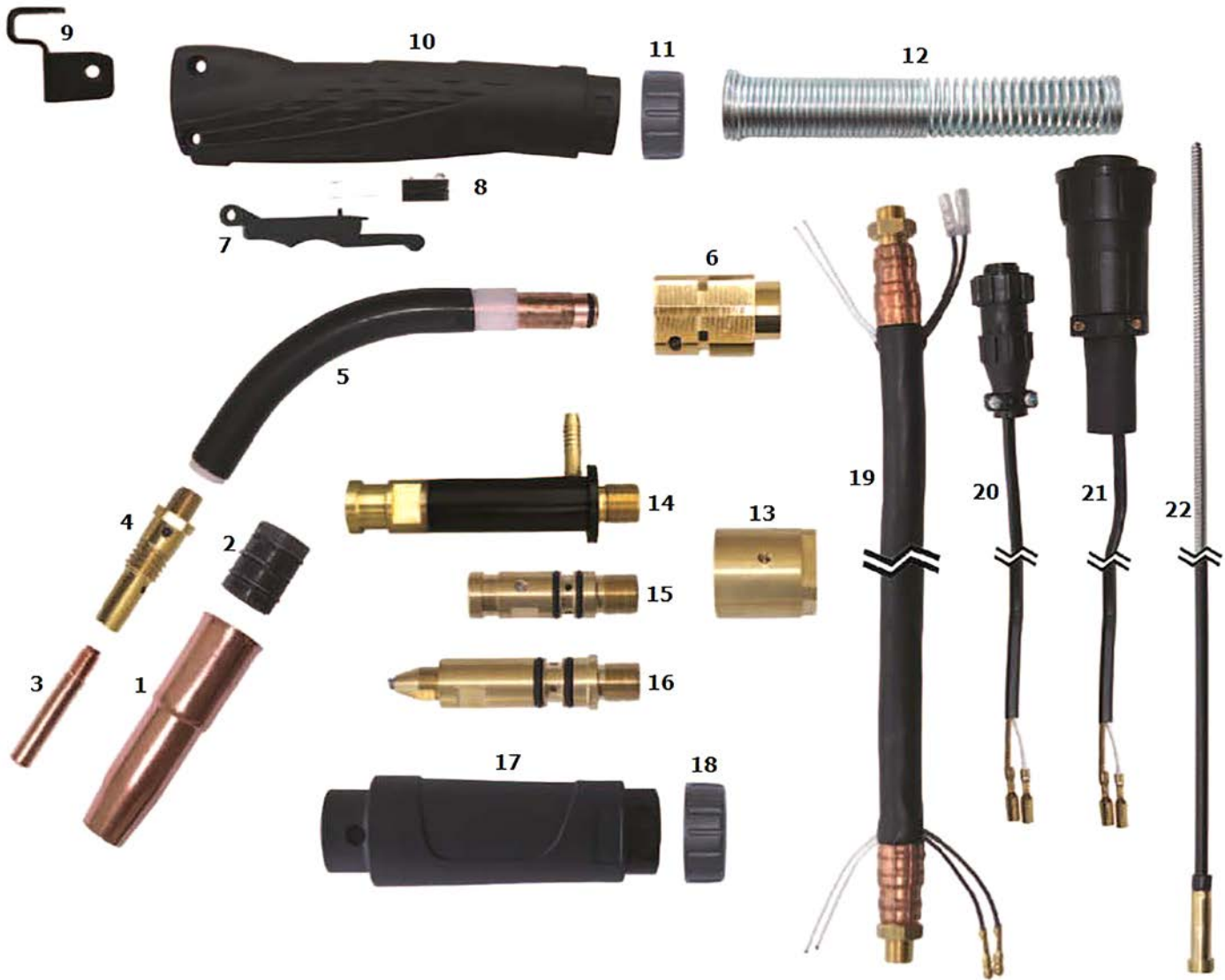

#	Description	Part #
1	Nozzle	See page 59
2	Nozzle Insulator/Retainer	32
3	Contact Tip	See page 59
4	Diffuser	See page 59
5	Conductor Tube	25CT
6	Tube Block	25BK
7	Comfort Grip Trigger	25TR
8	Trigger Blade	25TB
9	Gun Hanger	25GH
10	Handle 2 pcs w/screws	25HD
11	Handle Locking Ring	25HR
12	Strain Relief	25SR
13	Connector Body	24CB

#	Description	Part #
14	Connector Lincoln®	25LC
15	Connector Tweco®	25TC
16	Connector Miller®	25MC
17	Connector Case Assembly	25CA
18	Connector Locking Ring	40HR
19	Power Cable Assembly, 15'	24PC
20	Trigger Connector Miller®	25MA
21	Trigger Connector Lincoln®	25LA
22	Wire Conduit .023" x 15'	42-23-15
	Wire Conduit .030"-.035" x 15'	42-3035-15
	Wire Conduit .040"-.045" x 15'	42-4045-15
	Wire Conduit .030"-.035" x 25'	42-3035-25
	Wire Conduit .040"-.045" x 25'	42-4045-25

DURAMAX is not affiliated with Lincoln®, Miller®, Tweco®, Bernard® or Tregaskiss®. The parts shown in this catalog are not genuine brand name parts and are manufactured for DURAMAX. References to the above named brands, machines or part numbers are for convenience only.

400 Amp Air Cooled MIG Gun

Available MIG Guns & Set-up Options

Rated 400 Amps @ 60% Duty Cycle
& 350 Amps @ 80% Duty Cycle



MIG Guns Use Tweco® Style Front End Consumables

Part #	Back End Connection	Wire Size	Length
LWM415-3545	LWM/Tweco®	.035"-.045"	15 Feet
LWM415-116	LWM/Tweco®	.052"-1/16"	15 Feet
M415-3545	Miller®	.035"-.045"	15 Feet
M415-116	Miller®	.052"-1/16"	15 Feet
L415-3545	Lincoln®	.035"-.045"	15 Feet
L415-116	Lincoln®	.052"-1/16"	15 Feet

* Custom lengths available



#	Description	Part #
1	Nozzle, Self-Insulated 1/8" Recess, 3/8" Bore	23-37
	Nozzle, Self-Insulated 1/8" Recess, 1/2" Bore	23-50
	Nozzle, Self-Insulated 1/8" Recess, 5/8" Bore	23-62
	Nozzle, Self-Insulated 1/8" Recess, 3/4" Bore	23-75
	Nozzle, Self-Insulated Tapered 3/8" Bore	23T-37
	Nozzle, Self-Insulated Tapered Flush 3/8" Bore	23T-37F
1A	Nozzle, Adjustable 1/2"	24A-50
	Nozzle, Short Stop 1/8" Recess 1/2"	24A-50SS
	Nozzle, Adjustable 5/8"	24A-62
	Nozzle, Short Stop 1/8" Recess 5/8"	24A-62SS
	Nozzle, Adjustable 3/4"	24A-75
	Nozzle, Short Stop 1/8" Recess 3/4"	24A-75SS
1B	Retainer, Nozzle Insulator	34A
1C	Nozzle, Coarse Thread 1/8" Recess 1/2"	24CT-50S
	Nozzle, Coarse Thread 1/8" Recess 5/8"	24CT-62S
	Nozzle, Coarse Thread 1/8" Recess 3/4"	24CT-75S
1D	Insulator, Coarse Thread	34CT
3	Diffuser, Brass	54A
	Diffuser, Copper	54P

#	Description	Part #
2	Contact Tip, Standard .023"	14-23
	Contact Tip, Standard .030"	14-30
	Contact Tip, Standard .035"	14-35
	Contact Tip, Standard .045"	14-45
	Contact Tip, Standard .052"	14-52
	Contact Tip, Standard 1/16	14-116
	Contact Tip, Standard 5/64	14-564
	Contact Tip, Heavy Duty .035"	14H-35
	Contact Tip, Heavy Duty .045"	14H-45
	Contact Tip, Heavy Duty .052"	14H-52
	Contact Tip, Heavy Duty 1/16	14H-116
	Contact Tip, Heavy Duty 5/64	14H-564
	Contact Tip, Tapered .030"	14T-30
	Contact Tip, Tapered .035"	14T-35
	Contact Tip, Tapered .045"	14T-45
	Contact Tip, Tapered .052"	14T-52
	Contact Tip, Tapered 1/16	14T-116

400 Amp Air Cooled MIG Gun

Parts Breakdown

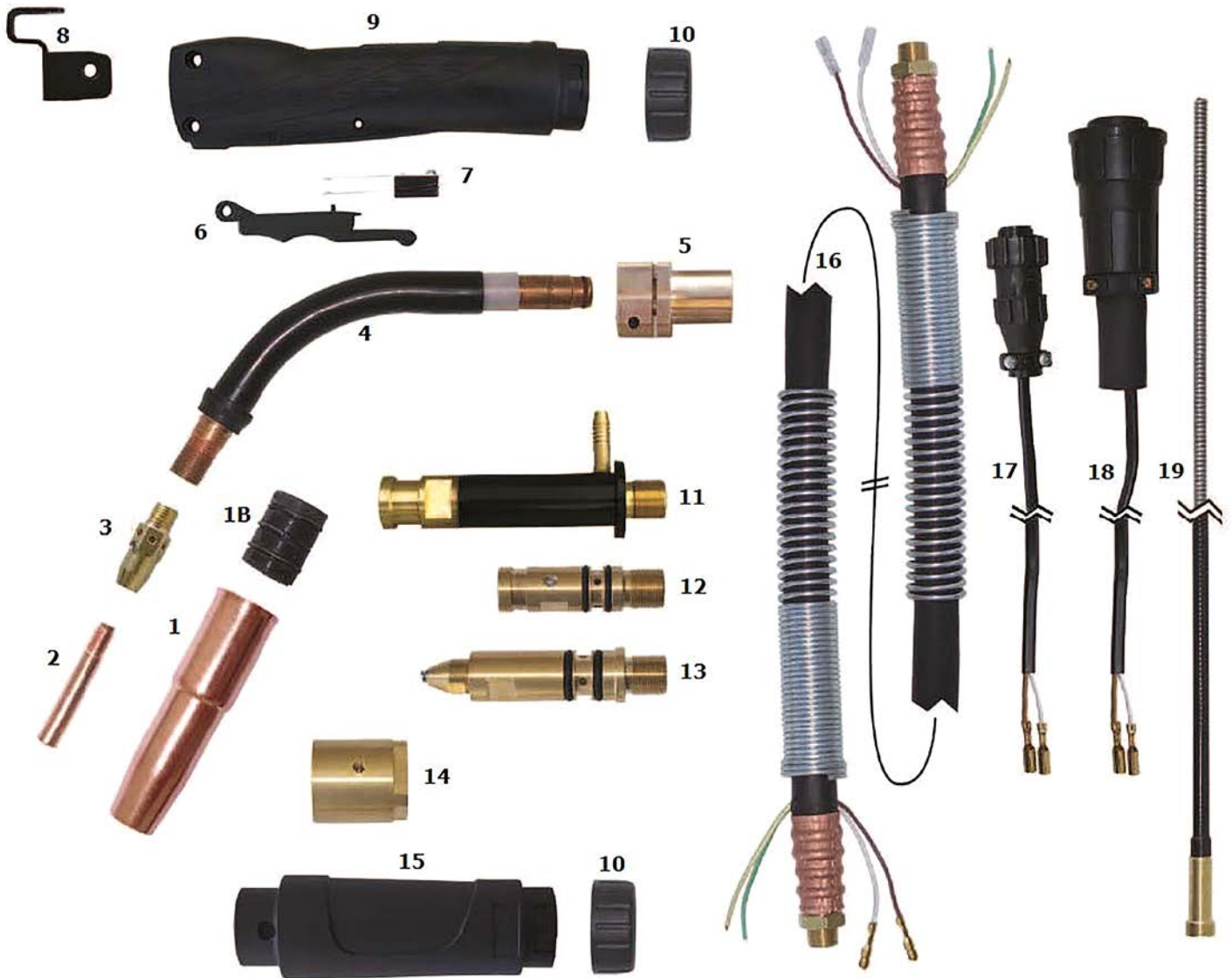

#	Description	Part #
1	Nozzle	See page 61
1B	Retainer/Nozzle Insulator	34A
2	Contact Tip	See page 61
3	Diffuser	See page 61
4	Conductor Tube	40CT
5	Tube Block	40BK
6	Comfort Grip Trigger	25TR
7	Trigger Blade	25TB
8	Gun Hanger	25GH
9	Handle 2 pcs w/screws	40HD
10	Handle Locking Ring	40HR
11	Connector (Lincoln®)	25LC
12	Connector (Tweco®)	25TC

#	Description	Part #
13	Connector Miller®	25MC
14	Connector Body	40CB
15	Connector Case Assembly	25CA
16	Power Cable Assembly, 15'	40PC
17	Trigger Connector (Miller®)	25MA
18	Trigger Connector (Lincoln®)	25LA
19	Wire Conduit .035"-.045" x 15'	44-3545-15
	Wire Conduit .052"-1/16" x 15'	44-116-15
	Wire Conduit 5/64" x 15'	44-564-15
	Wire Conduit .035"-.045" x 25'	44-3545-25
	Wire Conduit .052"-1/16" x 25'	44-116-25
	Wire Conduit 5/64" x 25'	44-564-25

Bernard® Style MIG Consumables

CONTACT TIPS (Bernard® Style)



Part #	Description	Size
1588	Contact Tip, Standard Long	.030"
1589	Contact Tip, Standard Long	.035"
1590	Contact Tip, Standard Long	.045"
1591	Contact Tip, Standard Long	1/16"
1592	Contact Tip, Standard Long	5/64"
1593	Contact Tip, Standard Long	3/32"
1598	Contact Tip, Standard Long	.052"



Part #	Description	Size
4281	Contact Tip, Tapered	.035"
4282	Contact Tip, Tapered	.045"



Part #	Description	Size
7488	Contact Tip, Standard Short	.030"
7489	Contact Tip, Standard Short	.035"
7490	Contact Tip, Standard Short	.045"
7491	Contact Tip, Standard Short	1/16"
7492	Contact Tip, Standard Short	5/64"
7493	Contact Tip, Standard Short	3/32"
7498	Contact Tip, Standard Short	.052"

LINERS (Bernard® Style)



Part #	Description	Size	Length
43015	Wire Conduit	.023"-.030"	15'
43115	Wire Conduit	.035"-.045"	15'
43215	Wire Conduit	.045"-1/16"	15'
44115	Wire Conduit	.035"-.045"	15'
44215	Wire Conduit	.045"-.062"	15'
44225	Wire Conduit	.045"-.062"	25'
45415	Wire Conduit	3/32"	15'

INSULATOR CAPS (Bernard® Style)



Part #	Description	Gun
4323R	Insulator Cap	200-300 Amp
4423R	Insulator Cap	350-500 Amp

NOZZLES (Bernard® Style)



Part #	Description	Bore Diameter
4295	Nozzle, Brass Tapered	1/2"



Part #	Description	Bore Diameter
4391	Nozzle, Brass	5/8"
4392	Nozzle, Brass	1/2"
4393	Nozzle, Copper	5/8"
4394	Nozzle, Copper	1/2"



Part #	Description	Bore Diameter
4491	Nozzle, Brass	3/4"
4492	Nozzle, Brass	9/16"
4591	Nozzle, Copper	3/4"
4592	Nozzle, Copper	9/16"

DIFFUSERS (Bernard® Style)



Part #	With Nozzles	With Tips
4235	4391	15XX
	4392	
	4393	
	4394	
4335	4391	74XX
	4392	
	4393	
	4394	
	4295	



Part #	With Nozzles	With Tips
4435	4491	74XX
	4492	
	4591	
	4592	
4635	4491	15XX
	4492	
	4591	
	4592	

CONDUCTOR TUBES (Bernard® Style)



Part #	Description	Gun
4786	Body Tube	200-300 Amp
4790	Body Tube	400-500 Amp

Miller® Style MIG Consumables

CONTACT TIPS (Miller® Style)



Part #	Description	Size
087-299	Contact Tip	.023"
000-067	Contact Tip	.030"
000-068	Contact Tip	.035"
000-069	Contact Tip	.045"
172-024	Contact Tip	1/16"
172-025	Contact Tip	5/64"
172-034	Contact Tip	3/64"

***Guns: M15, M25/25M, M40/40AL**



Part #	Description	Size	I.D.
135-424	Contact Tip (Aluminum Wire)	.047"	.059"
135-425	Contact Tip (Aluminum Wire)	.062"	.078"
135-426	Contact Tip (Steel Wire)	.062"	.073"
135-427	Contact Tip (Steel Wire)	.030"	.035"
135-428	Contact Tip (Aluminum Wire)	.030"	.040"
135-429	Contact Tip (Steel Wire)	.047"	.054"
135-430	Contact Tip (Aluminum Wire)	.035"	.050"

***Guns: XR™/XRM™-15A/30A and 15W/30W XR™-Edge and Spoolmatic® 30A/30W**

NOZZLES (Miller® Style)



Part #	Description	Bore Diameter
169-715	Nozzle, Flush	1/2"

***Guns: M10, M15**



Part #	Description	Bore Diameter
169-724	Nozzle, 1/8" Tip Recess	1/2"
200-258	Nozzle, Flush	1/2"
169-725	Nozzle, 1/8" Tip Recess	5/8"
169-726	Nozzle, Flush	5/8"
169-727	Nozzle, 1/8" Tip Stickout	5/8"

***Guns: M25/25M, M40/40AL**



Part #	Description	Bore Diameter
050-115	Nozzle	1/2"
050-622	Nozzle	5/8"

***Guns: Spoolmatic® 1, 2, 3, 30A, XR™'s, XRM's**

DIFFUSERS & RETAINERS (Miller® Style)



Part #	Description
169-728	Gas Diffuser

***Guns: M25/25M, M40/40AL**



Part #	Description
169-729	Nozzle Retainer

***Guns: M25/25M, M40/40AL**



Part #	Description
169-716	Gas Diffuser/Nozzle Retainer

***Guns: M15**

LINERS (Miller® Style)



Part #	Description	Size	Length
194-010	Wire Conduit	.023"-.025"	15'
194-011	Wire Conduit	.030"-.035"	15'
194-012	Wire Conduit	.035"-.045"	15'

***Guns: M10, M15, M25/25M, M40/40AL**



Part #	Description	Size	Length
136-682	Wire Conduit Teflon	.023"-.035"	6.75"
136-683	Wire Conduit Teflon	.045"-1/16"	6.75"

***Guns: XR™-15A, 30A, 15W, 30W/XRM™-15A, 30A, 15W, 30W and Spoolmatic® 30A**

Tregaskiss® Style MIG Consumables

CONTACT TIPS (Tregaskiss® Style)



Part #	Description	Size
403-35	Contact Tip, Standard	.035"
403-45	Contact Tip, Standard	.045"
403-116	Contact Tip, Standard	1/16"



Part #	Description	Size
403-1-35	Contact Tip, Heavy Duty	.035"
403-1-45	Contact Tip, Heavy Duty	.045"
403-1-52	Contact Tip, Heavy Duty	.052"
403-1-116	Contact Tip, Heavy Duty	1/16"



Part #	Description	Size
403-3-35	Contact Tip, HD Tapered	.035"
403-3-45	Contact Tip, HD Tapered	.045"

DIFFUSERS (Tregaskiss® Style)



Part #	Description
402-3	Nozzle Retainer



Part #	Description
0404	Gas Diffuser (Standard Contact Tips)
404-1	Gas Diffuser (HD Contact Tips)



Part #	Description
402-4	Retainer Ring Only
404-3	Nozzle Retainer/Diffuser, Heavy Duty (HD tips)
404-13	Nozzle Retainer/Diffuser, w/set screw (HD tips)

WASHERS (Tregaskiss® Style)



Part #	Description	Gun
402-5	HD Shock Washer	350 Amp
402-7	Shock Washer	350 Amp

NOZZLES (Tregaskiss® Style)



Part #	Description	Bore Diameter
401-4-38	Nozzle, Insulated Flush	3/8"
401-4-50	Nozzle, Insulated 1/8" Recess	1/2"
401-4-62	Nozzle, Insulated 1/8" Recess	5/8"
401-5-62	Nozzle, HD Insulated 1/4" Recess	5/8"
401-5-75	Nozzle, HD Insulated 1/4" Recess	3/4"
401-6-62	Nozzle, HD Insulated 1/8" Recess	5/8"
401-6-75	Nozzle, HD Insulated 1/8" Recess	3/4"

LINERS (Tregaskiss® Style)



Part #	Description	Size	Length
415-35-15	Wire Conduit	.035-.045"	15'
415-116-15	Wire Conduit	.045"-1/16"	15'
415-116-2	Wire Conduit (Nylon Core)	.045"-1/16"	15'
415-116-25	Wire Conduit	3/64"-1/16"	25'

CONDUCTOR TUBES (Tregaskiss® Style)



Part #	Description	Gun
305-60	Body Tube 60°	300 Amp
405-45	Body Tube 45°	400 Amp
405-60	Body Tube 60°	400 Amp

MIG GUN BACK END OPTIONS REFERENCE PAGE

135 Amp Back End Options



Tweco® Style Guns



Miller® Style Guns

250 & 400 Amp Back End Options

Tweco® Style Guns



Miller® Style Guns



Lincoln® Style Guns



TIG TORCHES AND CONSUMABLES



“I’ve been buying welding wire from Brad at DuraMax for 22 years. He’s not just our salesman, he’s our friend.”

– Sammy Ungarini

17 SERIES TIG TORCH 150 AMP AIR COOLED

#	Description	Part #
1	Torch Body	17
2	Torch Body, Flex	17F
3	Torch Body, Flex w/Valve	17FV
4	Torch Body w/Valve	17V
5	Valve Stem	VS-2
6	Back Cap, Short	57Y04
7	Back Cap, Medium	57Y05
8	Back Cap, Long	57Y02
9	Power Cable 12.5' 2 pc.	57Y01-2
	Power Cable 25' 2 pc.	57Y03-2
10	Power Cable 12.5' 1 pc.	57Y01R
	Power Cable 25' 1 pc.	57Y03R
11	Handle, Ribbed	H-100R
12	Handle, Smooth	H-100
13	Gasket, Insulator	18CG
14	Collet	Page 70
15	Collet Body	Page 70
16	Nozzles	Page 70
17	Nozzles	Page 70
18	Nozzles	Page 70
19	Nozzles	Page 70
20	Switch Boot, Snap-on	BL-1S
21	Switch Boot, Rubber	BL-1
22	Switch, On/Off	SW2-0
23	Switch, Momentary Bulb	SW-1
	Switch, Momentary Flat	SW-1F
24	Cable Cover 3" x 10'	WC-3-10
	Cable Cover 3" x 22'	WC-3-22
	Cable Cover 4" x 10'	WC-4-10
	Cable Cover 4" x 22'	WC-4-22
25	Dinse 25mm w/18" Aux Hose	DA-917FS
26	Dinse 25mm for 2 pc. Cable	DP-25M
27	Dinse 50mm in-line	DI-917F
28	Dinse 50mm for 2 pc. Cable	DP-50M
29	Dinse 50mm w/18" Aux Hose	DA-917F
30	Power Cable Adapter	105Z57



17 SERIES TIG TORCH PACKAGES, 150 AMP

PART #	DESCRIPTION
17	AIR COOLED TORCH 150 AMP
17-12-2	Torch Pkg. 150 Amp, 12.5' 2pc.
17-12-R	Torch Pkg. 150 Amp, 12.5' Rubber
17-25-2	Torch Pkg. 150 Amp, 25' 2pc.
17-25-R	Torch Pkg. 150 Amp, 25' Rubber
17V	AIR COOLED TORCH 150 AMP W/ VALVE
17V-12-2	Torch Pkg. 150 Amp w/Valve, 12.5' 2pc.
17V-12-R	Torch Pkg. 150 Amp w/Valve, 12.5' Rubber
17V-25-2	Torch Pkg. 150 Amp w/Valve, 25' 2pc.
17V-25-R	Torch Pkg. 150 Amp w/Valve, 25' Rubber

17F	AIR COOLED TORCH 150 AMP FLEX
17F-12-2	Torch Pkg. 150 Amp Flex, 12.5' 2pc
17F-12-R	Torch Pkg. 150 Amp Flex, 12.5' Rubber
17F-25-2	Torch Pkg. 150 Amp Flex, 25' 2pc.
17F-25-R	Torch Pkg. 150 Amp Flex, 25' Rubber
17FV	AIR COOLED TORCH 150 AMP FLEX W/VALVE
17FV-12-2	Torch Pkg. 150 Amp Flex w/Valve, 12.5' 2pc.
17FV-12-R	Torch Pkg. 150 Amp Flex w/Valve, 12.5' Rubber
17FV-25-2	Torch Pkg. 150 Amp Flex w/Valve, 25' 2pc.
17FV-25-R	Torch Pkg. 150 Amp Flex w/Valve, 25' Rubber

18 SERIES TIG TORCHES

350 AMP and 500 AMP (18P) WATER COOLED

#	Description	Part #
1	Torch Body	18
2	Torch Body, Flex	18F
3	Torch Body, Pencil 180°	18P
4	Barrel (18P)	18PB
5	Torch Body w/Valve	18V
6	Back Cap, Long	57Y02
7	Back Cap, Medium	57Y05
8	Back Cap, Short	57Y04
9	Handle, Smooth	H200
10	Power Cable 12.5' Rubber	40V64R
	Power Cable 25' Rubber	41V29R
10A	Power Cable 12.5' Vinyl	40V64
	Power Cable 25' Vinyl	41V29
11	Water Hose 12.5' Rubber	40V74R
	Water Hose 25' Rubber	41V32R
11A	Water Hose 12.5' Vinyl	40V74
	Water Hose 25' Vinyl	41V32
12	Gas Hose 12.5' Rubber	40V75R
	Gas Hose 25' Rubber	41V30R
12B	Gas Hose 12.5' Vinyl	40V75
	Gas Hose 25' Vinyl	41V30
13	Gasket, Insulator	18CG
14	Collet	Page 70
15	Collet Body	Page 70
16	Nozzles	Page 70
17	Nozzles	Page 70
18	Nozzles	Page 70
19	Nozzles	Page 70
20	Valve Stem	VS-2
21	Switch Boot, Snap-on	BL-1S
22	Switch Boot, Rubber	BL-1
23	Switch, On/Off	SW2-0
24	Switch, Momentary Bulb	SW-1
	Switch, Momentary Flat	SW-1F
25	Dinse 50mm w/18" Water Hose	DA-1820L
26	Power Cable Adapter	45V11
27	Cable Cover 3" x 10'	WC-3-10
	Cable Cover 3" x 22'	WC-3-22
	Cable Cover 4" x 10'	WC-4-10
	Cable Cover 4" x 22'	WC-4-22



18 SERIES TIG TORCH PACKAGES, 350 AND 500 AMP

PART #	DESCRIPTION
18	WATER COOLED TORCH 350 AMP
18-12	Torch Pkg. 350 Amp, 12.5' Vinyl
18-12-R	Torch Pkg. 350 Amp, 12.5' Braided Rubber
18-25	Torch Pkg. 350 Amp, 25' Vinyl
18-25-R	Torch Pkg. 350 Amp, 25' Braided Rubber
18V	WATER COOLED TORCH 350 AMP W/VALVE
18V-12	Torch Pkg. 350 Amp w/Valve, 12.5' Vinyl
18V-12-R	Torch Pkg. 350 Amp w/Valve, 12.5' Braided Rubber
18V-25	Torch Pkg. 350 Amp w/Valve, 25' Vinyl
18V-25-R	Torch Pkg. 350 Amp w/Valve, 25' Braided Rubber
*Torch Package Includes: Torch, Handle, Power Cable, Water & Gas Hoses, Insulator and Long Back Cap	

18F	WATER COOLED TORCH 350 AMP FLEX
18F-12	Torch Pkg. 350 Amp Flex, 12.5' Vinyl
18F-12-R	Torch Pkg. 350 Amp Flex, 12.5' Braided Rubber
18F-25	Torch Pkg. 350 Amp Flex, 25' Vinyl
18F-25-R	Torch Pkg. 350 Amp Flex, 25' Braided Rubber
18P	WATER COOLED MACHINE TORCH 500 AMP
180°	
18P-12	Torch Pkg. 500 Amp Machine, 12.5' Braided Rubber
18P-25	Torch Pkg. 500 Amp Machin, 25' Braided Rubber

17 SERIES AND 18 SERIES TIG TORCH SET-UP OPTIONS

STANDARD SET-UP

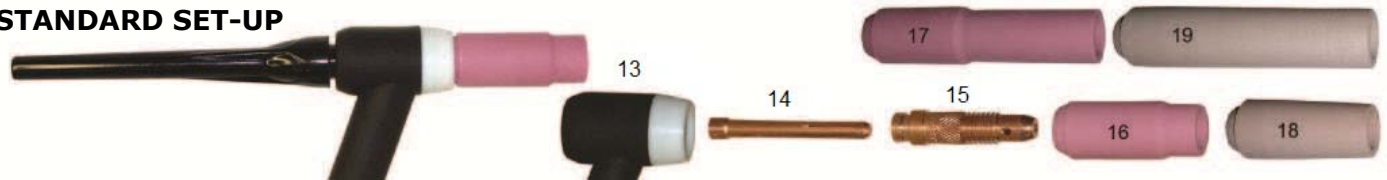

MEDIUM GAS LENS SET-UP



LARGE GAS LENS SET-UP

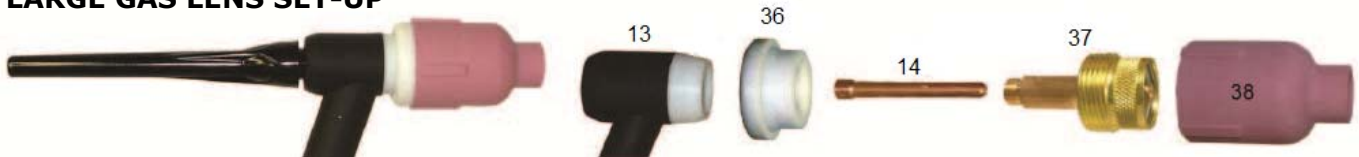

STUBBY COLLET BODY SET-UP



ELECTRODE DIAMETER		.020"	.040"	1/16"	3/32"	1/8"	5/32"	
		(0.5 mm)	(1.0 mm)	(1.6 mm)	(2.4 mm)	(3.2 mm)	(4.0 mm)	
NOZZLE SIZE	#	#4 (1/4")	#5 (5/16")	#6 (3/8")	#7 (7/16")	#8 (1/2")	#10 (5/8")	#12 (3/4")
STANDARD SET-UP								
Gasket Insulator	13	18CG	18CG	18CG	18CG	18CG	18CG	
Collet	14	10N21	10N22	10N23	10N24	10N25	54N20	
Collet Body	15	10N29	10N30	10N31	10N32	10N28	406488	
Alumina Nozzle Standard	16	10N50	10N49	10N48	10N47	10N46	10N45	10N44
Alumina Nozzle Long	17		10N49L	10N48L	10N47L			
Lava Nozzle Standard	18	105Z43	105Z42	105Z44	105Z45	08N78	08N79	08N80
Lava Nozzle Long	19	12N03	105Z60	12N02	105Z61			
MEDIUM GAS LENS SET-UP								
Gasket Insulator	31	54N01	54N01	54N01	54N01	54N01	54N01	
Gas Lens Collet Body	32	45V29	45V24	45V25	45V26	45V27	45V28	
Alumina Nozzle Gas Lens	33	54N18	54N17	54N16	54N15	54N14	54N19	
Alumina Nozzle Gas Lens Long	34		54N17L	54N16L	54N15L	54N14L		
Lava Nozzle Gas Lens	35	54N35	54N34	54N33	54N32	54N31	54N36	
LARGE GAS LENS SET-UP								
Gasket Insulator	36	54N63	54N63	54N63	54N63	54N63	54N63	
Gas Lens Collet Body	37	45V0204	45V0204	45V116	45V64	995795	45V63	
Alumina Nozzle Gas Lens	38			57N75		57N74	53N88	53N87 (#12)
Alumina Nozzle Gas Lens Long				57N75L		57N74L		53N89 (#15)
Alumina Nozzle Gas Lens XL				57N75XL		57N74XL		
STUBBY COLLET BODY SET-UP								
Gasket Insulator	39	18CG20	18CG20	18CG20	18CG20	18CG20		
Stubby Collet	40	10N21S	10N22S	10N23S	10N24S	10N25S		
Stubby Collet Body	41	17CB20	17CB20	17CB20	17CB20	17CB20		
Alumina Nozzle Standard	42	13N08	13N09	13N10	13N11	13N12	13N13	

20 SERIES TIG TORCHES

200 AMP (25) and 250 AMP WATER COOLED

#	Description	Part #
1	Torch Body	20
2	Torch Body, Pencil 180°	20P
3	Torch Body, Flex	20F
4	Torch Body, Pencil 180°	25
5	Torch Body, Mach. Fittings	20M
6	Back Cap, Long	41V24
7	Back Cap, Medium	41V35
8	Back Cap, Short	41V33
9	Cable Cover 3" x 10'	WC-3-10
	Cable Cover 3" x 22'	WC-3-22
	Cable Cover 4" x 10'	WC-4-10
	Cable Cover 4" x 22'	WC-4-22
10	Gas Hose, 12.5' Vinyl	45V09
	Gas Hose, 25' Vinyl	45V10
10A	Gas Hose, 12.5' Rubber	45V09R
	Gas Hose, 25' Rubber	45V10R
11	Water Hose, 12.5' Vinyl	45V07
*	Water Hose, 12.5' Vinyl*	45V07M
	Water Hose, 25' Vinyl	45V08
*	Water Hose, 25' Vinyl*	45V08M
11A	Water Hose, 12.5' Rubber	45V07R
*	Water Hose, 12.5" Rubber*	45V07RM
	Water Hose, 25' Rubber	45V08R
*	Water Hose, 25' Rubber*	45V08RM
12	Power Cable, 12.5' Vinyl	45V03
	Power Cable, 25' Vinyl	45V04
12A	Power Cable, 12.5' Rubber	45V03R
	Power Cable, 25' Rubber	45V04R
13	Gasket/Insulator	598882
14	Hose Clamp	53N04
15	Handle, Smooth+	H-100
	Handle, Smooth Threaded±	53N06
16	Collet	Page 72
17	Collet Body	Page 72
18	Nozzles	Page 72
19	Nozzles	Page 72
20	Nozzles	Page 72
21	Nozzles	Page 72
22	Nozzles	Page 72
23	Nozzles	Page 72
24	Switch Boot, Snap-on	BS-1S
25	Switch Boot, Rubber	BS-1
26	Switch, On/Off	SW2-0
27	Switch, Momentary Bulb	SW-1
	Switch, Momentary Flat	SW-1F
28	Dinse 50mm w/18" Water Hose	DA-1820L
29	Power Cable Adaptor	45V11



*Hoses for 20F, 20M & 22
 +Handle for 20F, 20M, 20P, & 25
 ±Handle for 20

20 SERIES TIG TORCH PACKAGES, 200-250 AMP

PART #	DESCRIPTION		
20	WATER COOLED TORCH 250 AMP		
20-12	Torch Pkg. 250 Amp, 12.5' Vinyl	20F-25	Torch Pkg. 250 Amp Flex, 25' Vinyl
20-12-R	Torch Pkg. 250 Amp, 12.5' Braided Rubber	20F-25-R	Torch Pkg. 250 Amp Flex, 25' Braided Rubber
20-25	Torch Pkg. 250 Amp, 25' Vinyl	20P	WATER COOLED TORCH 250 AMP PENCIL 180°
20-25-R	Torch Pkg. 250 Amp, 25' Braided Rubber	20P-12	Torch Pkg. 250 Amp Pencil 180°, 12.5' Vinyl
20M	WATER COOLED TORCH 250 AMP	20P-12-R	Torch Pkg. 250 Amp Pencil 180°, 12.5' Braided Rubber
20M-12	Torch Pkg. 250 Amp, 12.5' Vinyl	20P-25	Torch Pkg. 250 Amp Pencil 180°, 25' Vinyl
20M-12-R	Torch Pkg. 250 Amp, 12.5' Braided Rubber	20P-25-R	Torch Pkg. 250 Amp Pencil 180°, 25' Braided Rubber
20M-25	Torch Pkg. 250 Amp, 25' Vinyl	25	WATER COOLED TORCH 200 AMP FLEX PENCIL 180°
20M-25-R	Torch Pkg. 250 Amp, 25' Braided Rubber	25-12	Torch Pkg. 200 Amp Flex Pencil 180°, 12.5' Vinyl
20F	WATER COOLED TORCH 250 AMP FLEX	25-12-R	Torch Pkg. 200 Amp Flex Pencil 180°, 12.5' Braided
20F-12	Torch Pkg. 250 Amp Flex, 12.5' Vinyl Rubber	25-25	Torch Pkg. 200 Amp Flex Pencil 180°, 25' Vinyl
20F-12-R	Torch Pkg. 250 Amp Flex, 12.5' Braided Rubber	25-25-R	Torch Pkg. 200 Amp Flex Pencil 180°, 25' Braided

20 SERIES TIG TORCH SET-UP OPTIONS

STANDARD SET-UP

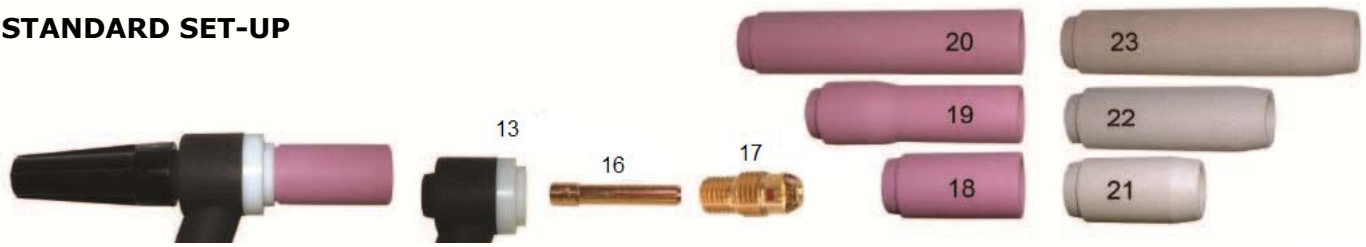

SMALL GAS LENS SET-UP

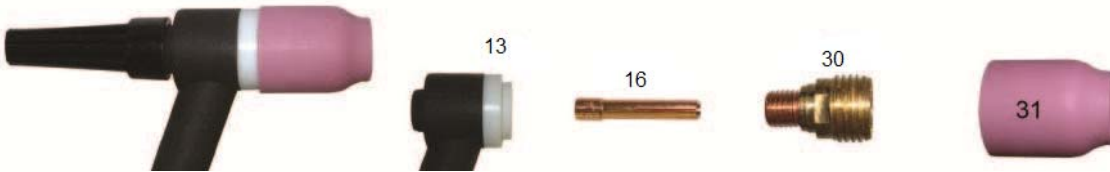

LARGE STUBBY GAS LENS SET-UP



ELECTRODE DIAMETER			.020" (0.5 mm)	.040" (1.0 mm)	1/16" (1.6 mm)	3/32" (2.4 mm)	1/8" (3.2 mm)	5/32" (4.0 mm)
NOZZLE SIZE	#	#3 (3/16")	#4 (1/4")	#5 (5/16")	#6 (3/8")	#7 (7/16")	#8 (1/2")	#10 (5/8")
STANDARD SET-UP								
Gasket Insulator	13		598882	598882	598882	598882	598882	
Collet	16		13N20	13N21	13N22	13N23	13N24	
Collet Body	17		13N25	13N26	13N27	13N28	13N29	
Alumina Nozzle Standard	18		13N08	13N09	13N10	13N11	13N12	
Alumina Nozzle Long	19	A796F70	A796F71	A796F72	A796F73			
Alumina Nozzle XL	20	A796F74	A796F75	A796F76	A796F77			
Lava Nozzle Standard	21		13N14	13N15	13N16	13N17	13N18	13N19
Lava Nozzle Long	22	796F70	796F71	796F72	796F73			
Lava Nozzle XL	23	796F74	796F75	796F76	796F77			
SMALL GAS LENS SET-UP								
Gasket Insulator	13		598882	598882	598882	598882	598882	
Gas Lens Collet Body	30		45V41	45V42	45V43	45V44	45V45	
Alumina Nozzle Gas Lens	31		53N58	53N59	53N60	53N61	53N61S	
LARGE STUBBY GAS LENS SET-UP								
Gasket Insulator	32		54N63-20	54N63-20	54N63-20	54N63-20	54N63-20	
Gas Lens Collet	33		13N20L	13N21L	13N22L	13N23L	13N24L	
Gas Lens Collet Body	34		45V0204S	45V0204S	45V116S	45V64S	995795S	
Alumina Nozzle Gas Lens	35				57N75		57N74	53N88
							#12 (3/4")	53N87
							#15 (15/16")	53N89

GOUGING TORCHES AND CARBONS



“My field guys said they’d never use any 7018’s that didn’t say Lincoln on it...5 years later, they say they won’t use any rods that don’t say DuraMax.”

– Craig Yemola

ARC GOUGING TORCHES AND GOUGING CARBONS

600 Amp and 1000 Amp Gouging Torches Available

*Heavy duty yet lightweight enough for everyday use

Available with 7' or 10' Cables



DC AIR CARBON ARC GOUGING ELECTRODES

POINTED CARBONS



SIZE	QTY/BOX
1/8" x 12" (3.2mm x 305mm)	100
5/32" x 12" (4.0mm x 305mm)	50
3/16" x 12" (5.0mm x 305mm)	50
1/4" x 12" (6.5mm x 305mm)	50
5/16" x 12" (8.0mm x 305mm)	50
3/8" x 12" (9.5mm x 305mm)	50
1/2" x 12" (13.0mm x 305mm)	50

JOINTED CARBONS

SIZE	QTY/BOX
3/8" x 17" (9.5mm x 430mm)	100
1/2" x 17" (13.0mm x 430mm)	100
5/8" x 17" (16.0mm x 430mm)	100
3/4" x 17" (19.0mm x 430mm)	100



HOLLOW POINTED CARBONS



SIZE	QTY/BOX
3/16" x 12" (5.0mm x 305mm)	50
1/4" x 12" (6.5mm x 305mm)	50
5/16" x 12" (8.0mm x 305mm)	50
3/8" x 12" (9.5mm x 305mm)	50

FLAT CARBONS

SIZE	QTY/BOX
3/8" x 5/32 X 12" (9.5mm x 4.0 x 305mm)	50
5/8" x 3/16 x 12" (13.0mm x 5.0mm x 305mm)	50



HOSES



“Our gas distributor always back orders our hard to get items. DuraMax stocks them for us on their delivery vans! Customer for life!”

**– Chris M.
Fabricating and Erecting Service**

WELDING HOSE ASSEMBLIES

What do the Grades R and T mean?

Grade R - for acetylene only. Tube and cover are not flame or oil resistant.

Grade T - for all fuel gases. Flame and oil resistant tube and cover.

When should I use Grade T hose?

If you are using a fuel gas other than acetylene, you **must** use Grade T hose.

Grade T hose ensures compatibility with the gas being conveyed and user safety.

If using acetylene, Grade T hose may provide additional features over the Grade R that make it beneficial for the applications. The tube and cover of the Grade T hose are self-extinguishing and provide maximum safety when exposed to adverse conditions such as hot slag, flash backs or inadvertent flame exposure.



GRADE R TWIN HOSE WELDING ASSEMBLIES

Economical welding hose for applications with acetylene fuel gas only.

All Grade R hose has a non-oil resistant cover.

Welding hose cover is red for acetylene; green for oxygen

Hose Grade	Part #	I.D. (inches)	Length (feet)	Fittings
GRADE R	DMHTI316X12	3/16"	12.5'	B-B
	DMHTI316X25	3/16"	25'	B-B
	DMHTI316X50	3/16"	50'	B-B
	DMHTI316X100	3/16"	100'	B-B
	DMHTI14X25	1/4"	25'	B-B
	DMHTI14X50	1/4"	50'	B-B
	DMHTI14X100	1/4"	100'	B-B

GRADE T TWIN HOSE WELDING ASSEMBLIES

Premium quality welding hose for use with fuel gases including acetylene.

All Grade T hose has a flame and oil resistant tube and cover.

Welding hose cover is red for fuel gas; green for oxygen

Hose Grade	Part #	I.D. (inches)	Length (feet)	Fittings
GRADE T	DMHTI316X12T	3/16"	12.5'	B-B
	DMHTI316X25T	3/16"	25'	B-B
	DMHTI316X50T	3/16"	50'	B-B
	DMHTI316X100T	3/16"	100'	B-B
	DMHTI14X25T	1/4"	25'	B-B
	DMHTI14X50T	1/4"	50'	B-B
	DMHTI14X100T	1/4"	100'	B-B

Single Line Green (or Black) Inert Gas Hose Assemblies

Are used as the hose connecting the regulator flow meter to a MIG welding machine or wire feeder to deliver shielding gas to the MIG gun. Alternatively, this hose can also be used for TIG torches as either a shielding gas hose or water hose (up to 200 psi).



Hose Grade	Part #	I.D. (inches)	Length (feet)	Fittings
GRADE R	DMHSIARGON6	1/4"	6'	AW14-A
	DMHSIARGON25	1/4"	25'	AW14-A
	DMHSIARGON50	1/4"	50'	AW14-A
	DMHSIARGON100	1/4"	100'	AW14-A

CGA

Information provided by: Compressed Gas Association

WELDING CABLE AND ACCESSORIES



WELDING CABLE REELS AND ASSEMBLIES



Suggested Ampacity Chart for Welding Cable

*This chart is for reference only since there are many variables in welding applications.

AMPS	50'	75'	100'	125'	150'	175'	200'	225'	250'	275'	300'	325'	350'
100	#4	#2	#2	#1	#1	1/0	2/0	2/0	3/0	3/0	3/0	4/0	4/0
150	#2	#2	#1	1/0	2/0	3/0	3/0	4/0	4/0				
200	#2	#1	2/0	3/0	3/0	4/0	4/0						
250	#1	1/0	3/0	4/0	4/0								
300	#1	2/0	3/0	4/0									
350	1/0	3/0	4/0										
400	2/0	3/0											
450	2/0	4/0											
500	3/0	4/0											
550	4/0												
600	4/0												

- *Resists abrasion, cut, tear, flame, grease, oil and water
- *RoHS Compliant
- *TEMP RANGE -50°C to +105°C (-58°F to 221°F) Rated 600 Volts
- *STOCK SIZES
Available in 250, 500 and 1,000' reels Cut to 25, 50 and 100' coils
- *PACKAGING
Coiled, boxed, and shrink wrapped
- *PRIVATE LABELING ALSO AVAILABLE



DUE TO THE FLUCTUATING COPPER PRICING, PLEASE CALL US FOR CURRENT PRICING ON WELDING CABLE REELS OR ASSEMBLIES

1-800-692-5930



Additional colors of welding cable are available upon request: Red, Blue, Yellow and Green

Ultra-Flex® is the most flexible welding cable on the market. Easily recognized with its bright orange jacket, Ultra-Flex® is the preferred cable for extremely cold work environments. We stock #2 thru 2/0 on 250', 500' and 1,000' reels and 25', 50' or 100' coils. Custom lengths also available upon request.



WELDING CABLE ACCESSORIES



Tweco Style



Lenco Style



Bernard Style

Part #	Description
DMEHT200	Tweco Style 200 Amp Electrode Holder
DMEHT250	Tweco Style 250 Amp Electrode Holder
DMEHT300	Tweco Style 300 Amp Electrode Holder
DMEHT350	Tweco Style 350 Amp Electrode Holder
DMEHT500	Tweco Style 500 Amp Electrode Holder
DMEHRAF200	Lenco Style 200 Amp Electrode Holder
DMEHRAF250	Lenco Style 250 Amp Electrode Holder
DMEHRAF300	Lenco Style 300 Amp Electrode Holder
DMEHRAF350	Lenco Style 350 Amp Electrode Holder
DMEHRAF500	Lenco Style 500 Amp Electrode Holder
DMEHB400	Bernard Style 400 Amp Electrode Holder
DMEHB600	Bernard Style 600 Amp Electrode Holder

Part #	Description
DMGCT200	Tweco Style 200 Amp Ground Clamp
DMGCT300	Tweco Style 300 Amp Ground Clamp
DMGCT500	Tweco Style 500 Amp Ground Clamp
DMGCL200	Lenco Style 200 Amp Ground Clamp
DMGCL300	Lenco Style 300 Amp Ground Clamp
DMGCL500	Lenco Style 500 Amp Ground Clamp
DMGCWAK200	Steel 200 Amp Ground Clamp
DMGCWAK300	Steel 300 Amp Ground Clamp
DMGCWAK500	Steel 500 Amp Ground Clamp

Tweco Style



Lenco Style



Steel Style



Cable Connectors



Cable Lugs

Part #	Description
DM1-MBP	Tweco Style Cable Connectors M/F set #4-#1 Cable
DM2-MBP	Tweco Style Cable Connectors M/F set 1/0-3/0 Cable
DM4-MBP	Tweco Style Cable Connectors M/F set 3/0-4/0 Cable
DM1020	Cable Lug 1/0-2/0 Cable
DM3040	Cable Lug 3/0-4/0 Cable
DM2AF	45 Degree Female Terminal Lug
DM2OF	180 Degree Female Terminal Lug



2AF Terminal Lug



2OF Terminal Lug

For any additional style cable accessories,
please contact your Sales Pro

CUTTING AND WELDING OUTFITS AND TIPS



“When working with DuraMax their customer service is second to none. They get it done!”

**– Linda B.
Purchasing**

Cutting and Welding Outfits

Torch Kit Welding and Cutting Medium Duty CGA 540/510



Part No: N3125510

This is the perfect torch for any shop or the back of any fabricators truck. It uses Victor style tips.
Complete Medium Duty Cutting, Welding & Heating Outfit Victor Style
Cuts up to 6", welds up to 3/8" steel with correct tip sizes.

Kit includes:

- HD acetylene (CGA 510) and oxygen (CGA 540) regulators, style 350
 - MD torch handle 100
 - MD cutting attachment 1350
 - Cutting tip
 - Heating head (6-MFA-1)
 - Welding nozzles (0-W-1, 2-W-1, 4-W-1)
 - 1/4" twin welding hose with B fittings, 12.5'
- Tip cleaner, goggles, spark lighter & check valve

Torch Kit Welding and Cutting Heavy Duty CGA 540/510



Part No: N3145510

Complete Heavy Duty Cutting, Welding & Heating Outfit Victor Style
Cuts up to 8", welds up to 1/2" steel with correct tip sizes.

Kit includes:

- HD acetylene (CGA 510) and oxygen (CGA 540) regulators, style 450
 - HD torch handle 315
 - HD cutting attachment 1060
 - Cutting tip
 - Heating head (8-MFA)
 - 3 Welding nozzles (1-W, 2-W, 3-W)
 - 1/4" twin welding hose with B fittings, 12.5'
- Tip cleaner, goggles, spark lighter & check valves

Cutting Tips



Victor Style 1-101 and 3-101

Victor Style 1-101 Tips: For acetylene-oxygen torches. Fits torches: 2460, CA 1060, ST, SST, 1400C machine torches.
Available Sizes: 000, 00, 0, 1, 2, 3, 4, 5, 6, 7 and 8

Victor Style 3-101 Tips: For acetylene-oxygen torches. Fits torches: CA 1260, CA 1350, CA 1450, CA 2060, CA 2460, CST 800 and 1400C.
Available Sizes: 000, 00, 0, 1, 2, 3, 4 and 5



Victor Style GPN and 3-GPN

Victor Style GPN Tips: For Propane-Oxygen, Natural Gas-Oxygen torches. Fits torches: 2450, CA 1060, CA 1060, ST, SST, STN, 1400C, machine torches.
Available Sizes: 00, 0, 1, 2, 3, 4, 5, 6, 7 and 8

Victor Style 3-GPN Tips: For Propane-Oxygen, Natural Gas-Oxygen torches. Fits torches: CA 1260, CA 1350, CA 1450, CA 2060, CA 2460, CST 800 and 1400C torches.
Available Sizes: 0, 1, 2, 3 and 4



Harris Style 6290

Harris Style 6290 Tips: For Acetylene, This one piece, all copper tip fits Harris torch models 62-3E, 142-4E, 880-E, 142-E and Harris cutting attachments model 73-3, 72-3, 71-3.
Available Sizes: 000, 00, 0, 1, 2, 3 and 4



Smith Style MC12 and SC12

Smith Style MC12 Tips: For acetylene use. Fits the following Smith equipment. MC509, CC509 and MC505.
Available Sizes: 00, 0, 1, 2, 3 and 4

Smith Style SC12 Tips: For acetylene use. Fits the following Smith equipment. SC209, SC205, SC225, SC229, SC175.
Available Sizes: 00, 0, 1, 2, 3 and 4



Smith Style SC50

Smith Style SC50 Tips: For propane use. Fits all Smith SC series torches including the SC209, SC205, SC225, SC229, SC175, and SC929.

Available Sizes: 1, 2, 3, 4, 5, 6, 7, 8 and 9



Airco Style 144 and 164

Airco Style 144 Tips: One piece tip for acetylene-oxygen. Medium Duty preheat for general hand or machine cutting. Fits Airco 4700, 4800, 5700, 5800, 1100, 3000, 9000, 9500, 9700 torches.

Available Sizes: 00, 0, 1, 2, 3, 4, 5, and 6

Airco Style 164 Tips: One piece tip for acetylene-oxygen. Very heavy preheat for general cutting. Also for use in cutting cast iron and stainless steel. Fits Airco 4700, 4800, 5700, 5800, 1100, 3000, 9000, 9500, 9700 torches.

Available Sizes: 00, 0, 1, 2, 3, 4, 5, 6, 7 and 8



Airco Style 261

Airco Style 261 Tips: Two piece tip for propane-oxygen or natural gas-oxygen. Heavy preheat for general hand cutting. Fits Airco 4700, 4800, 5700, 5800, 1100, 3000, 9000, 9500, 9700, 2900 torches.

Available Sizes: 00, 0, 1, 2, 3, 4, 5, 6, 7, 8, 9 and 10

TUNGSTEN



“Jessica and Brent, along with the Duramax team always go the extra mile to provide plus one customer service for my companies filler metal and hardware needs. They prove to be professional and responsive each and every time that I call on them for my companies wide variety of product requirements. I would highly recommend the Duramax brand to every end user that purchases products related to the welding industry.”

**— Denny M.
Account Manager**

Type	Typical Sizes	Applications	Alloying Element	Appropriate Compositions	Materials Welded
PURE TUNGSTEN (EWP)					
Pure tungsten has a high "work-function" which makes it difficult to start and maintain a stable arc. High burn-off rate results in short service life. Forms a clean, balled end when heated.	.040" X 7"	AC	None	99.5% Tungsten 0.5% Other	Aluminum Magnesium
	1/16" X 7"				
	3/32" X 7"				
	1/8" X 7"				
	5/32" X 7"				
2% CERIATED TUNGSTEN (EWCe2)					
Good for low amperage, DC orbital tube, pipe, thin sheet, and small part applications, this non-radioactive formula offers low current capacity, low arc ignition, and good arc stability. Can also be used proficiently in AC processes.	.040" X 7"	DC Advanced AC	Cerium	97.3% Tungsten 1.8-2.2% Cerium 0.5% Other	Carbon Steel Stainless Steel Nickel Titanium Aluminum
	1/16" X 7"				
	3/32" X 7"				
	1/8" X 7"				
	5/32" X 7"				
1.5% LANTHANATED TUNGSTEN (EWLa-1.5)					
Lanthanated tungsten is among the most commonly used nonradioactive. Offering long electrode life under heavy or pulsing amperage loads. Provides excellent arc stability and re-ignition. Less prone to tip wear. Ability to resist thermal shock and low burn-off rate.	.040" X 7"	DC Advanced AC	Lanthanum	97.8% Tungsten 1.3-1.7% Lanthanum 0.5% Other	Carbon Steel Stainless Steel Nickel Titanium Aluminum
	1/16" X 7"				
	3/32" X 7"				
	1/8" X 7"				
	5/32" X 7"				
2% LANTHANATED TUNGSTEN (EWLa-2)					
Non-radioactive substitute for 2% Thoriated. Similar characteristics to 1.5% Lanthanated with better arc starting, arc stability and less tip erosion.	.040" X 7"	DC Advanced AC	Lanthanum	97.3% Tungsten 1.8-2.2% Lanthanum 0.5% Other	Carbon Steel Stainless Steel Nickel Titanium Aluminum
	1/16" X 7"				
	3/32" X 7"				
	1/8" X 7"				
	5/32" X 7"				
E3 TUNGSTEN					
E3 Tungsten Electrodes use 1.5% lanthanum oxide (plus other oxides) instead of 2.0% thorium oxide. Because the conductivity of E3 Tungsten Electrodes is similar to that of thoriated tungsten electrodes, the transition to E3 Tungsten Electrodes can normally be made with little or no modification of the welding process itself.	.040" X 7"	AC and DC	Lanthanum Zirconium Yttrium	98.34% Tungsten, 1.5% Lanthanum, .08% Zirconium and .08% Yttrium	Carbon Steel Stainless Steel Nickel Aluminum Titanium
	1/16" X 7"				
	3/32" X 7"				
	1/8" X 7"				
	5/32" X 7"				
2% THORIATED TUNGSTEN (EWTh-2)					
Offers good arc starting is ideal for high-current requirements. Also good for low-amp AC applications with a modified point. This formula is a popular general purpose electrode due to the excellent arc behavior and good tip life; however, this is a radioactive formula. Vapors, grinding dust and disposal of thorium dioxide raise health, safety and environmental concerns.	.040" X 7"	DC	Thorium	97.3% Tungsten 1.7-2.2% Thorium 0.5 Other	Carbon Steel Stainless Steel Nickel Titanium Copper
	1/16" X 7"				
	3/32" X 7"				
	1/8" X 7"				
	5/32" X 7"				
ZIRCONIATED TUNGSTEN (EWZr-1)					
Used for radiographic quality welding, where tungsten contamination must be minimized. Balls up easily in AC applications. Good ignition and excellent current capacity. Non-radioactive.	.040" X 7"	AC	Zirconium	98.6% Tungsten 0.7-0.9% Zirconium 0.5% Other	Aluminum Magnesium
	1/16" X 7"				
	3/32" X 7"				
	1/8" X 7"				
	5/32" X 7"				

ABRASIVES



“My experience with Duramax has been nothing but positive. It is a people business and they have one of the best people around, Wendy. Wendy goes above and beyond to get us what we need even if we don’t know exactly what we are looking for. She does the research and gets it in a hurry. On top of her excellent work ethic and reliability she has a positive attitude and is always a breath of fresh air when she stops into our shop. She’s become more like extended family here at Raser. We appreciate everything Duramax and Wendy does for us!”

**— Jim W.
Operations Manager
Raser industries**

Cut-Off Wheels

Quickie Cut™ Contaminate-Free Cut-Off Wheels—Type 1

Contaminant free wheels contains $\leq 0.1\%$ iron, sulfur, or chlorine for rust-free and corrosion-free results.

High quality grain mixture is more friable and cuts freely.

WA: White Aluminum Oxide grain for **stainless steel**, food grade and nuclear applications.



WA60-TB-Flex



WA36-T-Rigid



Type 1 Reinforced Quickie-Cut™

Size	RPM	Carton Qty.	WA60-TB-FLEX	WA36-T-RIGID
4 1/2" X .035 X 7/8	13,300	25	DM36303	
4 1/2" X .045 X 7/8	13,300	25		DM35515
5" X .040 X 7/8	12,250	25	DM36304	
5" X .045 X 7/8	12,250	25		DM36301
6" X .040 X 7/8	10,200	25		
6" X .045 X 7/8	10,200	25		DM36302
7" X 1/16 X 7/8	8,500	25		DM53259
9" X 1/16 X 7/8	6,600	25		DM53260

Type 27 Reinforced Quickie-Cut™

Size	RPM	Carton Qty.	WA60-R
4 1/2" X .045 X 7/8	13,300	25	45003
4 1/2" X .045 X 5/8-11	13,300	10	45154
5" X .045 X 7/8	12,250	25	45006
5" X .045 X 5/8-11	12,250	10	45155
6" X .045 X 7/8	10,200	25	45017
6" X .045 X 5/8-11	10,200	10	45156
7" X 1/16 X 7/8	8,500	25	45009
7" X 1/16 X 5/8-11	6,600	10	45157

Stationary Saw Wheels

Fast Cut Stationary Saw Wheels

*Economical choice for metal, steel and general applications



ALUMINUM OXIDE

Stationary Saw



Type 1

Size	RPM	Carton Qty.	SPEC	Part #
10" X 1/8 X 5/8	6,110	10	A24-R-BF	DM70111
12" X 1/8 X 1	5,100	10	A24-R-BF	DM70105
14" X 1/8 X 1	4,400	10	A24-Q-BF	DM36233
16" X 5/32 X 1	3,820	10	A24-R-BF	DM70106
18" X 5/32 X 1	3,400	10	A24-R-BF	DM70107
20" X 5/32 X 1	3,100	10	A24-R-BF	DM70108
20" X 3/16 X 1	3,100	10	A24-R-BF	DM70109

Application Chart – Stationary Saw Cut-Off Wheels	
<p>A24R *</p> <ul style="list-style-type: none"> * Angle Iron – General * Iron / Steel Bar • Metal Decking & Cable * Pipe Line • Wall Studs • High Tensile Steel • Stainless Steel Sheets • Stainless Steel Bars • Rail Cutting * Cast Steel * Gray Cast Iron * Ductile Iron Pipe & Concrete Aluminum Alloys Copper Brass, Bronze Titanium Asphalt / Green Concrete Concrete Roof – Tiles Slate Masonry Marble Paving Bricks Firing Bricks Solid Bricks Clay Pipe 	<p>* Recommended • May be used</p>

High Speed Cut-Off Wheels

Fast Cut 12-14" Type 1 High Speed Cut-Off Wheels

*A24R: Aluminum Oxide—Metal & Steel, Stainless, General Purpose.
14" is triple reinforced

*Economical choice for standard cutting applications.



Size	RPM	Carton Qty.	SPEC	Part #
12" X 5/32 X 20mm	6,400	20	A24-R-BF	DM70220
12" X 5/32 X 1	6,400	20	A24-R-BF	DM70221
14" X 5/32 X 20mm	5,500	20	A24-R-BF TR	DM70224
14" X 5/32 X 1	5,500	20	A24-R-BF TR	DM70225

Grinding Wheels

High Performance Aluminum Oxide

33% MORE efficient than standard A.O.

Redline™ Max-A.O.™ Metal/Stainless Steel

- *Less Vibration
- *Cooler Grinding
- *Non-Loading
- *Increased Grinding Efficiency



MAX A.O. super grain is highly efficient

MAX A.O. is a hybrid grain mixture with unique crystalline properties that enable individual grain particles to remain extremely sharp and durable. The MAX A.O. grain has excellent friability characteristics that allow for optimally-timed fracturing of abrasive crystals, constantly exposing sharp cutting edges to the work surface. The result is significantly increased efficiency and performance when compared to traditional aluminum oxide wheels.

Less vibration

The MAX A.O. wheel's combination of a proprietary bonding system and the MAX A.O. grain create a wheel that offers near perfect balance, with significantly less vibration or "wheel chatter." This is extremely helpful in improving grinding efficiency and grinding speed. It is also very helpful in making the wheel user friendly, decreasing both operator fatigue and wear on the angle grinder.

Cooler grinding

Because the Redline MAX A.O. wheel runs significantly cooler than standard grinding wheels, it is ideal for applications in which burning the material can be a problem.

Non-loading

The multiple cutting edges of the MAX A.O. grain combined with the enhanced resin mixture result in stock removal rates that are significantly higher than standard grinding wheels. In addition, the constant renewal of fresh cutting edges greatly decreases wheel loading, ensuring consistent performance.

Increased grinding efficiency — **YOUR TIME IS VALUABLE!**

T-27 — 30 Degree — Stainless Steel

Size	Grit	Max RPM	Box Qty.	Part #
4" X 1/4 X 5/8	A/WA24R	13,700	25	DMDCRED40
4 1/2" X 1/4 X 7/8	A/WA24R	13,300	25	DMDCRED45
4 1/2" X 1/4 X 5/8-11	A/WA24R	13,300	10	DMDCRED45H
5" X 1/4 X 7/8	A/WA24R	12,250	25	DMDCRED50
5" X 1/4 X 5/8-11	A/WA24R	12,250	10	DMDCRED50H
6" X 1/4 X 7/8	A/WA24R	10,200	10	DMDCRED60
6" X 1/4 X 5/8-11	A/WA24R	10,200	10	DMDCRED60H
7" X 1/4 X 7/8	A/WA24S	8,500	10	DMDCRED70
7" X 1/4 X 5/8-11	A/WA24S	8,500	10	DMDCRED70H
9" X 1/4 X 7/8	A/WA24S	6,650	10	DMDCRED90
9" X 1/4 X 5/8-11	A/WA24S	6,650	10	DMDCRED90H

PIPELINE—For light grinding, cutting— T-27 — 30 Degree and 90 Degree

Size	Grit	Max RPM	Box Qty.	Part #
4 1/2" X 1/8 X 7/8	A/WA30S	13,300	25	DMDCRED45P
4 1/2" X 1/8 X 5/8-11	A/WA30S	13,300	10	DMDCRED45PH
5" X 1/8 X 7/8	A/WA30S	12,250	25	DMDCRED50P
5" X 1/8 X 5/8-11	A/WA30S	12,250	10	DMDCRED50PH
6" X 1/8 X 7/8	A/WA30R	10,200	10	DMDCRED60P
6" X 1/8 X 5/8-11	A/WA30R	10,200	10	DMDCRED60PH
7" X 1/8 X 7/8	A/WA30S	8,500	10	DMDCRED70P
7" X 1/8 X 5/8-11	A/WA30S	8,500	10	DMDCRED70PH
9" X 1/8 X 7/8	A/WA30S	6,650	10	DMDCRED90
9" X 1/8 X 5/8-11	A/WA30S	6,650	10	DMDCRED90PH

Quick Change Discs

Surface Conditioning Quick Change Discs

Perfect for blending and polishing where needed. Used in almost every shop, this versatile product is built to perform.



TYPE R						
Diameter	Type	Box Qty.	Max RPM	ACRS	AMED	AVFN
1 1/2"	R	50	30,000	62-0280	62-0284	62-0288
2"	R	50	30,000	62-0281	62-0285	62-0289
3"	R	25	20,000	62-0282	62-0286	62-0290
4"	R	10	20,000	62-0180	62-0183	62-0198

TYPE S						
Diameter	Type	Box Qty.	Max RPM	ACRS	AMED	AVFN
1 1/2"	S	50	30,000	63-0318	63-0215	63-0210
2"	S	50	30,000	63-0205	63-0208	63-0211
3"	S	25	20,000	63-0206	63-0209	63-0212
4"	S	10	20,000	63-0207	63-0328	63-0329



Aluminum Oxide 2 Ply Laminated Quick Change Discs

This is the workhorse of the product line. These AO discs are used for general purpose grinding, deburring and blending of almost any material.

TYPE R														
Diameter	Box Qty.	Max RPM	24 Grit	36 Grit	40 Grit	50 Grit	60 Grit	80 Grit	100 Grit	120 Grit	150 Grit	180 Grit	240 Grit	320 Grit
1 1/2"	100	30,000	62-0001	62-0004	62-0292	62-0293	62-0013	62-0017	62-0294	62-0024	62-0295	62-0296	62-0097	62-0098
2"	100	30,000	62-0002	62-0005	62-0009	62-0011	62-0014	62-0018	62-0021	62-0025	62-0299	62-0027	62-0030	62-0031
3"	50	30,000	62-0003	62-0006	62-0010	62-0012	62-0015	62-0019	62-0022	62-0026	62-0300	62-0028	62-0301	62-0032
TYPE S														
Diameter	Box Qty.	Max RPM	24 Grit	36 Grit	40 Grit	50 Grit	60 Grit	80 Grit	100 Grit	120 Grit	150 Grit	180 Grit	240 Grit	320 Grit
1 1/2"	100	30,000	63-0315	63-0095	63-0102	63-0107	63-0112	63-0121	63-0129	63-0136	63-0142	63-0316	63-0149	63-0153
2"	100	30,000	63-0089	63-0096	63-0103	63-0108	63-0113	63-0122	63-0130	63-0137	63-0143	63-0145	63-0150	63-0317
3"	50	20,000	63-0090	63-0097	63-0104	63-0109	63-0114	63-0123	63-0131	63-0138	63-0144	63-0146	63-0151	63-0154



Quick Change Disc Holders

Complete line of Type R and Type S quick change holders for use with our disc line of products.

Diameter x Shank	Box Qty.	Max RPM	Type R Roloc Style	Type S Turn on Style
1 1/2" x 1/4"	1	30,000	75-0030	75-0064
2" x 1/4"	1	30,000	75-0031	75-0065
3" x 1/4"	1	20,000	75-0032	75-0067

Quick Change Discs



Resin Fiber Quick Change Discs

This product will provide similar performance to our resin fiber disc but with the convenience of Type R quick change. Available in AO, Zirc, Zirc with a Grinding Aid and HIGH PERFORMANCE Ceramic.



Aluminum Oxide Type R Quick Change Resin Fiber Discs

Dia.	Box Qty.	Max RPM	36 Grit	50 Grit	60 Grit	80 Grit
2"	100	30,000	62-3001	62-3002	62-3003	62-3004
3"	50	20,000	62-3008	62-3009	62-3010	62-3011



Zirconia Type R w/Grinding Aid Quick Change Resin Fiber Discs

Dia.	Box Qty.	Max RPM	36 Grit	50 Grit	60 Grit	80 Grit
2"	100	30,000	62-3029	62-3030	62-0396	62-3031
3"	50	20,000	62-3033	62-3034	62-3035	62-3036



Zirconia Type R Quick Change Resin Fiber Discs

Dia.	Box Qty.	Max RPM	36 Grit	50 Grit	60 Grit	80 Grit
2"	100	30,000	62-3015	62-3016	62-3017	62-3018
3"	50	20,000	62-3022	62-3023	62-3024	62-3025



Ceramic Type R Quick Change Resin Fiber Discs

Dia.	Box Qty.	Max RPM	24 Grit	36 Grit	50 Grit	60 Grit	80 Grit
2"	100	30,000	62-9000	62-9001	62-9002	62-9003	62-9004
3"	50	20,000	62-9005	62-9006	62-9007	62-9008	62-9009

Resin Fiber Discs

Resin Fiber Discs - Aluminum Oxide

We offer an economy and a premium version of our AO product offering. The Economy product line is a general-purpose product available at a very competitive price for cost effective stock removal. The premium product has an advanced bond system that provides a fast, cool cut and very long life.



Dia. x Arbor	Box Qty.	Grit	Economy A.O.	Premium A.O.	Dia. x Arbor	Box Qty.	Grit	Economy A.O.	Premium A.O.
4" X 5/8"	25	16	52-0007	51-0053	7" X 7/8"	25	16	52-0010	51-0003
		24	52-0030	51-0165			24	52-0033	51-0024
		36	52-0055	51-0045			36	52-0059	51-0050
		50	52-0194	51-0072			50	52-0080	51-0076
		60	52-0096	51-0087			60	52-0099	51-0091
		80	52-0117	51-0110			80	52-0120	51-0113
		100	52-0197	51-0167			100	52-0134	51-0132
		120	52-0201	51-0166			120	52-0149	51-0143
4 1/2" X 7/8"	25	16	52-0008	51-0001	9" X 7/8"	25	16	52-0011	51-0005
		24	52-0031	51-0021			24	52-0193	51-0026
		36	52-0056	51-0047			36	52-0060	51-0052
		50	52-0078	51-0073			50	52-0195	51-0084
		60	52-0097	51-0088			60	52-0095	51-0093
		80	52-0118	51-0111			80	52-0121	51-0115
		100	52-0198	51-0130			100	52-0200	51-0133
		120	52-0147	51-0141			120	52-0150	51-0145
5" X 7/8"	25	16	52-0009	51-0002					
		24	52-0032	51-0022					
		36	52-0058	51-0048					
		50	52-0079	51-0074					
		60	52-0098	51-0089					
		80	52-0119	51-0112					
		100	52-0199	51-0131					
		120	52-0148	51-0142					

5/8-11 quick lock hubs are available on all discs.

Resin Fiber Discs

Resin Fiber Discs—Zirconia

Our standard discs remain the same product we have relied on for years. We added a new level of performance with our Premium Zirconia product. This product is 100% Zirconia and has a top coat for cool grinding action. This product will deliver the ultimate in grinding performance.



Dia. x Arbor	Box Qty.	Grit	Standard Zirconia	Premium Zirconia
4" X 5/8"	25	16	56-0064	-
		24	56-0051	-
		36	56-0013	-
		50	56-0023	-
		60	56-0031	-
		80	56-0038	-
4 1/2" X 7/8"	25	16	56-0065	-
		24	56-0003	-
		36	56-0014	56-5002
		50	56-0024	56-5003
		60	56-0032	56-5004
		80	56-0039	56-5005
5" X 7/8"	25	16	56-0056	-
		24	56-0004	-
		36	56-0015	56-5012
		50	56-0025	56-5013
		60	56-0033	56-5014
		80	56-0040	56-5015

Dia. x Arbor	Box Qty.	Grit	Standard Zirconia	Premium Zirconia
7" X 7/8"	25	16	56-0055	-
		24	56-0006	-
		36	56-0017	56-5022
		50	56-0027	56-5023
		60	56-0035	56-5024
		80	56-0041	56-5025
9" X 7/8"	25	16	56-0066	-
		24	56-0008	-
		36	56-0019	-
		50	56-0052	-
		60	56-0037	-
		80	56-0053	-

Resin Fiber Discs—Ceramic

Advances in technology are changing the design and performance of ceramic products every day. We are replacing our prior products with the latest and best performing product to best serve our customers. Our new ceramic grain product is built with a very fine crystalline structure providing significantly improved self-sharpening effect. For the fastest cutting speeds with excellent metal removal rates combined with a top size that not only keeps the grind area cooler, but also resists loading.



Dia. x Arbor	Box Qty.	Grit	Premium Ceramic
4 1/2" X 7/8"	25	24	60-5041
		36	60-5042
		50	60-5043
		60	60-5044
		80	60-5045
		100	60-5046
		120	60-5047
5" X 7/8"	25	24	60-5051
		36	60-5052
		50	60-5053
		60	60-5054
		80	60-5055
		100	60-5056
		120	60-5057

Dia. x Arbor	Box Qty.	Grit	Premium Ceramic
7" X 7/8"	25	24	60-5061
		36	60-5062
		50	60-5063
		60	60-5064
		80	60-5065
		100	60-5066
		120	60-5067

High Density Flap Discs

Maxidisc™ EXV Zirconia High Density has 35% More Abrasive Material than the Standard EXV™ Maxidisc™



Pearl's EXV™ Zirconia Maxidisc™ is an ideal combination of performance and value. It is engineered with zirconia grains on a heavy duty coated abrasive cloth. The EXV™ Maxidisc™ is designed for grinding, blending and finishing on a wide range of metal and stainless steel applications.

- Excellent price + Performance value!
- Medium to heavy stock removal on metals
- Blending and intermediate finishing of metal surfaces
- Weld bead removal
- Paint removal
- Base preparation for steel frame structures
- Deburring and corner removal
- Grinding, blending and finishing of stainless steel

APPLICATIONS: For Metal and Stainless Steel.

TYPE 27

Part #	Diameter	Arbor	Grit	MAX RPM
DMMAX4536ZJE	4 1/2"	7/8"	Z36	13,300
DMMAX4536ZJEH	4 1/2"	5/8-11"	Z36	13,300
DMMAX4540ZJE	4 1/2"	7/8"	Z40	13,300
DMMAX454ZJEH	4 1/2"	5/8-11"	Z40	13,300
DMMAX4560ZJE	4 1/2"	7/8"	Z60	13,300
DMMAX456ZJEH	4 1/2"	5/8-11"	Z60	13,300
DMMAX4580ZJE	4 1/2"	7/8"	Z80	13,300
DMMAX458ZJEH	4 1/2"	5/8-11"	Z80	13,300
DMMAX5040ZJE	5"	7/8"	Z40	12,200
DMMAX504ZJEH	5"	5/8-11"	Z40	12,200
DMMAX506ZJE	5"	7/8"	Z60	12,200
DMMAX5060ZJEH	5"	5/8-11"	Z60	12,200

TYPE 29

Part #	Diameter	Arbor	Grit	MAX RPM
DMMAX4540ZJ9E	4 1/2"	7/8"	Z40	13,300
DMMAX4560ZJ9E	4 1/2"	7/8"	Z60	13,300
DMMAX4580ZJ9E	4 1/2"	7/8"	Z80	13,300
DMMAX5040ZJ9E	5"	7/8"	Z40	12,200
DMMAX5060ZJ9E	5"	7/8"	Z60	12,200

DuraMax Standard Flap Discs

Z-Poly Cotton (PC) DuraMax Flap Discs

- Special optimized resin bond offers maximum cutting capacity, strong edge stability and long life.
- Quality Zirconia grain with a poly/cotton heat treated backing. The poly/cotton combination provides low stretch and strength.

APPLICATIONS: For Steel and Stainless



TYPE 27

Part #	Diameter	Arbor	Grit	MAX RPM
DM41701	4 1/2"	7/8"	36	13,300
DM41702	4 1/2"	7/8"	40	13,300
DM41704	4 1/2"	7/8"	60	13,300
DM41705	4 1/2"	7/8"	80	13,300
DM41706	4 1/2"	7/8"	120	13,300
DM41711	4 1/2"	5/8-11"	36	13,300
DM41712	4 1/2"	5/8-11"	40	13,300
DM41714	4 1/2"	5/8-11"	60	13,300
DM41715	4 1/2"	5/8-11"	80	13,300
DM41716	4 1/2"	5/8-11"	120	13,300
DM41941	7"	7/8"	36	8,600
DM41942	7"	7/8"	40	8,600
DM41944	7"	7/8"	60	8,600
DM41945	7"	7/8"	80	8,600
DM41951	7"	5/8-11"	36	8,600
DM41952	7"	5/8-11"	40	8,600
DM41954	7"	5/8-11"	60	8,600
DM41955	7"	5/8-11"	80	8,600

TYPE 29

Part #	Diameter	Arbor	Grit	MAX RPM
DM41721	4 1/2"	7/8"	36	13,300
DM41722	4 1/2"	7/8"	40	13,300
DM41724	4 1/2"	7/8"	60	13,300
DM41725	4 1/2"	7/8"	80	13,300
DM41726	4 1/2"	7/8"	120	13,300
DM41731	4 1/2"	5/8-11"	36	13,300
DM41732	4 1/2"	5/8-11"	40	13,300
DM41734	4 1/2"	5/8-11"	60	13,300
DM41735	4 1/2"	5/8-11"	80	13,300
DM41736	4 1/2"	5/8-11"	120	13,300
DM41802	5"	7/8"	40	12,200
DM41804	5"	7/8"	60	12,200
DM41805	5"	7/8"	80	12,200
DM41806	5"	7/8"	120	12,200
DM41812	5"	5/8-11"	40	12,200
DM41814	5"	5/8-11"	60	12,200
DM41815	5"	5/8-11"	80	12,200
DM41816	5"	5/8-11"	120	12,200
DM41961	7"	7/8"	36	8,600
DM41962	7"	7/8"	40	8,600
DM41964	7"	7/8"	60	8,600
DM41965	7"	7/8"	80	8,600
DM41971	7"	5/8-11"	36	8,600
DM41972	7"	5/8-11"	40	8,600
DM41974	7"	5/8-11"	60	8,600
DM41975	7"	5/8-11"	80	8,600



Stringer Bead Brushes

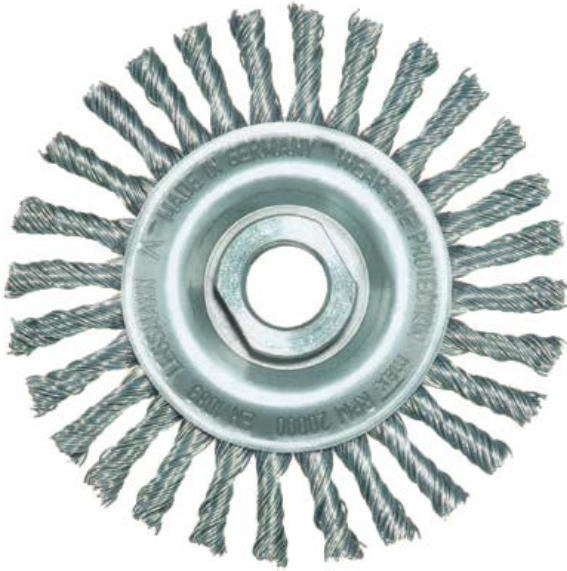

- * For professional use on "U" and "V" welds in the pipeline industry
- * Working width 1/4"
- * Both Steel and Stainless Steel available
- * Available with thread or bore
- * Quiet running and long lifetime

DIAMETER x WIRE GAUGE x MOUNT	Material	Max RPM	Box Qty.	Part #
4" x .020" x 5/8-11 Arbor	Carbon Steel	20,000	5	LB471208
4" x .020" x 5/8-11 Arbor	Stainless Steel	20,000	5	LB471808
4" x .020" x 5/8-11 Arbor	Carbon Steel 28 Knot w/o Rosebud Twist	20,000	10	LB47120828
4" x .020" x 5/8-11 Arbor	Carbon Steel 32 Knot w/o Rosebud Twist	20,000	10	LB47120832
4" x .020" x 5/8-11 Arbor	Stainless Steel 28 Knot w/o Rosebud Twist	20,000	10	LB47180828
4 1/2" x .020" x 5/8-11 Arbor	Carbon Steel	15,000	5	LB472208
4 1/2" x .020" x 5/8-11 Arbor	Stainless Steel	15,000	5	LB472808
5" x .020" x 5/8-11 Arbor	Carbon Steel	12,500	5	LB473208
5" x .020" x 5/8-11 Arbor	Stainless Steel	12,500	5	LB473808
6" x .020" x 5/8-11 Arbor	Carbon Steel	12,500	5	LB474208
6" x .020" x 5/8-11 Arbor	Carbon Steel 48 Knot w/o Rosebud Twist	12,500	5	LB47420848
6" x .020" x 5/8-11 Arbor	Stainless Steel	12,500	5	LB474808
6" x .020" x 5/8-11 Arbor	Stainless Steel 48 Knot w/o Rosebud Twist	12,500	5	LB47480848
7" x .020" x 5/8-11 Arbor	Carbon Steel	12,500	5	LB475208
7" x .020" x 5/8-11 Arbor	Stainless Steel	12,500	5	LB475808
7" x .020" x 5/8-11 Arbor	Carbon Steel 56 Knot w/o Rosebud Twist	12,500	5	LB47520856
7" x .020" x 5/8-11 Arbor	Stainless Steel 56 Knot w/o Rosebud Twist	12,500	5	LB47580856

Knot Wheel Brushes



- * Ideal for cleaning weld seams
- * Removes scale, rust, paint or slag
- * For use with angle grinders
- * Steel and stainless steel available
- * Available with thread or bore
- * Quiet running and long lifetime

DIAMETER x WIRE GAUGE x MOUNT	Material	Max RPM	Box Qty.	Part #
3" x .014" x 7/8" Arbor	Carbon Steel	25,000	Each	LB470111
3" x .020" x 7/8" Arbor	Carbon Steel	25,000	Each	LB470211
3" x .020" x 7/8" Arbor	Stainless Steel	25,000	Each	LB470811
4" x .014" x 7/8" Arbor	Carbon Steel	20,000	Each	LB471111
4" x .014" x 5/8-11 Arbor	Carbon Steel	20,000	Each	LB471118
4" x .020" x 7/8" Arbor	Carbon Steel	20,000	Each	LB471211
4" x .020" x 5/8-11 Arbor	Carbon Steel	20,000	Each	LB471218
4" x .020" x 7/8" Arbor	Stainless Steel	20,000	Each	LB471811
4" x .020" x 5/8-11 Arbor	Stainless Steel	20,000	Each	LB471818
4 1/2" x .020" x 5/8-11 Arbor	Carbon Steel	15,000	Each	LB472218
4 1/2" x .020" x 5/8-11 Arbor	Stainless Steel	15,000	Each	LB472818
6" x .020" x 7/8" Arbor	Carbon Steel	9,000	Each	LB474211
6" x .020" x 5/8-11 Arbor	Carbon Steel	9,000	Each	LB474218
6" x .020" x 7/8" Arbor	Stainless Steel	9,000	Each	LB474811
6" x .020" x 5/8-11 Arbor	Stainless Steel	9,000	Each	LB474818
6" x .025" x 5/8-11 Arbor	Carbon Steel	9,000	Each	LB474918
7" x .020" x 5/8-11 Arbor	Carbon Steel	9,000	Each	LB475218
7" x .020" x 5/8-11 Arbor	Stainless Steel	9,000	Each	LB475818
8" x .014" x 7/8" Arbor	Carbon Steel	9,000	Each	LB476111
8" x .020" x 7/8" Arbor	Carbon Steel	9,000	Each	LB476211

Knot Cup Brushes



- * For cleaning weld seams
- * Ideal for working on large surfaces
- * For use with angle grinders
- * High tensile steel or stainless steel wire
- * Aggressive material removal
- * Long lifetime

DIAMETER x WIRE GAUGE x MOUNT	Material	Max RPM	Box Qty.	Part #
2 3/4" x .014" x 5/8-11 Arbor	Carbon Steel	14,000	Each	LB482118
2 3/4" x .014" x M10 x 1.25" Arbor	Carbon Steel	14,000	Each	LB482213
2 3/4" x .020" x 5/8-11 Arbor	Carbon Steel	14,000	Each	LB482218
2 3/4" x .020" x 5/8-11 Arbor	Stainless Steel	14,000	Each	LB482818
3 1/2" x .020" x 5/8-11 Arbor	Carbon Steel	14,000	Each	LB485238
3 1/2" x .020" x 5/8-11 Arbor	Stainless Steel	14,000	Each	LB485838
4" x .020" x 5/8-11 Arbor	Carbon Steel	9,000	Each	LB486218
4" x .020" x 5/8-11 Arbor	Stainless Steel	9,000	Each	LB486818
5" x .020" x 5/8-11 Arbor	Carbon Steel	9,000	Each	LB487318
6" x .020" x 5/8-11 Arbor	Carbon Steel	9,000	Each	LB488218
6" x .031" x 5/8-11 Arbor	Carbon Steel	9,000	Each	LB488338
6" x .020" x 5/8-11 Arbor	Stainless Steel	9,000	Each	LB488838

Crimped Cup Brushes

- * For removing rust, paint, dirt or scale on large surfaces
- * Steel, stainless steel or brass wire
- * For use with angle grinders
- * Long lifetime



DIAMETER x WIRE GAUGE x MOUNT	Material	Max RPM	Box Qty.	Part #
2 3/4" X .012" X 5/8-11 Arbor	Carbon Steel	14,000	Each	LB423168
2 3/4" x .012" x 5/8-11 Arbor	Stainless Steel	14,000	Each	LB423368
3 1/2" x .014" x 5/8-11 Arbor	Carbon Steel	14,000	Each	LB424178
4" x .014" x 5/8-11 Arbor	Carbon Steel	14,000	Each	LB426178
4" x .012" x 5/8-11 Arbor	Stainless Steel	9,000	Each	LB426368
5" x .014" x 5/8-11 Arbor	Carbon Steel	6,500	Each	LB427178
6" x .020" x 5/8-11 Arbor	Carbon Steel	6,500	Each	LB429198
6" x .012" x 5/8-11 Arbor	Stainless Steel	6,500	Each	LB429368

Knotted End Brush



- * For cleaning weld seams
- * Ideal for working on large surfaces
- * For use with angle grinders
- * High tensile steel or stainless steel wire
- * Aggressive material removal
- * Long lifetime

DIAMETER x WIRE GAUGE	Material	Max RPM	Box Qty.	Part #
3/4" x .020"	Carbon Steel	20,000	10	LB453298
3/4" x .014"	Carbon Steel	20,000	10	LB453278
3/4" x .014"	Stainless Steel	20,000	10	LB453378
1" x .014"	Carbon Steel	20,000	10	LB454278
1" x .020"	Carbon Steel	20,000	10	LB45429
1" x .014"	Stainless Steel	20,000	10	LB454378
1 1/8" x .014"	Carbon Steel	20,000	10	LB456278
1 1/8" x .020"	Carbon Steel	20,000	10	LB456298
1 1/8" x .014"	Stainless Steel	20,000	10	LB456378

Crimped End Brushes



- * For removing rust, paint, dirt or scale on large surfaces
- * Steel, stainless steel or brass wire
- * For use with angle grinders
- * Long lifetime

DIAMETER x WIRE GAUGE	Material	Max RPM	Box Qty.	Part #
1/2" x .006"	Carbon Steel	20,000	10	LB451131
1/2" x .014"	Carbon Steel	20,000	10	LB451161
1/2" x .020"	Carbon Steel	20,000	10	LB451191
1/2" x .014"	Stainless Steel	20,000	10	LB451361
3/4" x .006"	Carbon Steel	20,000	10	LB452131
3/4" x .012"	Carbon Steel	20,000	10	LB452161
3/4" x .020"	Carbon Steel	20,000	10	LB452191
3/4" x .014"	Stainless Steel	20,000	10	LB452361
1" x .006"	Carbon Steel	20,000	10	LB453131
1" x .014"	Carbon Steel	20,000	10	LB453161
1" x .020"	Carbon Steel	20,000	10	LB453791
1" x .014"	Stainless Steel	20,000	10	LB453361
1 1/8" x .014"	Carbon Steel	20,000	10	LB456161
1 1/8" x .020"	Carbon Steel	20,000	10	LB456191
1 1/8" x .014"	Stainless Steel	20,000	10	LB456361

Band Saw Blades

- Top quality, made in Germany
- Long blade life
- Economical

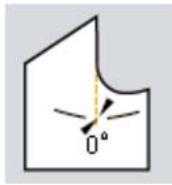
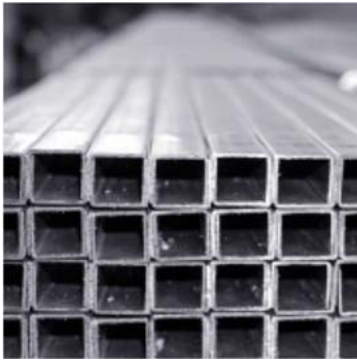

Engineered for:
 Structurals with light or medium walls
 Short chipping materials
 Sheet metal on vertical band saw machines

M42 SPRINT
 The structural professional for light
 and medium wall thicknesses.

Dimensions		Tooth					
mm	inch	3/4	4/6	5/8	6/10	8/12	10/14
6 x 0.90	1/4 x .035						K
10 x 0.90	3/8 x .035						K
13 x 0.65	1/2 x .025			K	K	K	K
13 x 0.90	1/2 x .035				K	K	K
20 x 0.90	3/4 x .035		K	K	K	K	K
27 x 0.90	1 x .035	K	K	K	K	K	K
34 x 1.10	1 1/4 x .042	K	K	K	K	K	
41 x 1.30	1 1/2 x .050	K	K	K	K		
54 x 1.60	2 x .063		K*	K*			
		K=Variable Tooth		*=Special Item			

The variable tooth with 0° rake angle with a special group-set cuts even lightest sections with less vibrations. Short chipping materials are cut without problem.

Band Saw Blades

M42 SPRINT-MEDIUM-VS
The multi-purpose blade for various profile cutting applications.

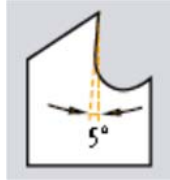

Engineered for:
Structural and beams
Also for solid materials as part of a mix of materials
Small and medium scissor-arm machines

Dimensions		Tooth				
mm	inch	2/3	3/4	4/6	5/7	8/11
20 x 0.90	3/4 x .035					K-V
27 x 0.90	1 x .035		K-V	K-V	K-V	K-V
34 x 1.10	1 1/4 x .042	K-V	K-V	K-V	K-V	
41 x 1.30	1 1/2 x .050	K-V	K-V	K-V		
54 x 1.30	2 x .050		K-V			
54 x 1.60	2 x .063	K-V	K-V	K-V		
67 x 1.60	2 5/8 x .063	K-V	K-V			

K-V= Reinforced variable tooth

The new designed special HL variable tooth with a slightly positive rake angle combined with a special group set controls the chipping on lighter general purpose machines, increases blade life and grants smoothest cut surfaces.

M42 SPRINT-PLUS
Perfect for materials of medium and large dimensions.

Engineered for:
Production band saw machines
All-purpose use for steels and non-ferrous steels
Tensile strengths of up to 1400 N/mm²
Thick walled structurals

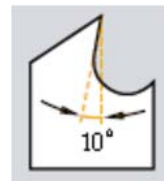

Dimensions		Tooth				
mm	inch	.075/1.25	1.4/2	2/3	3/4	4/6
20 x 0.90	3/4 x .035					K
27 x 0.90	1 x .035			K	K	K
34 x 1.10	1 1/4 x .042		K	K	K	K
41 x 1.30	1 1/2 x .050		K	K	K	K
54 x 1.30	2 x .050		K	K	K	K
54 x 1.60	2 x .063	K	K	K	K	K
67 x 1.60	2 5/8 x .063	K	K	K		
80 x 1.60	3 x .063	K	K			

K=Variable Tooth

The variable tooth with a positive rake angle with a special group-set cuts solid materials as well as heavy wall structurals and tubing at fast cutting rates, with a smooth surface.

Band Saw Blades

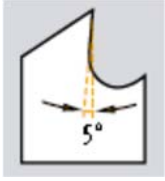

M42 PROFILER-SPRINT-VS Robust performance with steel construction

Engineered for:
Large cross-section steel beams
Structurals with residual stress



Dimensions		Tooth		
mm	inch	2/3	3/4	4/6
34 x 1.10	1 1/4 x .042		K-V	K-V
41 x 1.30	1 1/2 x .050	K-V	K-V	K-V
54 x 1.60	2 x .063	K-V	K-V	
67 x 1.60	2 5/8 x .063	K-V	K-V	
K-V= Reinforced variable tooth with wide setting				

The variable tooth with slightly positive rake angle and extra heavy group-set shows excellent performance on H-beams and similar shapes. The Profiler-Sprint-VS avoids blade pinching in beams with inside tension, or in poorly supported profiles. For 90° and miter cutting.

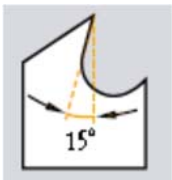

M51 SPRINT-PLUS Wear resistant teeth for difficult to cut materials of medium dimensions

Engineered for:
Hard and tough materials up to 1700 N/mm² tensile strength
Stainless Steel
Nickel based alloys/Titanium and special bronzes
Thick walled structurals



Dimensions		Tooth		
mm	inch	2/3	3/4	4/6
27 x 0.90	1 x .035	K	K	K
34 x 1.10	1 1/4 x .042	K	K	K
41 x 1.30	1 1/2 x .050	K	K	
54 x 1.60	2 x .063	K		
67 x 1.60	2 5/8 x .063	K		
K= Variable Tooth				

The extremely positive variable tooth with special strong tooth forms. High heat and wear resistance of HSS M51 tooth tips increases band life on all hard and problematic steels.

Band Saw Blades

M51 BLIZZARD-SPRINT

For extra wear resistant cutting, made of powder metallurgical hardened steel for large cross sections and demanding alloys.



Engineered for:
 Steels of the highest tensile strength
 Long chipping materials
 Stainless Steel
 Titanium based alloys/nickel based alloys
 Special bronzes

Dimensions		Tooth			
mm	inch	0.75/1.25	1/1.3	1/1.5	1.4/2
41 x 1.30	1 1/2 x .050				K
54 x 1.60	2 x .063			K	K
67 x 1.60	2 5/8 x .063	K	K		K
80 x 1.60	3 x .063	K	K		K*
K= Variable tooth with special geometry		*= Special item			

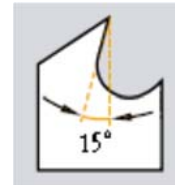

The precisely produced teeth in combination with an optimum hardness of tooth tips of 68-69 HRC. Extreme positive rake angle together with variable group set lead to smooth and perfect cutting surface. Short cutting times and outstanding blade life are the benefits from BLIZZARD-SPRINT.

Why is Bi-Metal so successful?

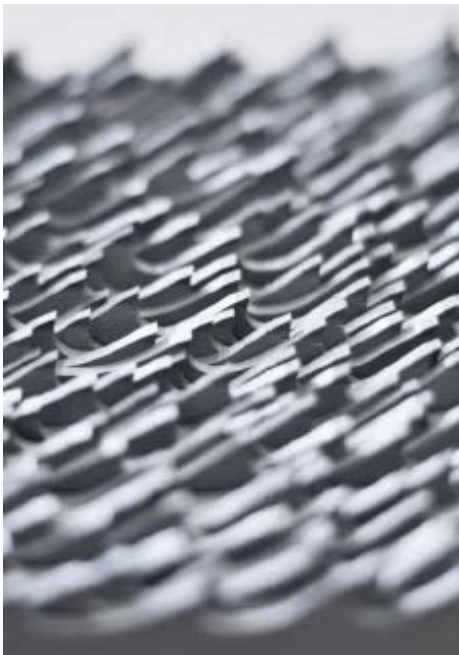

M42

Material no. 1.3247 hardness approx. 68 - 69 HRC

M51

Material no. 1.3207 hardness approx. 69 HRC, with high tungsten and cobalt content.

ALL ADVANTAGES:

The high quality Bi-Metal band combines the flexibility of the spring steel backing with the enormous wear resistance of high speed steel. Each tooth tip of the finished band is of hardened HSS-steel, extremely durable for best performance.

FLEXIBLE:

The blade backer of our Bi-Metal Band Saw Blade consists of a special alloyed spring steel. Highly flexible at a hardness of about 50 HRC. The ideal basis for long fatigue life and excellent cutting performance.

PERFECTLY JOINT:

Both materials are undetachably welded together by special electron or laser beam.

Scratch Brushes

Product Description	Box Qty.	Part #
Long Handle Carbon Steel 1" x 14" - 3 x 19 rows	12	WBH3
Long Handle Stainless Steel 1" x 14" - 3 x 19 rows	12	WBH3SS
Shoe Handle Carbon Steel 1" x 10" - 3 x 17 rows	12	WBSH15
Shoe Handle Stainless Steel 1" x 10" - 3 x 17 rows	12	WBSH15SS
Acid Brush 6" x 1/2" - #2	12	WBACID2
Brush for CHDUAL - Carbon .9" x 4.75" - 3 x 15 rows	12	WBCH
Toothbrush Stainless Steel .25" x 7.75" - 3 x 7 rows	12	WBTBSS



Brush 3 x 15 rows



Long handle 3 x 19 rows



Toothbrush 3 x 7 rows



Shoe Handle 3 x 17 rows



Acid Brush

CHEMICALS



“In today’s highly competitive business of welding and fabrication, you must constantly seek and maintain the most cost effective way to run your business. DuraMax and their extremely knowledgeable sales group, have consistently provided us with the highest quality, most cost effective welding supplies and solutions to keep us ahead of our competition.”

**— Mark M.
Welding and Fabrication Division Manager**

CHEMICALS

ANTI-SPATTER

Solvent Based Formula

Provides protection to MIG gun nozzles, contact tips, accessories and all weld zones during single and multi-pass welding. Provides weld prep protection on parts to be stored. Requires little cleaning prior to painting when applied properly. Liquid may be applied by brush or roller.

Available in the following:

DM200-16: Aerosol (DMANTISPAT)
DM200-20: Aerosol
DM200-5: 5 Gallon Pail
DM200-55: 55 Gallon Drum



SPRAYGALV BRIGHT FINISH

Aluminized Metallic Zinc Coating

Produces sacrificial protection that stops rust and corrosion on all metal surfaces. Any deterioration leads to rust and/or corrosion of the coating rather than the metal surface. Equivalent to hot dip galvanizing in cathodic protection and film durability and protects against caustic action salt spray. Resists peeling, blistering, rust, weather, gasoline and oil. Compounded from metallic zinc and aluminum dust. Leaves a bright finish.

DM305-16: Aerosol (DMBRIGHTGALV)
DM305-6X1: 6 x 1 Quart Case
DM305-2X1: 2 x 1 Gallon Case

OTHER CHEMICALS ARE AVAILABLE—PLEASE ASK YOUR SALES PRO FOR DETAILS

TOOLS AND ACCESSORIES



Product Details:
Single flint striker
Consistent, reliable sparking
Long lasting

Part # DM3001



Product Details:
Single flint renewals
Economically priced
Guaranteed to fit perfectly
Guaranteed to remain seated in the flint holder
Larger size for longer life

Part # DM3001X



Product Details:
Triple flint striker is perfect for camping trips, bunsen burners, welding torches, and gas appliances. Excellent spark torch lighter to safely ignite flames under all working conditions. Zinc-plated construction for rust prevention and corrosion.

Part # DM4501



Product Details:
Triple flint renewals
Economically priced
Guaranteed to fit perfectly
Guaranteed to remain seated in the triple flint holder
Larger size for longer life

Part # DM5003X



Product Details:
MIG Reamer

Handy welding nozzle cleaning tool. Just insert the hardened steel blades into a spatter clogged torch nozzle and twist. The blades cut away the built up spatter inside the nozzle helping to prolong life and providing even shield gas distribution for superior quality welds. After reaming apply anti-spatter spray or gel. Adjustable blades clean nozzles from 3/8" to 3/4" bore.

Part # DMMIGREAMER

TOOLS AND ACCESSORIES



Product Details:

Standard Tip Cleaner

Attractive aluminum case with a contained spool assembly
Smooth leader pilot
Tangle-free closed loops
Tapered ends allows smooth easy entry without scratching
Uniform ridges wipe and polish the orifice wall
Size Group 6 - 26
Material Stainless Steel
Includes (13) Cleaners, File

Part # DMTIPCLEANERSP-1



Product Details:

Master Tip Cleaner

Attractive aluminum case with a contained spool assembly
Smooth leader pilot
Tangle-free closed loops
Tapered ends allows smooth easy entry without scratching
Uniform ridges wipe and polish the orifice wall
Size Group 6 - 45
Material Stainless Steel
Includes (22) Cleaners, File

Part # DMMASTERSP-2



Product Details:

Weld Fillet Gauge

Quick and accurate measuring
Stainless steel

Part # DMWG-11

TOOLS AND ACCESSORIES



Product Details:

Chipping Hammer Steel Cone And Chisel Head

Hammer heads are hardened to precisely controlled temperatures for durability and strength.

Drop forged, heat-treated hardened head withstands more grinds.

Wide-blade design removes slag faster and adds to the life of the tool.

Welded-on-head to steel shaft prevents head from coming loose.

Well-balanced handle grip for comfort and ease-of-use.

Part # DMCHRLH1S



Product Details:

MIG Welding Pliers

Strong, sharp welding pliers is a "must" tool for MIG welding operations

Multipurpose tool with 8 functions (pictured below) resulting in more efficient time and production

Durable carbon steel construction paired with an easy to use spring operated handle

Part # MIGWELPER

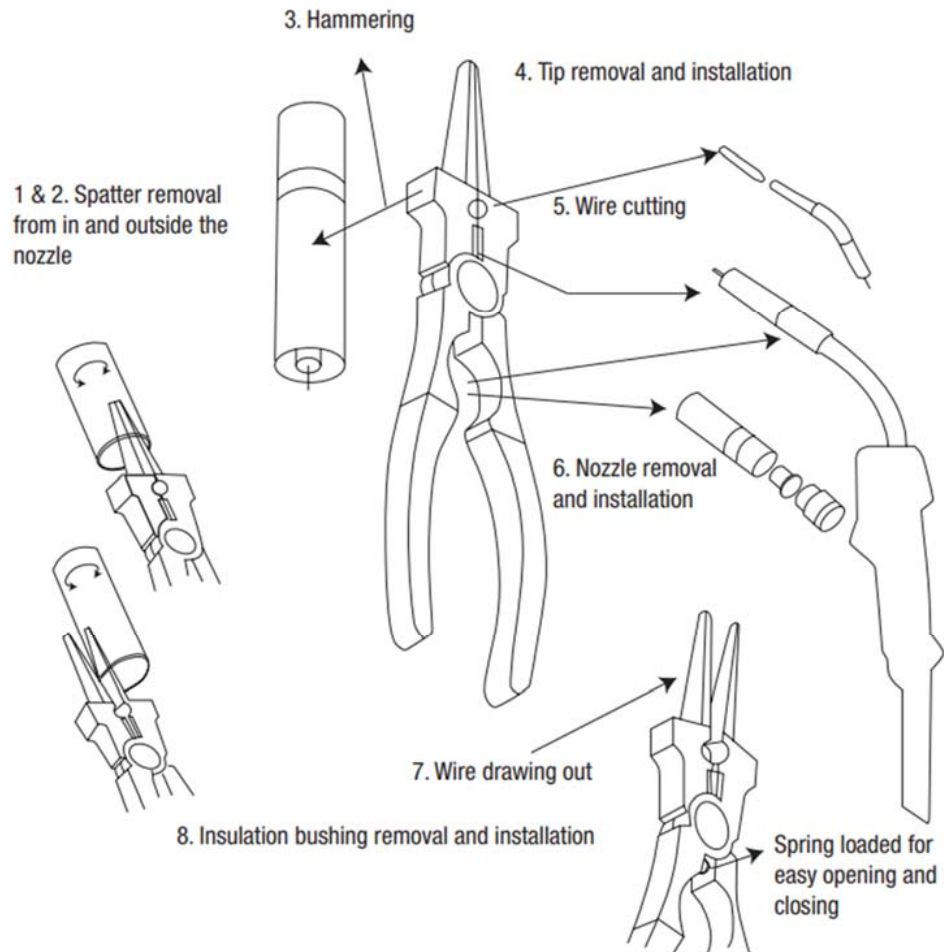

TOOLS AND ACCESSORIES

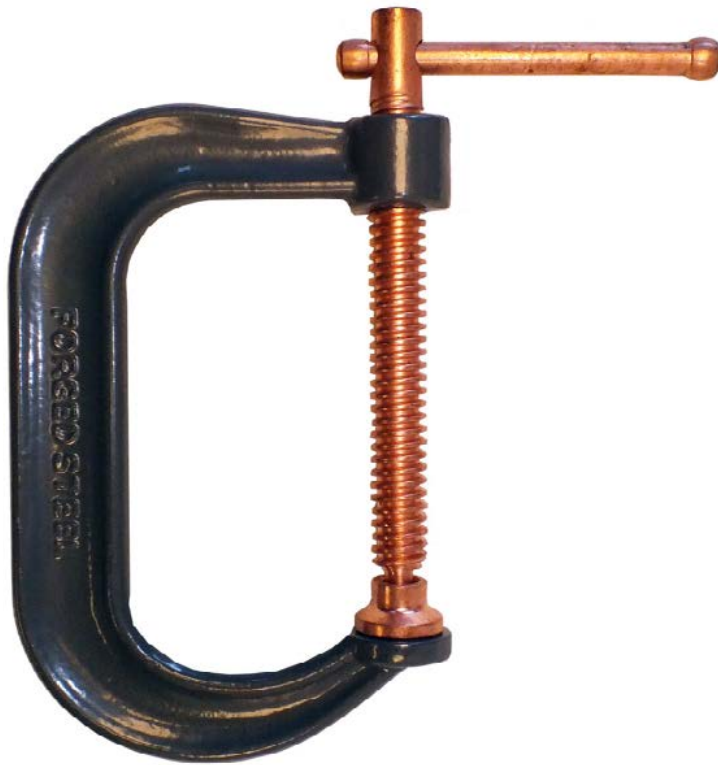

- Heavy Duty Casted C-Clamp
- Anti-Slip Protection Features Included In Even Base Models
- Copper Plated Spindle for spark protection

Description	Clamping Capacity inches (mm)	Clamping Pressure lbs (ksi)	Throat Depth inches (mm)	Pad	Part #
C-Clamp Steel Drop Forged 4 inch	4" (102)	6200 (2812)	2.7" (69)	Heavy	DMN1DF4
C-Clamp Steel Drop Forged 6 inch	6" (152)	6900 (3130)	3.6" (91)	Heavy	DMN1DF6
C-Clamp Steel Drop Forged 8 inch	8" (203)	6900 (3130)	4.5" (114)	Heavy	DMN1DF8
C-Clamp Steel Drop Forged 12 inch	12" (305)	9300 (4218)	5.7" (145)	Heavy	DMN1DF12

TOOLS AND ACCESSORIES



When you need to clamp over small obstructions, J-clamps can eliminate the need for blocking. These are available in three sizes.

- Special "J" shaped frame is designed to "Step Over" obstructions
- Specially hardened spindle resists weld spatter
- Sliding T-bar handle

Description	Clamping Capacity inches (mm)	Clamping Pressure lbs (ksi)	Throat Depth inches (mm)	Pad	Rail Size (mm)	Part #
J-Clamp Steel 12" 3 pc. Swivel Pad 2400 psi	12" (305)	2400 (1100)	5.5" (140)	Heavy	30 x 14	DMN1240012J
J-Clamp Steel 16" 3 pc. Swivel Pad 2400 psi	16" (408)	2400 (1100)	5.5" (140)	Heavy	30 x 14	DMN1240016J
J-Clamp Steel 20" 3 pc. Swivel Pad 2400 psi	20" (508)	2400 (1100)	5.5" (140)	Heavy	30 x 14	DMN1240020J

TOOLS AND ACCESSORIES



F-Clamps offer a profiled rail and spatter resistant spindle.

- The Clamp bar is made of high quality heat-treated steel and plated for strength and durability.
- The sliding arm is made from tempered, drop-forged steel for longer service life and is removable and reversible to convert the holding clamp to a spreader bar.



Description	Clamping Capacity inches (mm)	Clamping Pressure lbs (ksi)	Throat Depth inches (mm)	Pad	Rail Size (mm)	Part #
F-Clamp Steel 4" Swivel Pad 600 psi	4" (51)	600 (227)	3.2" (83)	Standard	16 x 8	N160004
F-Clamp Steel 6" Swivel Pad 600 psi	6" (152)	600 (227)	3.2" (83)	Standard	16 x 8	N160006
F-Clamp Steel 8" Swivel Pad 600 psi	8" (203)	600 (227)	3.2" (83)	Standard	16 x 8	N160008
F-Clamp Steel 12" Swivel Pad 600 psi	12" (305)	600 (227)	3.2" (83)	Standard	16 x 8	N160012
F-Clamp Steel 8" 3 pc Swivel Pad 1200 psi	8" (203)	1200 (550)	4.7" (120)	Heavy	26 x 12	N1120008
F-Clamp Steel 12" 3 pc Swivel Pad 1200 psi	12" (305)	1200 (550)	4.7" (120)	Heavy	26 x 12	N1120012
F-Clamp Steel 16" 3 pc Swivel Pad 1200 psi	16" (406)	1200 (550)	4.7" (120)	Heavy	26 x 12	N1120016
F-Clamp Steel 24" 3 pc Swivel Pad 1200 psi	24" (610)	1200 (550)	4.7" (120)	Heavy	26 x 12	N1120024
F-Clamp Steel 32" 3 pc Swivel Pad 1200 psi	32" (812)	1200 (550)	4.7" (120)	Heavy	26 x 12	N1120032
F-Clamp Steel 8" 3 pc Swivel Pad 2400 psi	8" (203)	2400 (1100)	5.5" (140)	Heavy	30 x 14	N124008*
F-Clamp Steel 12" 3 pc Swivel Pad 2400 psi	12" (305)	2400 (1100)	5.5" (140)	Heavy	30 x 14	N1240012*
F-Clamp Steel 12" 3 pc Pad - Deep Throat	12" (305)	2400 (1100)	5.5" (140)	Heavy	30 x 14	N1240012D
F-Clamp Steel 16" 3 pc Swivel Pad 2400 psi	16" (406)	2400 (1100)	5.5" (140)	Heavy	30 x 14	N1240016*
F-Clamp Steel 16" 3 pc Pad - Deep Throat	16" (406)	2400 (1100)	5.5" (140)	Heavy	30 x 14	N1240016D
F-Clamp Steel 20" 3 pc Swivel Pad 2400 psi	20" (508)	2400 (1100)	5.5" (140)	Heavy	30 x 14	N1240020*
F-Clamp Steel 24" 3 pc Swivel Pad 2400 psi	24" (610)	2400 (1100)	5.5" (140)	Heavy	30 x 14	N1240024"
F-Clamp Steel 24" 3 pc Pad - Deep Throat	24" (610)	2400 (1100)	5.5" (140)	Heavy	30 x 14	N1240024D
F-Clamp Steel 32" 3 pc Swivel Pad 2400 psi	32" (812)	2400 (1100)	5.5" (140)	Heavy	30 x 14	N1240032*
F-Clamp Steel 48" 3 pc Swivel Pad 2400 psi	48" (1219)	2400 (1100)	5.5" (140)	Heavy	30 x 14	N1240048*
F-Clamp Steel 12" 3 pc Swivel Pad 4800 psi	12" (305)	4800 (2200)	7" (178)	Heavy	42 x 19	N1480012*
F-Clamp Steel 16" 3 pc Swivel Pad 4800 psi	16" (406)	4800 (2200)	7" (178)	Heavy	42 x 19	N1480016*
F-Clamp Steel 24" 3 pc Swivel Pad 4800 psi	24" (610)	4800 (2200)	7" (178)	Heavy	42 x 19	N1480024*
F-Clamp Steel 32" 3 pc Swivel Pad 4800 psi	32" (812)	4800 (2200)	7" (178)	Heavy	42 x 19	N1480032*
F-Clamp Steel 48" 3 pc Swivel Pad 4800 psi	48" (1219)	4800 (2200)	7" (178)	Heavy	42 x 19	N1480048*

***Clamps available with V-Pad included. Just add "V" at the end of the part number where needed.**

TOOLS AND ACCESSORIES



Product Details:

Flat Soapstone
5 x 1/2 x 3/16"
144 pc per box=Gross

Part # DMSSFLAT

Product Details:

Flat Soapstone Holder 5.5" long
(Includes 1 pc of soapstone)

Part # DMSSHOLDERFLAT



Product Details:

For use in welding applications, these round soapstones help to produce highly visible layout lines on metal or concrete.
1/4 x 5"
144 pc per box=Gross

Part # DMSSROUND



Product Details:

Round Soapstone Holder 5 x 1/4"

Part # DMSSHOLDERROUND

TOOLS AND ACCESSORIES



Brass Pressure Gauge 1.5" - Dual Scale (kPa/psi) - Side Entry - 1/8" Brass Inlet		
30 PSI	Blister Pack	PG150030BP
100 PSI	Blister Pack	PG150100BP
200 PSI	Blister Pack	PG150200BP
400 PSI	Blister Pack	PG150400BP
4000 PSI	Blister Pack	PG154000BP
Plastic Gauge Cover	Each	PG15PC
Brass Pressure Gauge 2" - Dual Scale (kPa/psi) - Side Entry - 1/4" Brass Inlet		
30 PSI	Blister Pack	PG200030BP
100 PSI	Blister Pack	PG200100BP
200 PSI	Blister Pack	PG200200BP
400 PSI	Blister Pack	PG200400BP
4000 PSI	Blister Pack	PG204000BP
Plastic Gauge Cover	Each	PG20PC
Brass Pressure Gauge 2.5" - Dual Scale (kPa/psi) - Side Entry - 1/4" Brass Inlet		
30 PSI	Blister Pack	PG250030BP
100 PSI	Blister Pack	PG250100BP
200 PSI	Blister Pack	PG250200BP
400 PSI	Blister Pack	PG250400BP
4000 PSI	Blister Pack	PG254000BP
Plastic Gauge Cover	Each	PG25PC



Product Details:

Heavy duty Argon Flowmeter Regulator
Is ideal for TIG and MIG welding applications where more precise control of the shielding gas flow is desired. The compact design is a single-stage, solid brass model that is specifically designed for argon and argon mix shielding gases. It comes with a calibrated flow tube that is marked for both Argon and CO2 flow rates. CGA 580

Part # DMN302014

TOOLS AND ACCESSORIES



**MEDIUM DUTY REGULATOR, STYLE 350
OXYGEN**

Designed for medium capacity applications. Single stage design brass body. Delivery pressure maximum 200 psi, outlet connection B. Maximum inlet 3000 psi. Inlet connection CGA 540

Part # DMN302005



**MEDIUM DUTY REGULATOR, STYLE 350
ACETYLENE**

Designed for medium capacity applications. Single stage design brass body. Delivery pressure maximum 30 psi, outlet connection B. Maximum inlet 300 psi. Inlet connection CGA 510 or CGA 300

**Part # DMN302003 (CGA 300)
DMN302004 (CGA 510)**



**HEAVY DUTY REGULATOR, STYLE 450
OXYGEN**

Designed for high capacity applications. Single stage design brass body. Delivery pressure maximum 200 psi, outlet connection B. Maximum inlet 3000 psi. In-let connection CGA 540

Part # DMN302008



**HEAVY DUTY REGULATOR, STYLE 450
ACETYLENE**

Designed for high capacity applications. Single stage design brass body. Delivery pressure maximum 30 psi, outlet connection B. Maximum inlet 300 psi. Inlet connection CGA 510 or CGA 300

**Part # DMN302006 (CGA 300)
DMN302007 (CGA 510)**

WELDING BLANKETS



DuraMax 18 Ounce Welding Blanket

Material: Fiberglass
Temperature Rating: 1000 Degrees Fahrenheit
Weight of Cloth: 18 OZ/YD
Thickness: .035"
Coating: Uncoated
Grommets along edges
Abrasion Resistance: Medium
Compliance: FM approved
Color: Tan
Sizes Available: 6' x 6', 6' x 8', 8' x 8', 8' x 10', 10' x 10', 12' x 12' and rolls of 60" x 50 yards

- For other sizes, please ask your Sales Pro or call our office

May protect equipment from damage caused by sparks, heat, spatter and more. Suitable for multiple welding, brazing and soldering applications.

DuraMax 24 Ounce Welding Blanket



Material: Fiberglass
Temperature Rating: 1000 Degrees Fahrenheit
Weight of Cloth: 24 OZ/YD
Thickness: .05"
Coating: Dyeing
Grommets along edges
Abrasion Resistance: Medium
Compliance: FM approved
Color: Orange
Sizes Available: 6' x 6', 6' x 8', 10' x 10' and rolls of 40" x 50 yards

- For other sizes, please ask your Sales Pro or call our office

Heat protection, distinguish work areas. May protect equipment from damage caused by sparks, heat, spatter and more. Suitable for multiple welding, brazing and soldering applications.

For other welding blankets that you may require, please call our office for details on other products that are available.

1-800-692-5930

APPLICATIONS:

**Welding & Metal Fab Shops
Power Plants
Oil Refineries
Shipbuilding & Marine Construction
Industrial Construction
Steel Building Construction
Iron Works
Pipe Fabrication Yards
Piping Insulation Jacketing**



<p>71T-1 Seismic Plus Wire Features: Superb welder appeal because of its smooth stable arc and virtually spatter free weld deposits. Very little fumes. Out of position welding made simple because of fast freezing yet easily removable slag. More time welding, less time cleaning up!</p> <p>Classification: ER71T-1C/1M, ER71T-9C/9M H8 Diameters: .030", .035" and .045" Formats: 33 Lb and 40 Lb spools, 60 Lb Coils and 550 Lb Drums</p>	PAGE 10
<p>71T-GS Self-Shielded Wire Features: A carbon steel, self shielded, flux-cored wire that produces smooth arc action, low spatter, full slag coverage, and easy slag removal. Not having to use gas makes this product extremely popular due to it's versatility and portability.</p> <p>Classification: ER71T-GS Diameters: .030", .035", .045" and .052" Formats: 2 Lb spools, 10 Lb spools, 33 Lb spools, 44 Lb spools and 550 Lb drums</p>	PAGE 11
<p>71T-11 Features: Self-shielding flux-cored wire designed for single or multi-pass welding having a smooth spray-type transfer commonly used on mild steels less than 3/4" thick. Easy general all position wire to use in the field where shielding gas is not practical. Limit to three passes will ensure properties on the mechanicals and weld deposit chemistry.</p> <p>Classification: ER71T-11 Diameters: .035", .045", .052" and 1/16 Formats: 33 Lb and 44 Lb spools and 550 Lb drums</p>	PAGE 12
<p>71T-8 H8 Features: Excellent welder appeal Increases productivity Fast-freezing slag Suitable for all-position welding Reduces clean-up time, increases productivity High impact strengths at low temperatures Resists cracking in severe applications No shielding gas required Suitable for welding outdoors</p> <p>Classification: ER71T-8 H8 Diameters: .045", .062", .068" and 5/64 Formats: 25 Lb and 44 Lb spools and 550 Lb drums</p>	PAGE 13



ALL MELTED AND MANUFACTURED IN THE U.S.A

<p>7018-H4R Low Hydrogen Electrodes Features: Welder friendly with minimum spatter. Moisture resistant and hydrogen controlled. Reduction of arc starting porosity. Clear puddle and a smooth arc. Weld metal is clean and has lowest level of impurities. No need for drying. The electrodes are vacuum packed hence can be used straight on the job. Typical Application & Usage: All maintenance applications including welding of all types of carbon-manganese steels, heavy structures, plants subjected to static or dynamic loading. These rods can be used as a buffer layer before hard facing.</p>	PAGE 15
<p>6010 is an all position, cellulosic electrode that has a quick-starting, steady, and deep penetrating arc. It produces x-ray quality welds in flat, horizontal, overhead, vertical-up, and vertical-down positions. Typical Application & Usage: Used for general-purpose fabrication, repair, maintenance welding, out-of-position x-ray welds, construction and ship building, pipe welding as well as vertical and overhead plate</p>	PAGE 16
<p>6011 is a versatile, deep penetrating, steel electrode with smooth and stable arc characteristics. The coating produces a forceful, spray-type arc, resulting in deep penetrating welds. Typical Application & Usage: Used for welding mild, galvanized and some low-alloy steels. Suited for structural, ship building and repair, rail cars, piping, pressure vessel fittings, boilers and general fabrication.</p>	PAGE 17
<p>6013 is a versatile, deep penetrating steel electrode with smooth, stable arc characteristics. It's used for the welding of mild steels, galvanized and also some low alloy steels. The coating produces a forceful, spray-type arc, resulting in deep penetrating welds. The slag is thin and easily removable. Typical Application & Usage: Vehicles, ship building and repair, sheet metal, build-up of over machined and worn mild steel surfaces, general light fabrication.</p>	PAGE 18
<p>6022 has a smooth, easy to control arc, excellent strike and re-strike, penetrating arc, low spatter and a light slag. It produces strong, reliable welds with less clean up and good bead appearance. Typical Application & Usage: Commonly referred to as the "decking rod" because it's used for welding roof decking to support beams and other similar applications where burn-through spot welds with full penetration are required. It is also designed to weld through galvanized or painted roof decking and can also be used on plated and dirty decking. This rod is an excellent choice for burn through spot welds for roof decking and sheet metal and for rapid downhill welding when joining light gauge materials.</p>	PAGE 19
<p>7014 is an all position electrode for mild and low alloy steels with an iron powder coating. The iron coating yields a high deposition rate. The welds reflect smooth beads with fine ripples. High speeds and high heats can be used without undercut. It is particularly advantageous when poor fit-up exists. The slag is easily removed, often self-lifting. Typical Application & Usage: Heavy sheet metal, frames, construction equipment, farm machinery, shelving, general maintenance and fabrication.</p>	PAGE 20
<p>7024 is a heavy iron powder coated electrode designed for high speed, single pass horizontal and flat fillet welding of mild steel. This electrode provides greater deposition efficiency and better physical properties than E7014 electrodes. E7024 offers a quiet stable arc and produces weld deposits with low spatter, free of undercuts and a "self-removing" slag. Bead appearance is superb. Excellent operator appeal. This electrode may be used with AC or DC (straight or reverse polarity). Typical Application & Usage: Ship and Barge structures, rail cars, bridges, structural steels, machine bases, truck fabrication, storage tanks and earth-moving equipment.</p>	PAGE 21



Structural Steel, Erectors and Construction Index

ABRASIVES	PAGES	85-106
ANTI-SPATTER	PAGE	108
ARGON FLOWMETER	PAGE	117
BAND SAW BLADES	PAGES	102-105
BLANKETS, WELDING 18 OUNCE TAN UNCOATED	PAGE	119
BLANKETS, WELDING 24 OUNCE ORANGE	PAGE	119
BRIGHT GALV SPRAY	PAGE	108
C-CLAMPS	PAGE	113
CHEMICALS	PAGES	107-108
CHIPPING HAMMER	PAGE	112
CRIMPED CUP BRUSHES	PAGE	99
CRIMPED END BRUSHES	PAGE	101
CUT-OFF WHEELS	PAGE	86
CUTTING TIPS	PAGE	82
F-CLAMPS	PAGE	115
FLAP DISCS	PAGES	94-95
FLINT LIGHTERS	PAGE	110
FLINT RENEWALS	PAGE	110
GOUGING CARBONS	PAGE	74
GOUGING TORCHES	PAGE	74
GRINDING WHEELS	PAGE	89
HIGH SPEED CUT-OFF WHEELS	PAGE	88
HOSE, ARGON GREEN	PAGE	76
HOSE, GRADE R TWIN	PAGE	76
HOSE, GRADE T TWIN	PAGE	76
J-CLAMPS	PAGE	114
KNOT CUP BRUSHES	PAGE	98
KNOT WHEEL BRUSHES	PAGE	97
KNOTTED END BRUSHES	PAGE	100
MIG GUNS AND CONSUMABLES	PAGES	58-66
MIG NOZZLE REAMER	PAGE	110
MIG WELPER, PLIER	PAGE	112
PRESSURE GAUGES	PAGE	117
QUICK CHANGE DISCS	PAGES	90-91
REGULATORS	PAGE	118
RESIN FIBER DISCS, SURFACE CONDITIONING	PAGES	92-93
SOAPSTONE HOLDERS	PAGE	116
SOAPSTONE, FLAT	PAGE	116
SOAPSTONE, ROUND	PAGE	116
STATIONARY SAW WHEELS	PAGE	87
STRINGER BEAD BRUSHES	PAGE	96

CONTINUED....NEXT PAGE



Structural Steel, Erectors and Construction Index

TIG TORCHES AND CONSUMABLES	PAGES	67-72
TIP CLEANERS	PAGE	111
TORCH OUTFITS	PAGES	80-81
TUNGSTEN	PAGE	82
WELD FILLET GAUGE	PAGE	111
WELDING CABLE	PAGE	78
WELDING CABLE AMPERAGE CHART	PAGE	78
WELDING CABLE, CONNECTORS	PAGE	79
WELDING CABLE, ELECTRODE HOLDERS	PAGE	79
WELDING CABLE, GROUND CLAMPS	PAGE	79
WELDING CABLE, LUGS	PAGE	79
WELDING CABLE, ULTRA FLEX ORANGE WHIP CABLE	PAGE	78
WIRE/SCRATCH BRUSHES	PAGE	106

FRACTION-DECIMAL CONVERSION CHART

<u>INCHES</u>		<u>MILLIMETERS</u>		<u>INCHES</u>		<u>MILLIMETERS</u>	
$\frac{1}{64}$.015625	.3969	$\frac{33}{64}$.515625	13.096		
$\frac{1}{32}$.03125	.7938	$\frac{17}{32}$.53125	13.493		
$\frac{3}{64}$.046875	1.1906	$\frac{35}{64}$.546875	13.890		
$\frac{1}{16}$.0625	1.5875	$\frac{9}{16}$.5625	14.287		
$\frac{5}{64}$.078125	1.9844	$\frac{37}{64}$.578125	14.684		
$\frac{3}{32}$.09375	2.3813	$\frac{19}{32}$.59375	15.081		
$\frac{7}{64}$.109375	2.7781	$\frac{39}{64}$.609375	15.478		
$\frac{1}{8}$.125	3.1750	$\frac{5}{8}$.625	15.875		
$\frac{9}{64}$.140625	3.5719	$\frac{41}{64}$.640625	16.271		
$\frac{5}{32}$.15625	3.9688	$\frac{21}{32}$.65625	16.668		
$\frac{11}{64}$.171875	4.3656	$\frac{43}{64}$.671875	17.065		
$\frac{3}{16}$.1875	4.7625	$\frac{11}{16}$.6875	17.462		
$\frac{13}{64}$.203125	5.1594	$\frac{45}{64}$.703125	17.859		
$\frac{7}{32}$.21875	5.5563	$\frac{23}{32}$.71875	18.256		
$\frac{15}{64}$.234375	5.9531	$\frac{47}{64}$.734375	18.653		
$\frac{1}{4}$.250	6.3500	$\frac{3}{4}$.750	19.050		
$\frac{17}{64}$.265625	6.7469	$\frac{49}{64}$.765625	19.447		
$\frac{9}{32}$.28125	7.1438	$\frac{25}{32}$.78125	19.843		
$\frac{19}{64}$.296875	7.5406	$\frac{51}{64}$.796875	20.240		
$\frac{5}{16}$.3125	7.9375	$\frac{13}{16}$.8125	20.6375		
$\frac{21}{64}$.328125	8.3344	$\frac{53}{64}$.828125	21.0345		
$\frac{11}{32}$.34375	8.7313	$\frac{27}{32}$.84375	21.431		
$\frac{23}{64}$.359375	9.1282	$\frac{55}{64}$.859375	21.8282		
$\frac{3}{8}$.375	9.5250	$\frac{7}{8}$.875	22.2251		
$\frac{25}{64}$.390625	9.9219	$\frac{57}{64}$.890625	22.6220		
$\frac{13}{32}$.40625	10.3188	$\frac{29}{32}$.90625	23.0188		
$\frac{27}{64}$.421875	10.7157	$\frac{59}{64}$.921875	23.4157		
$\frac{7}{16}$.4375	11.1125	$\frac{15}{16}$.9375	23.8126		
$\frac{29}{64}$.453125	11.5094	$\frac{61}{64}$.953125	24.2095		
$\frac{15}{32}$.46875	11.9063	$\frac{31}{32}$.96875	24.6063		
$\frac{31}{64}$.484375	12.3032	$\frac{63}{64}$.984375	25.0032		
$\frac{1}{2}$.500	12.7001	1	1.000	25.4001		

